

13844

DIY handmade goods— Legend Of The Blue Sea



13844 Instruction Manual

Notes before assembling

Bring your own tools



Scissors:
Can be used to cut printed paper, cloth, etc.



Screw Driver:
For fixing screws, mostly can be used to install doors and music components.



Tweezers:
For holding small materials and rolling up iron wire.



Cutter knife:
For peeling off power wire skin and cutting off materials.



Ruler:
For measuring materials to identify the number of materials so as to enhance work efficiency.

Warnings

- The product is not suitable for children under 14 years old. The should be under custody of adults when playing with the product.
- There are small parts, please do not swallow them for avoiding dangerous accidents.
- Please also play attention to the sharp-pointed materials to avoid injuries.

Making tips

1. LED wiring indication: White=Positive; Grey=Negative.
2. Use a craft blade to carefully skim over the plastic to bare the copper wire.
3. For LED wiring extension, please refer to the below steps:

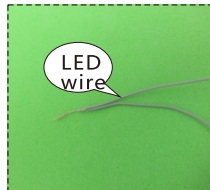

Twist the copper of both LED wire and extension wire together.

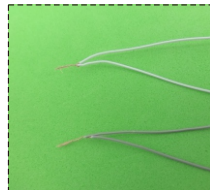

Do the same on the white wire.
Remarks: Tie a knot at the end of the grey wire to differentiate the polarity.

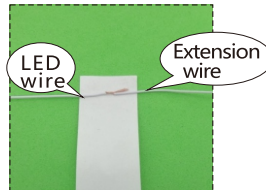

Place the duly twist wire on the tapes provided.

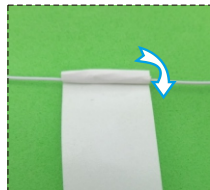

Roll and wrap the wire.

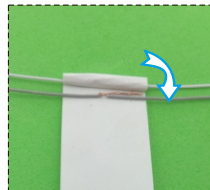

Place another wire next to it.
Remarks: DO NOT contact both copper wire to avoid short circuit.

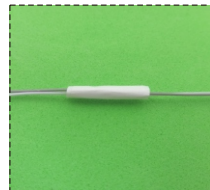

Roll and wrap it together.

Tips for assembling

1. Pictures shown on the package may be slightly different from the actual product.
2. Please use the provided tracing paper for cutting purpose to achieve the best outcome.
3. Product designs and specification may be subject to change without advance notice for purpose of making improvement.
4. Testing on LED function:

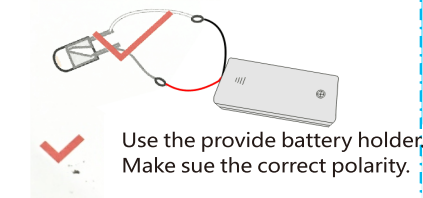
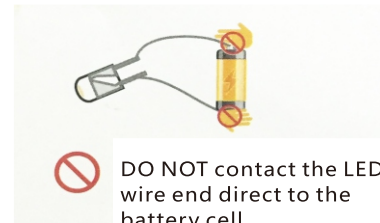

How to assemble the battery holder



1. Material and tools needed:
- Battery holder, LED bulb, tape, screw driver and 2 piece AA size battery(not provided)



2. Use screw driver and take the lid off from the battery holder.



3. Insert the battery take notes on the polarity.

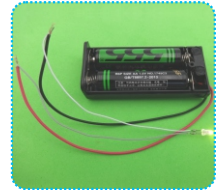

4. Connect the red wire to grey wire. Connect the black wire to white wire.



5. Wrap the exposed wire with the tapes.



6. Place the box lid and fastness with screw driver.

Product information

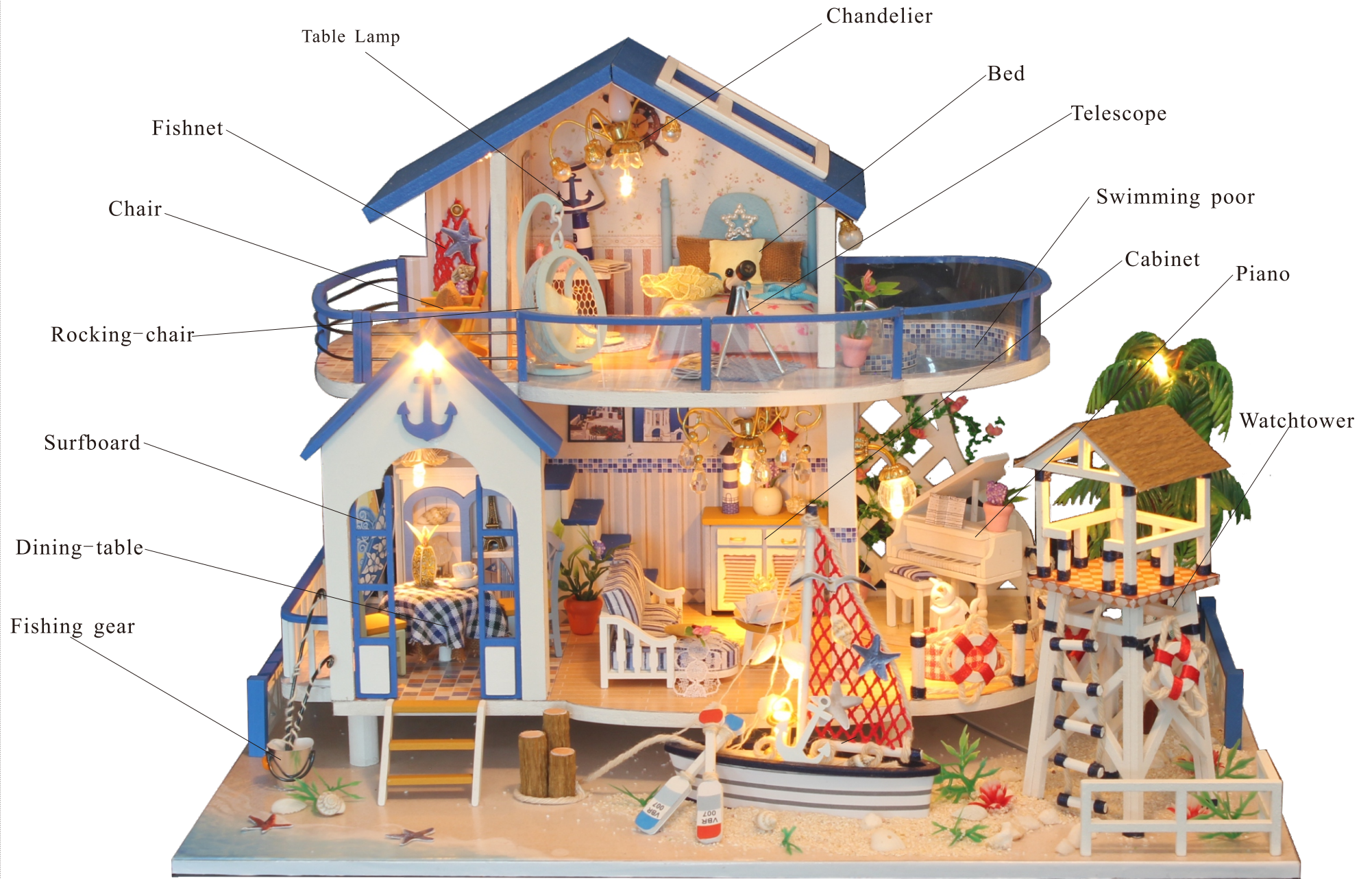

Sofa

(Front view) (Back view)

Cut out C33 according to the template of A10-1-2. Cut out C33 according to the template of A10-1-1. Cut out C34 according to the template of A10-1-3. B73

Paste C33 on B73 as shown. Cover up B73 with C34 as shown.

Part 1 Part 2 Cut out C34 according to the template of A10-1-4. Part 2 Part 1 Attach part 2 to part 1 as shown. Cut off the excess of part 2.

Cut off the excess of C34 as shown. Cut out C34 according to the template of A10-1-4 and fold it as shown. (3pieces)

Cut out C33 according to the template of A10-1-5. Cut out C33 according to the template of A10-1-6. Cut out C34 according to the template of A10-1-7. Part 3 Part 3 (5pieces)

Paste C33 on B74 as shown. Cover up B74 with C34 as shown. Cut off the excess of C34 as shown.

Part 3 Part 2 Part 3 Cut out C34 according to the template of A10-1-8. Part 3 (3pieces)

Attach part 2 to part 3 as shown. Cut off the excess of part 2. Attach C34 on the back of part 3 as shown.

B70 B71 B70 B71 B72

Attach B70, B72 and B73 together as shown. Paste cushion on it as shown.

D04 A10-2 D10 A10-3 C35:6cm

Cut out of D04, wrap up D04 and D10 with A10-2 as shown.

Table

Cut out C52 according to the template of A10-4-2. A10-4-1 B75 B76 B77

Attach B75 on A10-4-1, cut out C52 according to the temple of A10-4-2. Attach B76 to B77 as shown.

C02 C10 C54:1.2cm A10-4-3

Paste the combination to combination as shown. According to above stips to make the cup.

A10-4-4 A10-4-5

Fold A10-4-4 in a "Z" form according to line. (the making method are same for all books)

A10-5-1 B68 B66 B69 C54:1cm

Attach B69 on A10-5-1, paste B68, B69 and B69 on B66 as shown. Cut out 4pieces of C54(1cm) and bend it as shown. Paste it on the combination as shown.

B67 B67 B65

Attach B66 to B67, paste B65 on the combination to finish the cabinet as shown.

A10-5-2 D04 C20 D05 D11

Cut out of A10-5-2, fold and attach it as shown. Cut out D04 and insert it on C20, paste D04 on C20 as shown.

Dinning-table

Cut out C31 according to the template of A10-6-1. Cut out C32 according to the template of A10-6-2.

Attach C31 on C32 as shown.

Attach B30 on B57, and paste it on C31 as shown.

Fold the combination well as shown.

Cut out D04 and insert it into C18, attach D10 on D04 as shown.

Attach B61, B62, B63 and B64 together to make the chair as shown. The making method is same for another chair.

Attach B49, B50, B51 on A10-7-1 as shown.

Attach A10-7-2 and A10-7-3 on B53, paste B54, B55 to B53 as shown. Attach C17 on C16 as shown.

Fold A10-7-4 and A10-7-5 well as shown. Paste A10-7-6 on B56. Follow the steps as shown in diagram to make the boat.

Attach A10-7-7, B47, B48, B52 and A10-7-8 as shown.

Bed

Attach B112, B113 and B114 together as shown. Attach B111 to B110, paste C23 on B110 as shown.

Cut out C33 according to the template of A10-8-1. fold it(1cm). Attach C33 and C38 to the bed form as shown.

Follow the steps as shown in diagram to make the cap.

Follow the steps as shown in diagram to make the skirt and desk lamp.

Cut out C42 according to the template of A10-10-1, apply the glue according to the red lines as shown. Fold the cloth in half insert some cotton to C53 as shown. Apply the glue on the top and fix it as shown. the pillow is done.

Repeat above same steps to form other pillows.

Bedside table

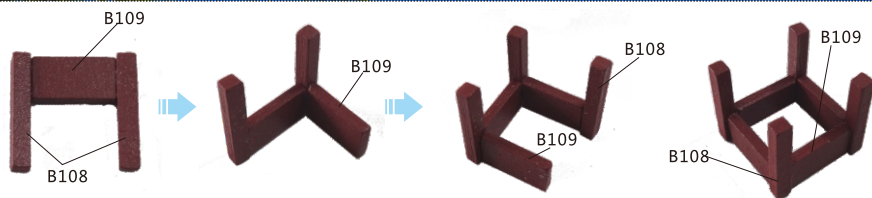

Attach B108 and B109 together as shown.

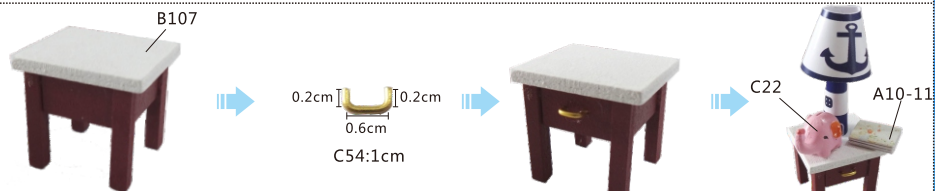

Paste B107 to combination, cut out a piece of C53(1cm), and bend it according to the diagram, attach it on combination to complete the bedside table as shown.



Follow to above steps to make the chair as shown.

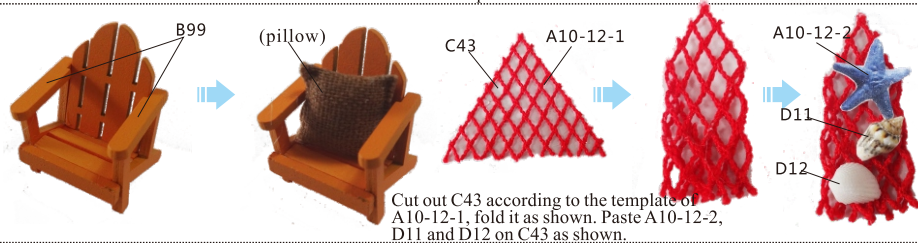

Cut out C43 according to the template of A10-12-1, fold it as shown. Paste A10-12-2, D11 and D12 on C43 as shown.



Attach C24,C25,C26,C27 and C28 together as shown.



Cut out a piece of C57(6cm) and bend it as shown.

Cut out another piece of C57(3cm) and bend it as shown.



Attach combination to combination as shown.

Rocking-chair

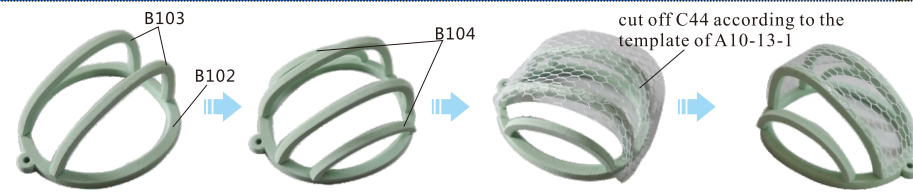

Attach B102,B103 and B104 together, cut off C44 according to the template of A10-13-1 and attach it to the combination as shown. Cut off the excess C44 as shown.

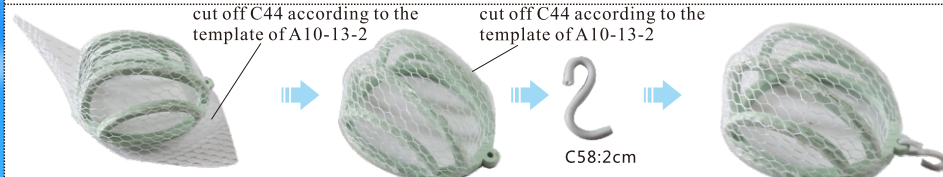

Cut off C44 according to the template A10-13-2 and attach it to the combination as shown. Cut off the excess C44 as shown.

Cut off a piece of C58, bend it as shown. Insert C58 to the hole of B102 as shown.

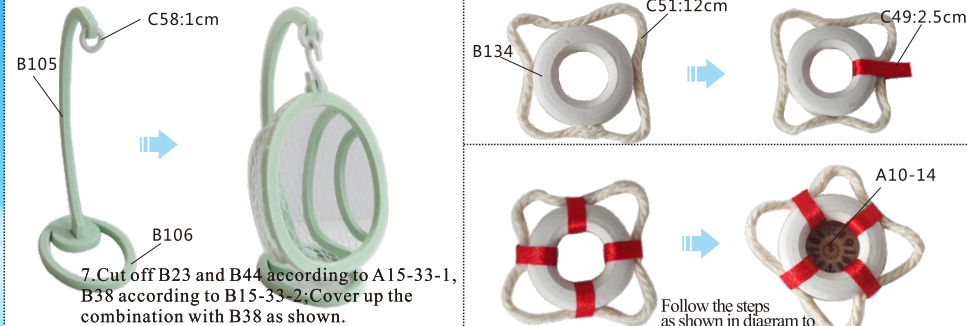

7. Cut off B23 and B44 according to A15-33-1, B38 according to B15-33-2; Cover up the combination with B38 as shown.

Follow the steps as shown in diagram to make the clock of shape of life ring.

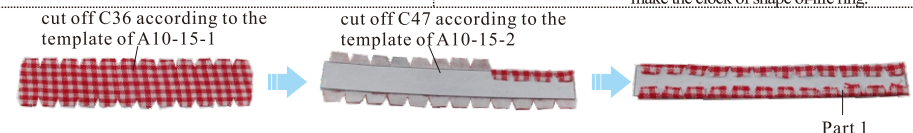

cut off C36 according to the template of A10-15-1

cut off C47 according to the template of A10-15-2

Part 1

Follow the steps as shown in diagram to make the part 1.

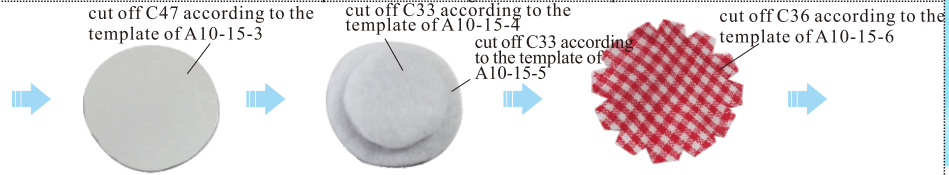

cut off C47 according to the template of A10-15-3

cut off C33 according to the template of A10-15-4

cut off C33 according to the template of A10-15-5

cut off C36 according to the template of A10-15-6

Follow the steps as shown in diagram to make the part 2.

Attach part 1 to part 2 as shown. Paste C21 to it as shown.

Piano

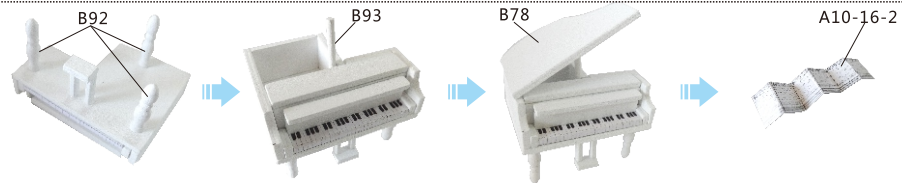
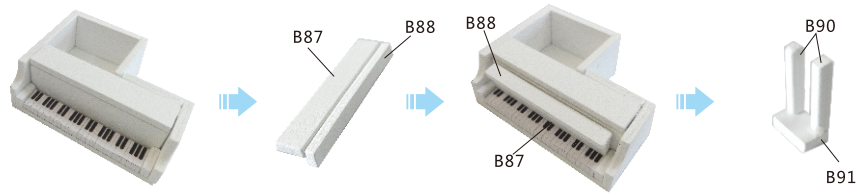
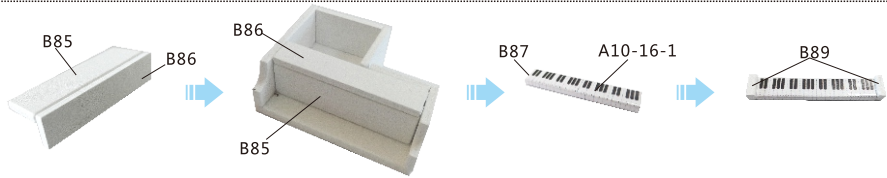
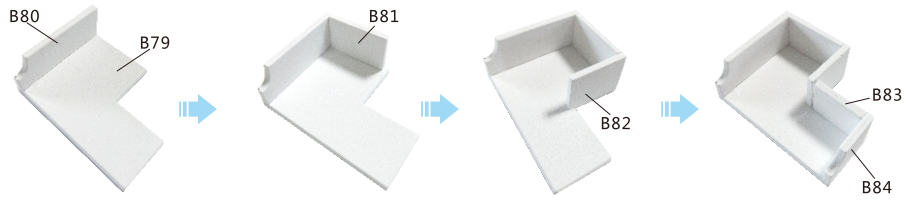

3. According to above steps to make the piano as shown.

4. Fold A15-55-3 to make the music book. Attach E17, E18 and E19 together to make the piano stool as shown.

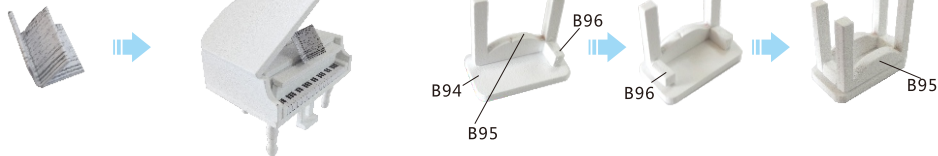

According to above steps to make the piano as shown.

Attach B94, B95, B96 together to make the piano stool as shown.

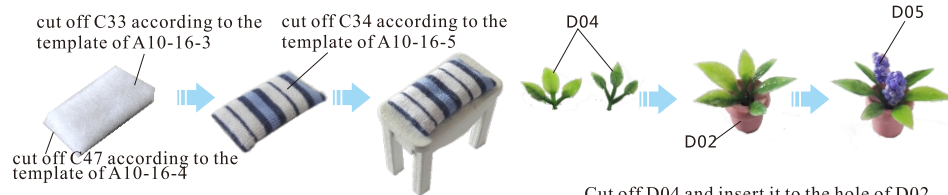

Follow the steps as shown in diagram to make the cushion.

Cut off D04 and insert it to the hole of D02, cut off D05 and attach it as shown.

Model boat

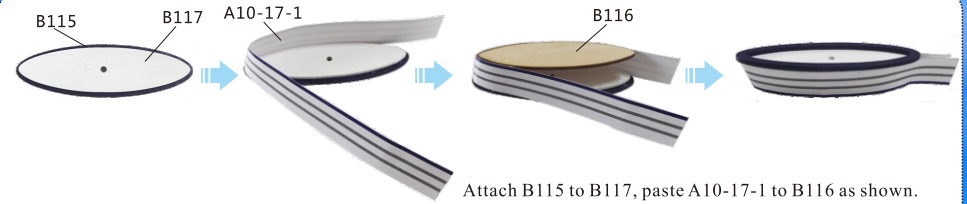

Attach B115 to B117, paste A10-17-1 to B116 as shown.

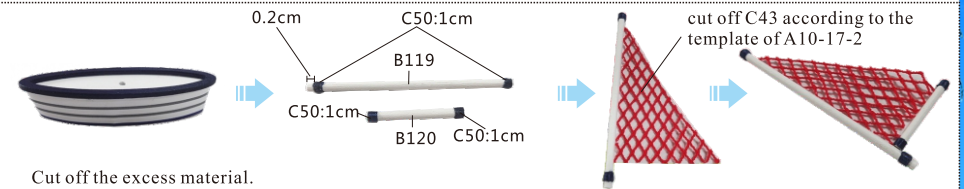

Cut off the excess material.



Cut out a piece of C51 (10cm) and open it as shown.

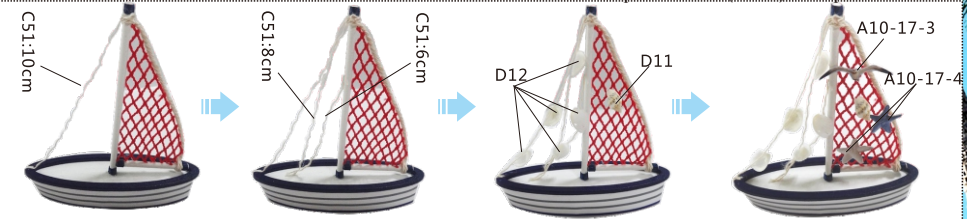

Follow the steps as shown in diagram to make the model boat.

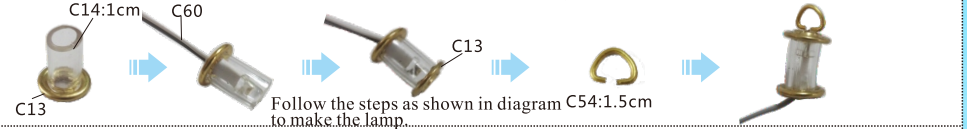

Follow the steps as shown in diagram C54:1.5cm to make the lamp.

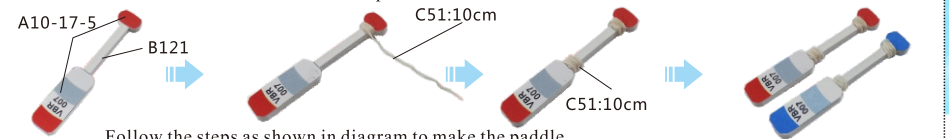

Follow the steps as shown in diagram to make the paddle.

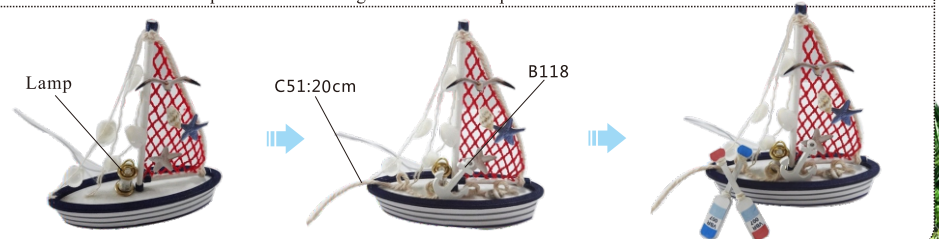

Watchtower



Attach C51 on B31 as shown. Cut off 4pieces of C50(2cm) and fix it on B31 and C51 to make the life ring as shown (PS: According the same step to make other red life ring. Blue ring is 3pieces,red ring is 4pieces)

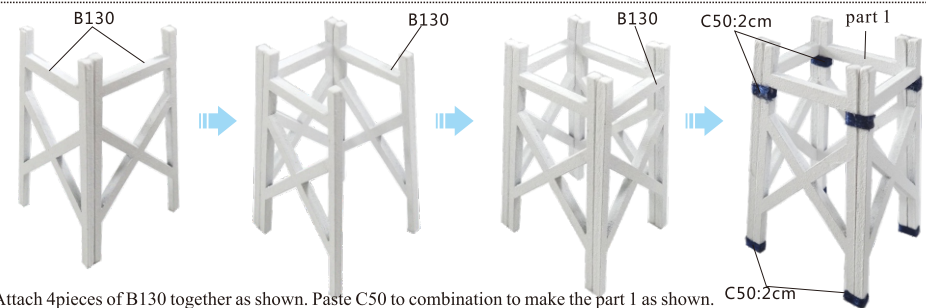

Attach 4pieces of B130 together as shown. Paste C50 to combination to make the part 1 as shown.

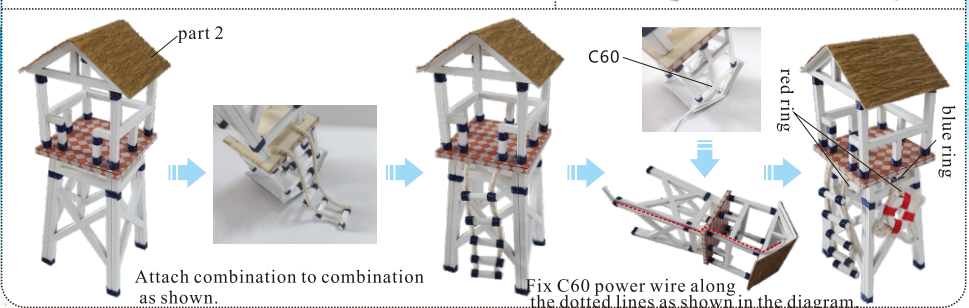
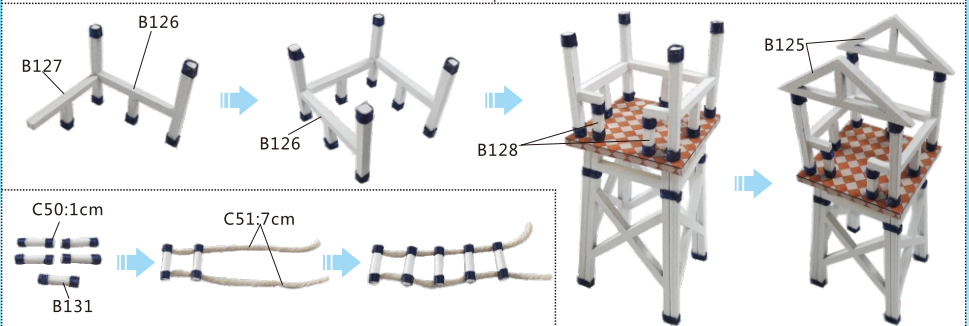
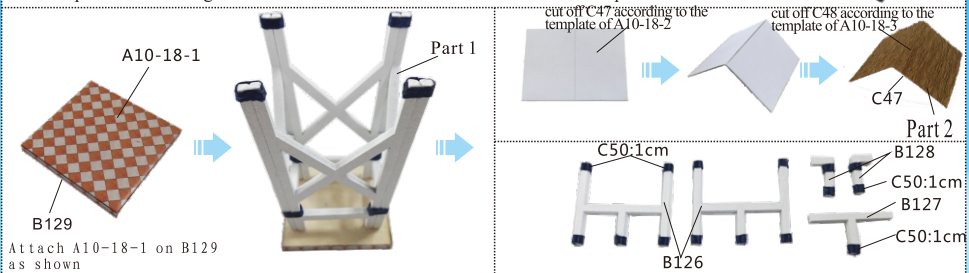

Attach combination to combination as shown.

Fix C60 power wire along the dotted lines as shown in the diagram.

Fishing rod



Follow the steps as shown in diagram to make the fishing rod.

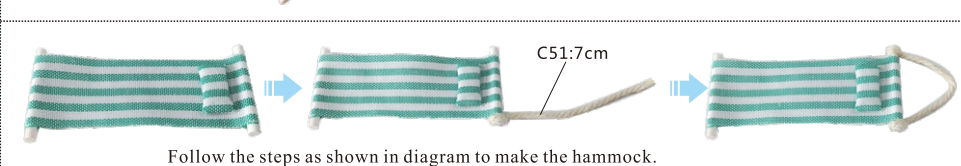

Follow the steps as shown in diagram to make the hammock.

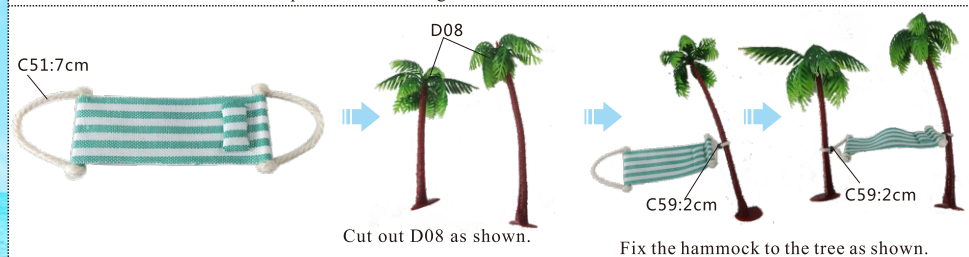

Cut out D08 as shown.

Fix the hammock to the tree as shown.

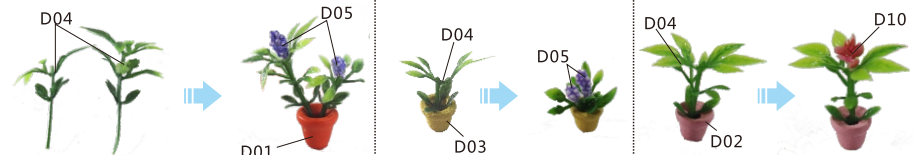

Lamp

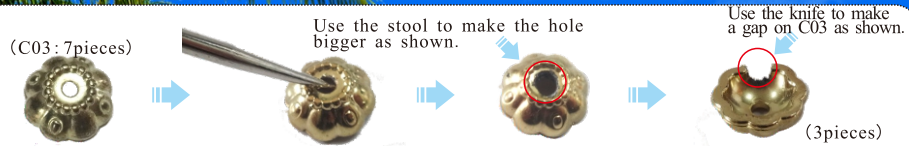

Follow the steps as shown in diagram to make it.

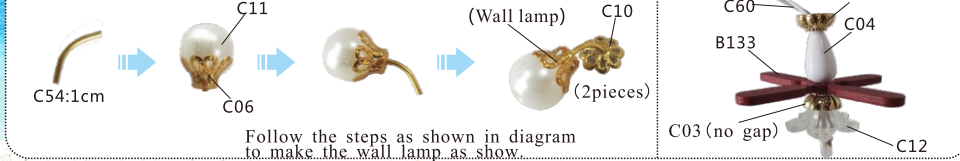
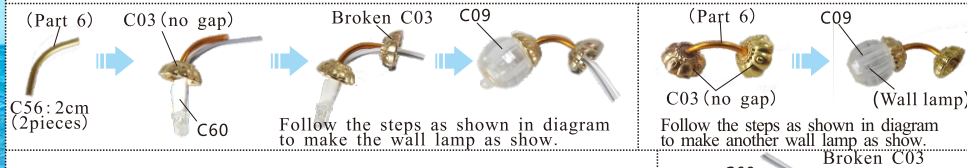
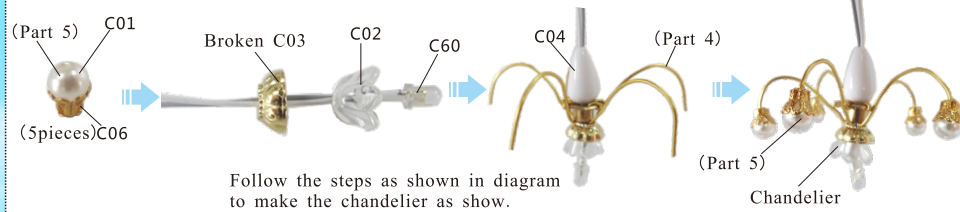
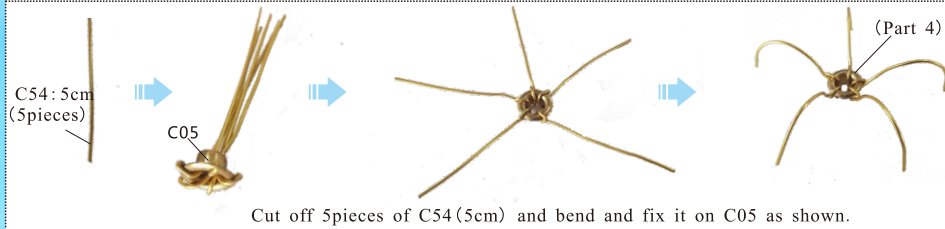

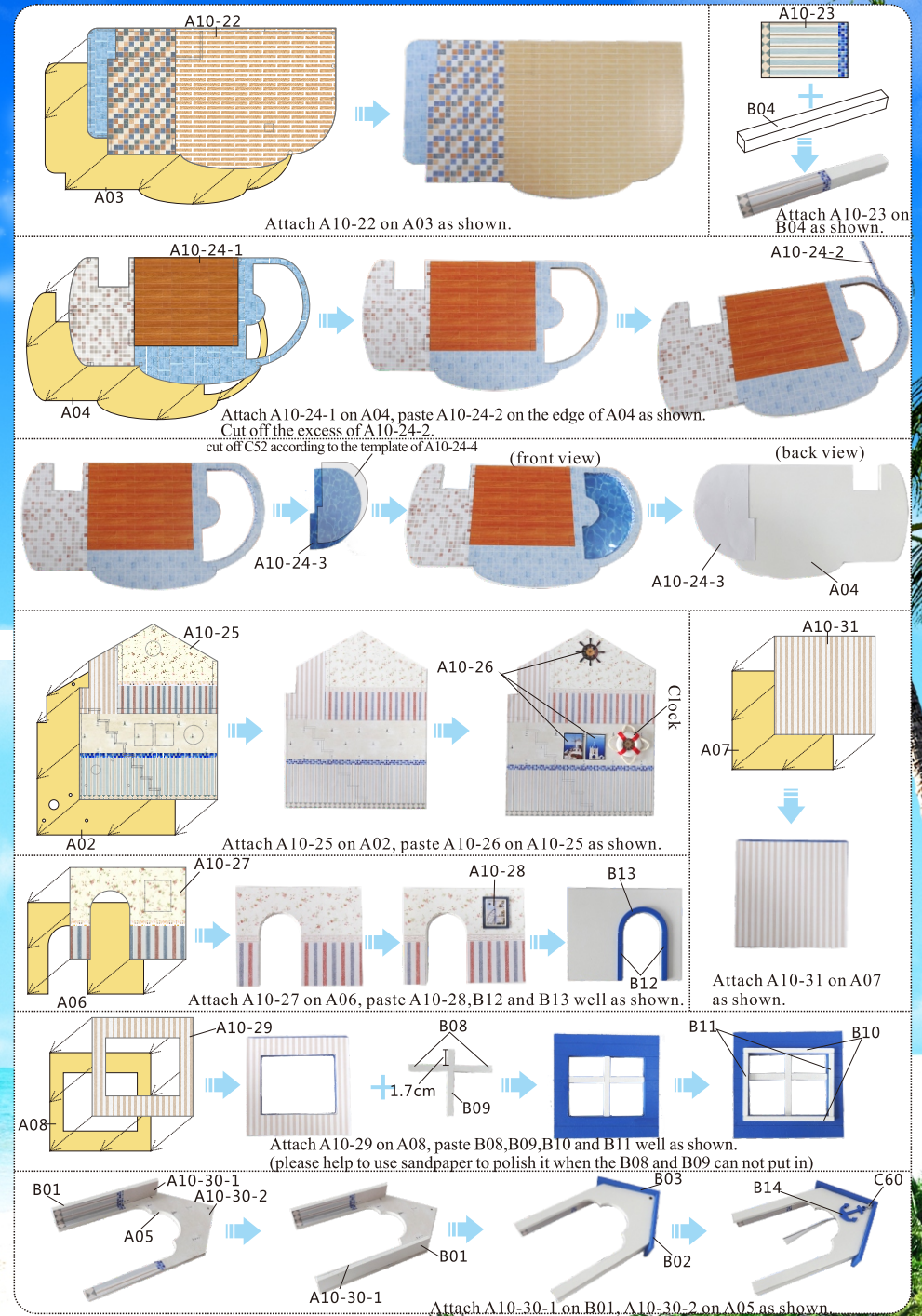

Outer frame

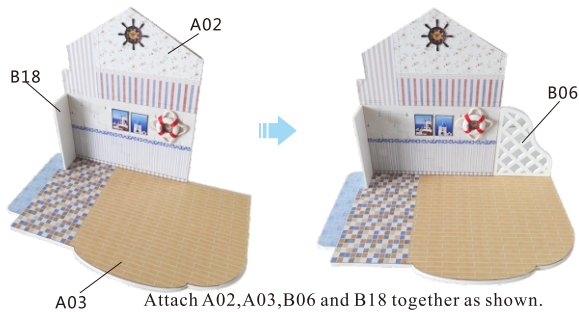

Outer frame



Music machine core manual guide
(If you have purchased the music machine core, please fix it firstly)

 <p>E01 Music machine core 1 piece</p>	 <p>E02 Music machine core handle 1 piece</p>	 <p>E03 Screw 3 pieces</p>
---	---	---

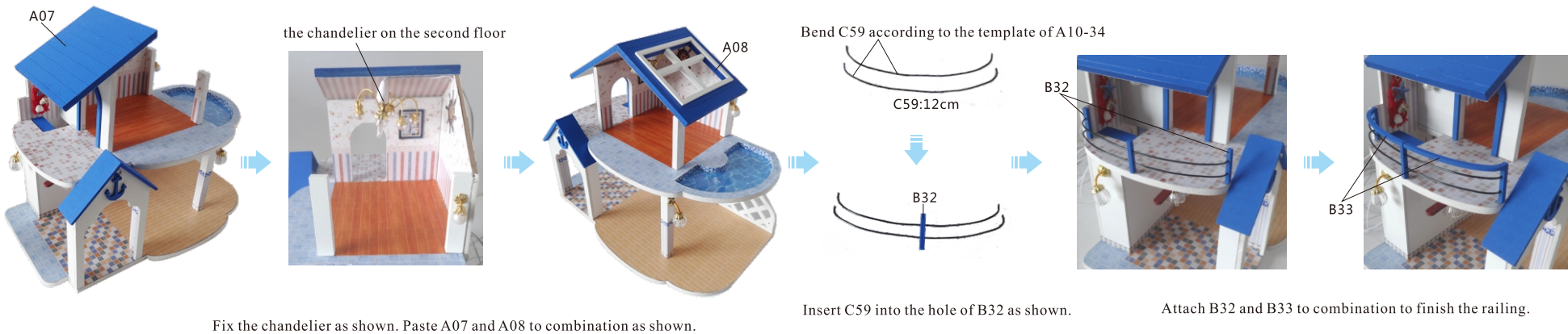
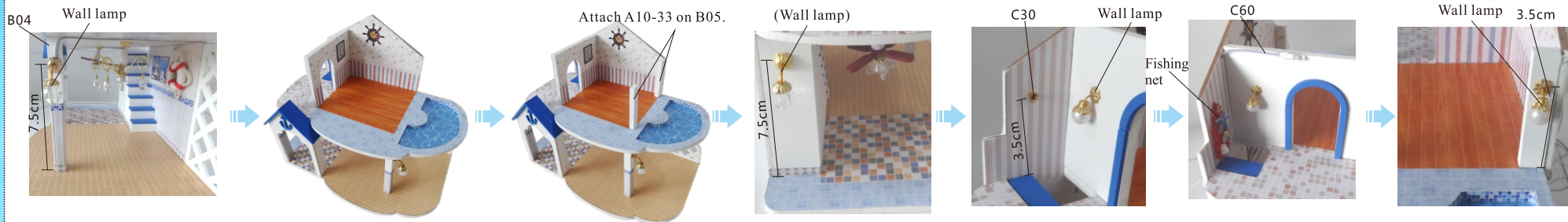
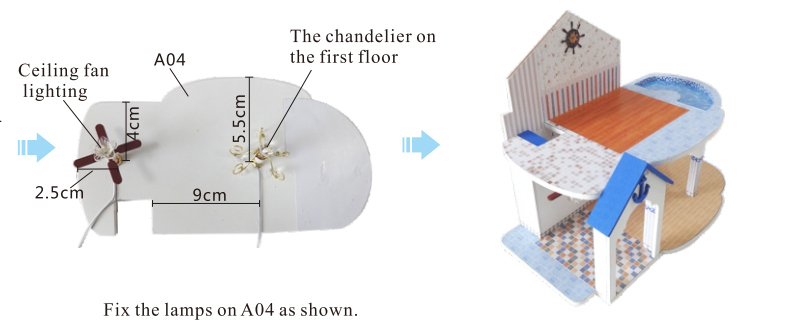
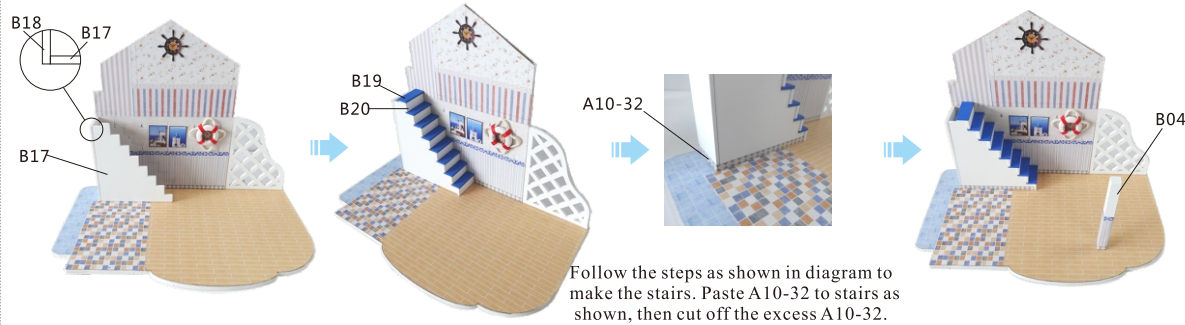
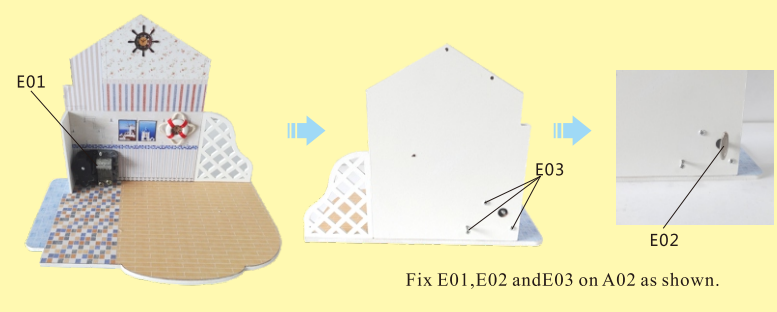

Outer frame

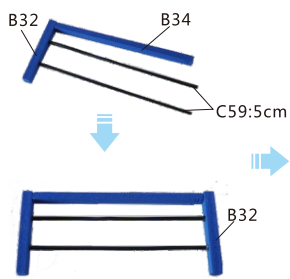

Cut out two pieces of C59(5cm), attach them to B32 and B34 as shown.

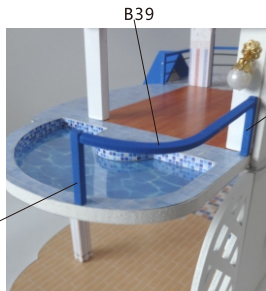

Paste B35,B37,B38 and B39 to the combination. Cut off C52 according to the template of A10-35-1 and fix it as shown.

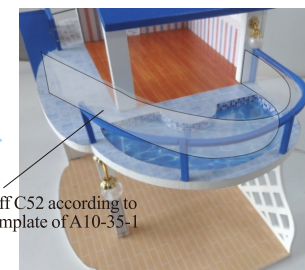
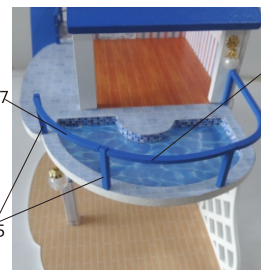

According to above making method to do another railing.



Cut off C52 according to template of A10-35-2



Cut out two pieces of C57(4cm) and bend it according to template of A10-36.

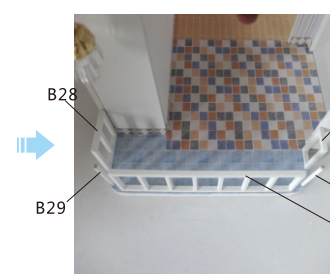

Follow the steps as shown in diagram to make the railing on first floor and door.

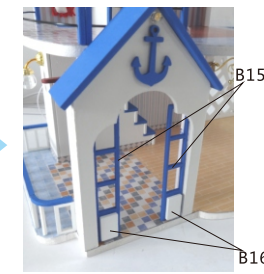
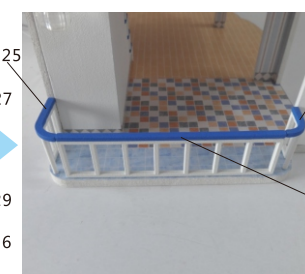

Attach A10-36-2 and A10-36-2 to A09 as shown.

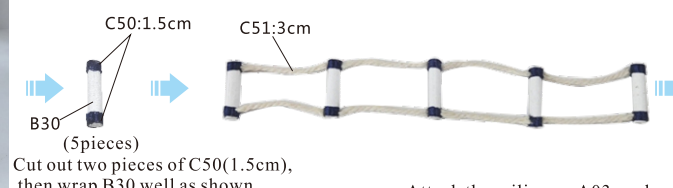
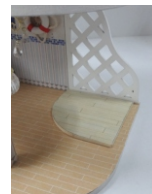

Cut out two pieces of C50(1.5cm), then wrap B30 well as shown.

Attach the railing on A03 as shown.



Attach life rings on railing as shown.

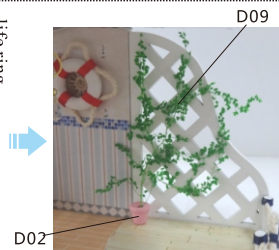

Attach D09 on B06, D10 on D09 as shown.

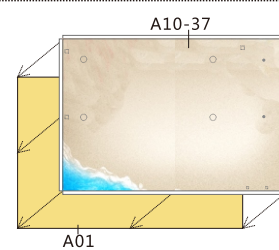

Attach A10-37 on A01, paste 4 pieces of B07 on A10-37 as shown.

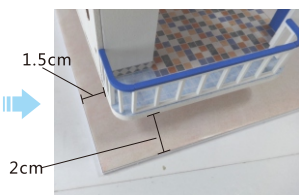

Attach B21 to B22 as shown.

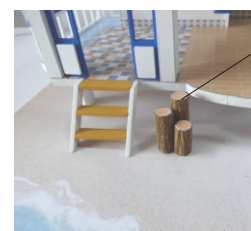
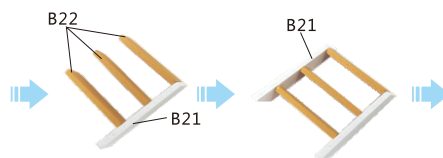

Attach the wooden stake and hammock well as shown. Paste one piece of C60 on the tree as shown.

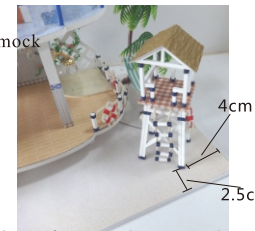

Outer frame

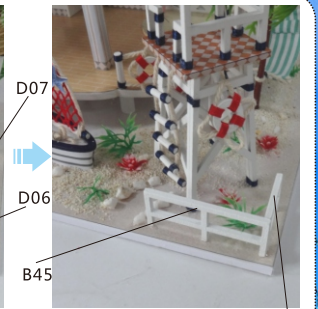
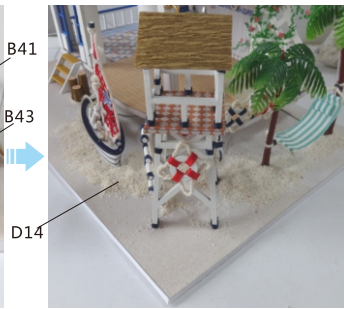

Attach the model boat on the board as shown.

B40 Attach B40, B41 and B43 well as shown.

Attach D14, D13 according to the diagram, paste D06 and D07 on D14 as shown.

B46

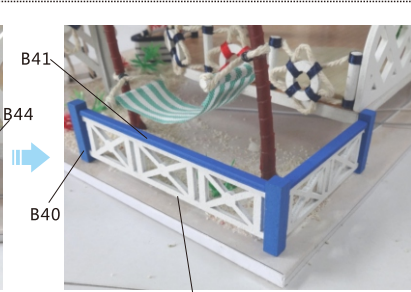
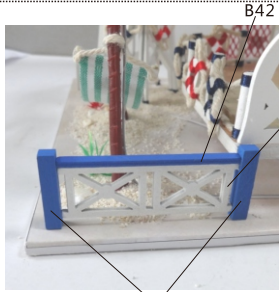

B40

B43

How to connect to battery box

Statement: the lamp wires cannot be inserted into the output socket.

- Can use 5 batteries
- Please notice the place of anode and cathode when pit in the batteries
- Rechargeable batteries are not blunt electricity
- Rechargeable batteries can only be charged under adult supervision

- Rechargeable batteries should be removed from the toy before charging
- Different types of batteries cannot mix;
- Do not mix new batteries in use with semi-used batteries.
- Run out of battery should be removed from the toy
- The power shall not be short circuit

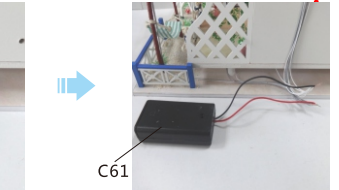

1. Trim all the LED wiring to the same length.
2. Use a craft blade to carefully skim over the plastic to bare the copper wire. Twist the same colour wire together.

3. Twist the following wire together:
 - (I) BLACK wire from the battery box with the WHITE wire from LED bulb.
 - (II) RED wire from the battery box with the GREY wire from LED bulb.
4. Roll and seal the duly twist copper with the white tape provided. Place the battery box in the allocated space.

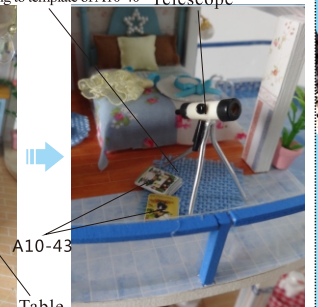
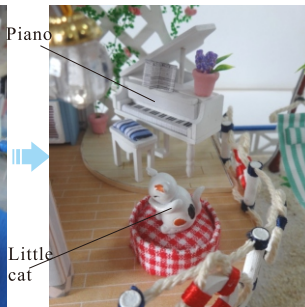
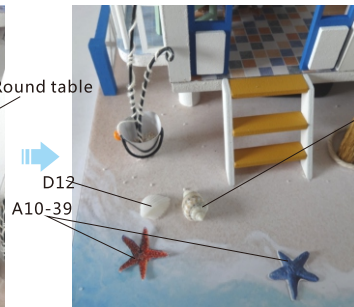

Attach A10-38 on C47 and then cut off it as shown.

Attach A10-39 on C47 and then cut off, Paste D11 and D12 well as shown.

Cut out C42 according to template of A10-41-1

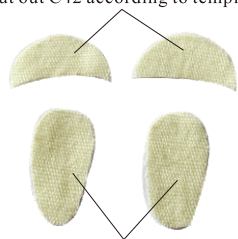

Cut out C42 according to template of A10-41-2

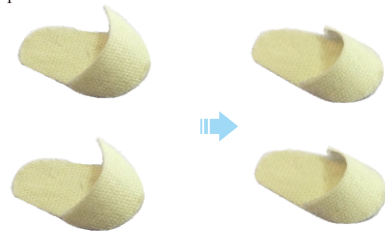

Cut out C37 according to template of A10-42

Follow the steps as shown in diagram to make the slippers as shown.



**Installation of dust proof cover
(For updated version, the parts need to be purchased separately)**



E04 Transparent cover
0.18*21.5*32 (1piece)



E05 Transparent cover
0.18*22*32 (2pieces)



E06 Transparent cover
0.18*21.14 *22 (2pieces)



1. Tear off kraft paper of each piece of transparent cover.

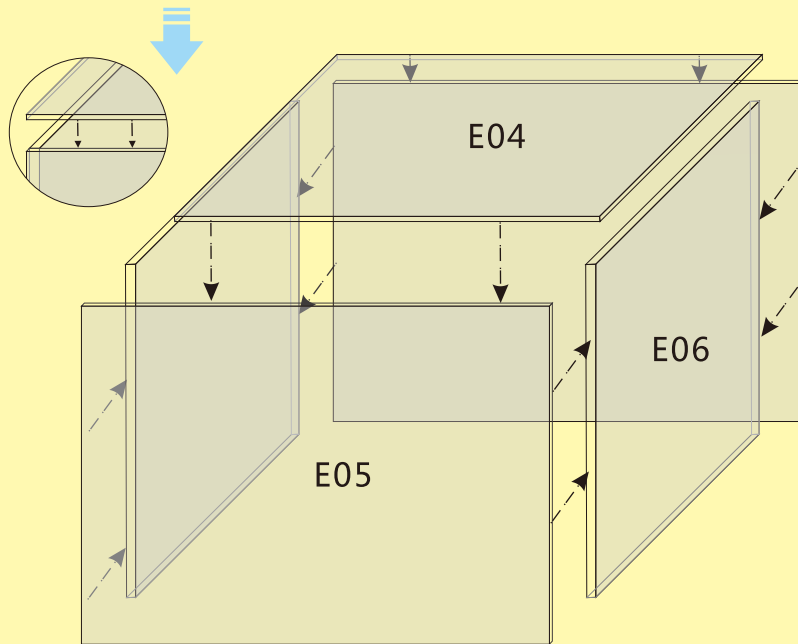

2. Paste E04, E05, and E06 together to complete the dust proof cover as shown.

Photo of Dust proof cover



Photo Gallery



Photo Gallery





Attention: Please keep the instruction for future enquires after installation.