

13846

DIY handmade goods— Sweet Words



13846 Instruction Manual

NOTICE OF ASSEMBLE

Bring your own tools



Scissors:
Can be used to cut printed paper, cloth, etc.



Screw Driver:
For fixing screws, mostly can be used to install doors and music components.



Tweezers:
For holding small materials and rolling up iron wire.



Cutter knife:
For peeling off power wire skin and cutting off materials.



Ruler:
For measuring materials to identify the number of materials so as to enhance work efficiency.

Making tips

1. LED wiring indication: White=Positive; Grey=Negative.
2. Use a craft blade to carefully skim over the plastic to bare the copper wire.
3. For LED wiring extension, please refer to the below steps:

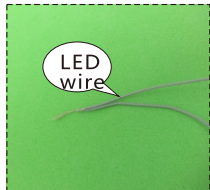
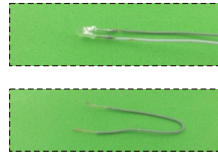

Twist the copper of both LED wire and extension wire together.



Do the same on the white wire.
Remarks: Tie a knot at the end of the grey wire to differentiate the polarity.

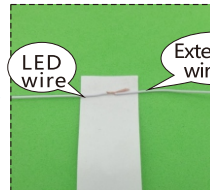

Place the duly twist wire on the tapes provided.

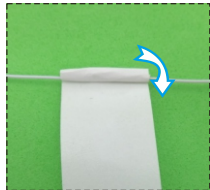

Roll and wrap the wire.

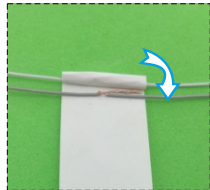

Place another wire next to it.
Remarks: DO NOT contact both copper wire to avoid short circuit.

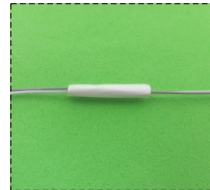

Roll and wrap it together.

Tips for assembling

1. Pictures shown on the package may be slightly different from the actual product.
2. Please use the provided tracing paper for cutting purpose to achieve the best outcome.
3. Product designs and specification may be subject to change without advance notice for purpose of making improvement.
4. Testing on LED function:



DO NOT contact the LED wire end direct to the battery cell.

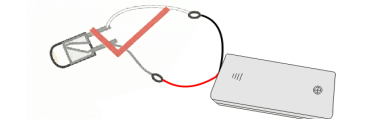

Use the provide battery holder. Make sue the correct polarity.

Warnings

- The product is not suitable for children under 14 years old. The should be under custody of adults when playing with the product.
- There are small parts, please do not swallow them for avoiding dangerous accidents.

How to assemble the remote control lamp



1. Material needed:
- Remote controller, receiver, LED bulb, tape and 3 pieces button battery.(provided)

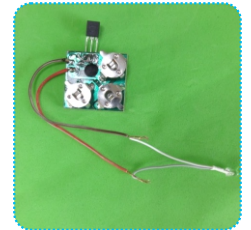

2. Connect the red wire to grey wire. Connect the black wire to white wire.

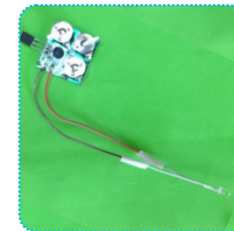

3. Wrap the exposed wire with the tapes.

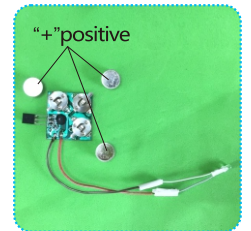

4. Insert the battery take notes on the polarity.

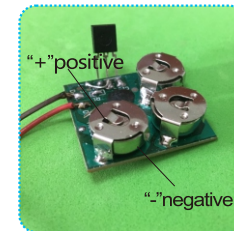

5. Bend the sheet iron on receiver as shown.

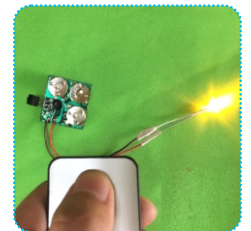

6. The remote controller aimed at receiver, press the ON button key to light.

Product information

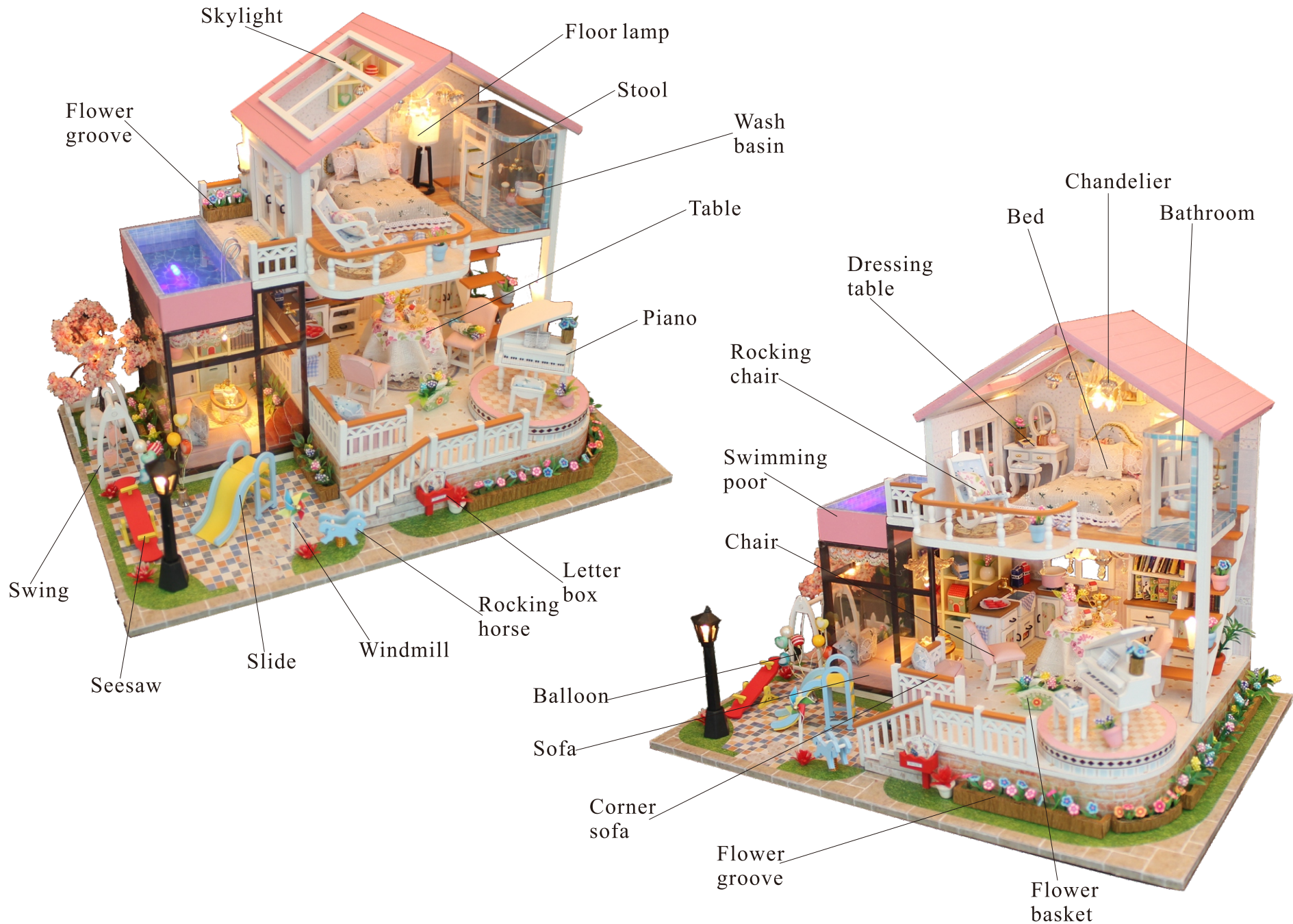

Kitchen Cabinet

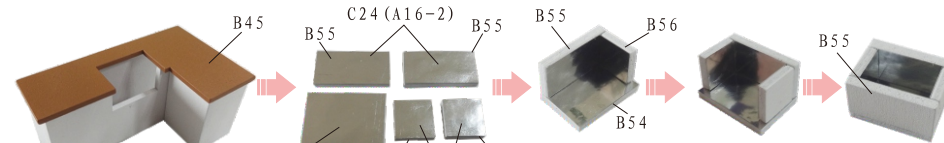
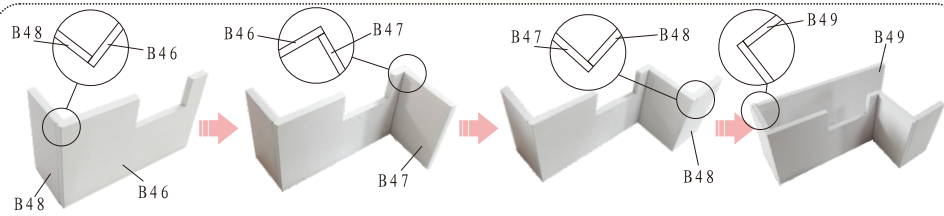

Paste C24 on B54, B55 and B56 as shown.
(Note: The mean C24(A16-1) is cutting out C24 according to the template of A16-1; other material are same mean.)

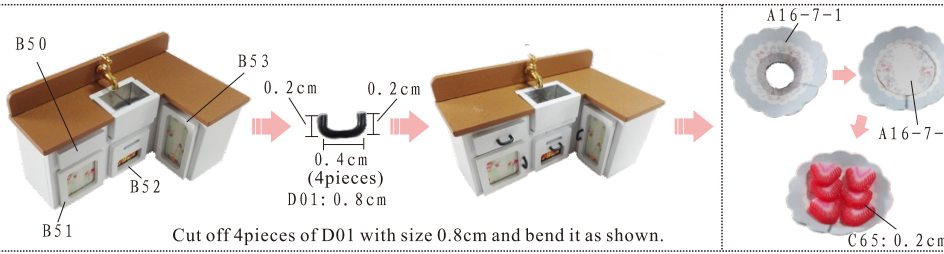
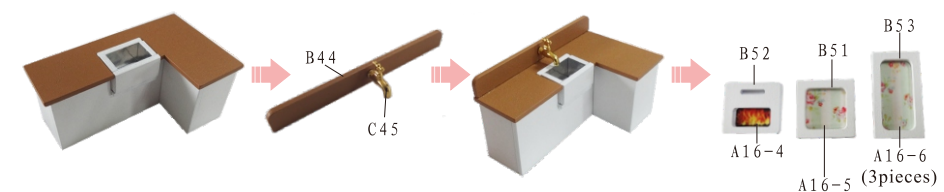

Roaster

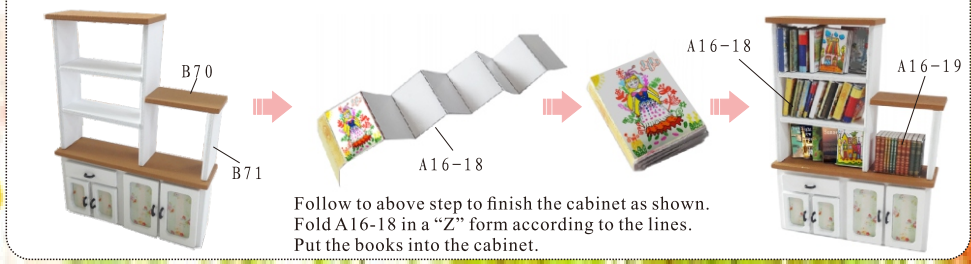
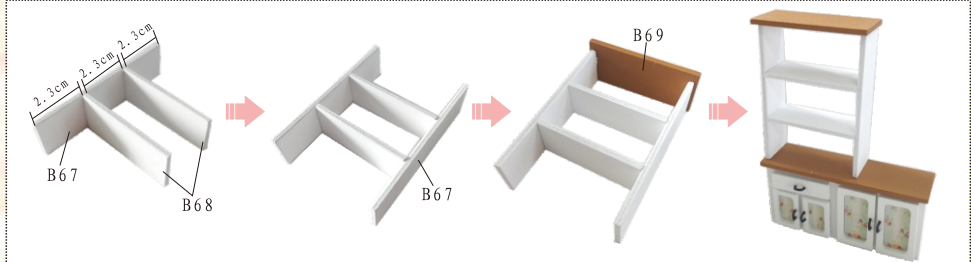
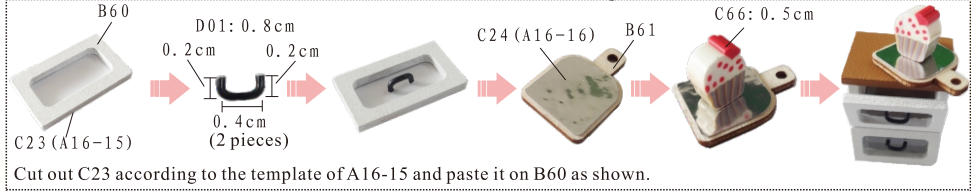
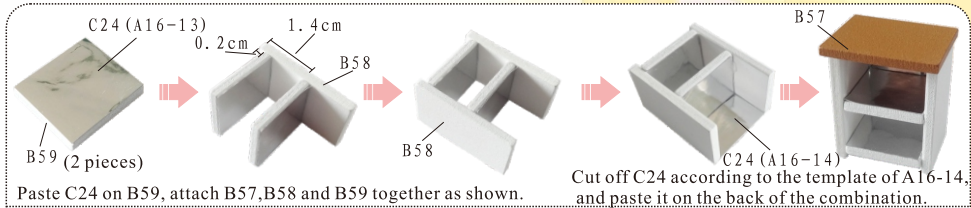

Follow to above step to finish the cabinet as shown.
 Fold A16-18 in a "Z" form according to the lines.
 Put the books into the cabinet.

Cabinet

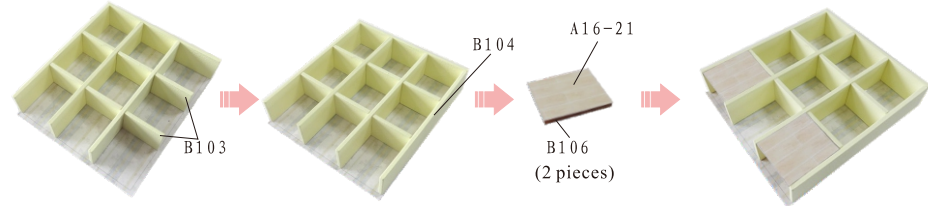
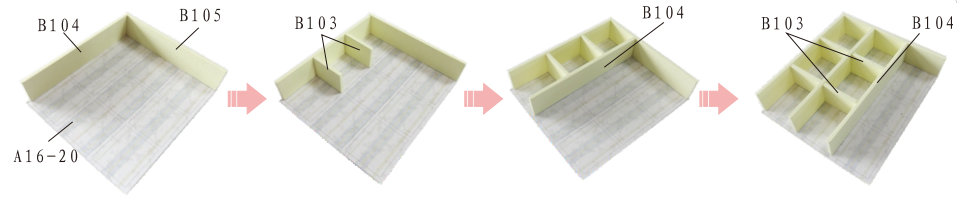

Bend D01 as shown and paste it on the cabinet.

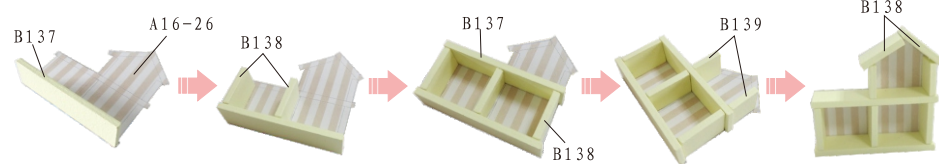
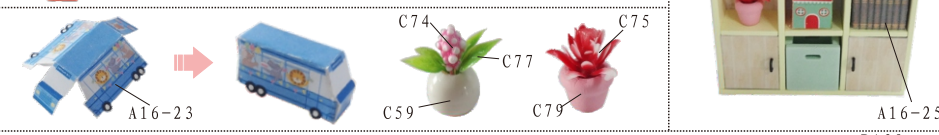

Attach B137, B138 and B139 on A16-26 as shown.



Round table

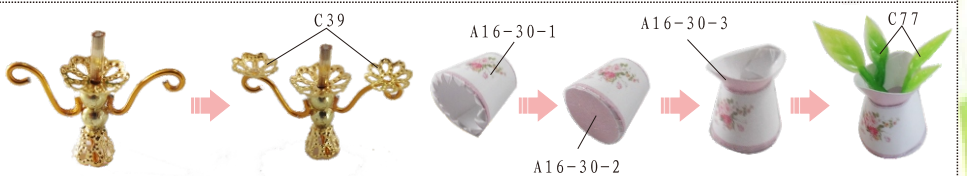
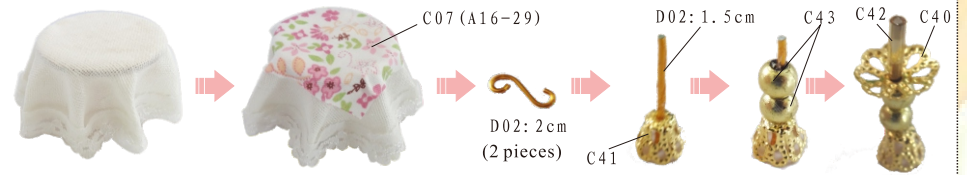
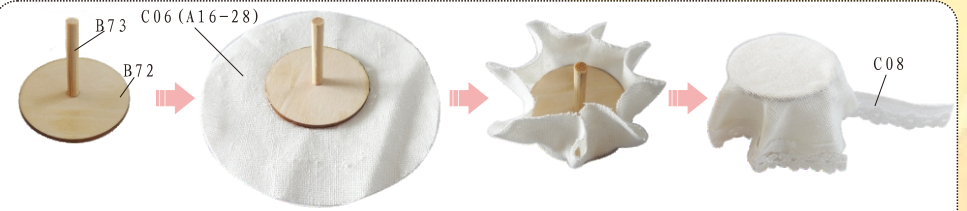

Paste C09 on B74, C10 on the back of B74 as shown.

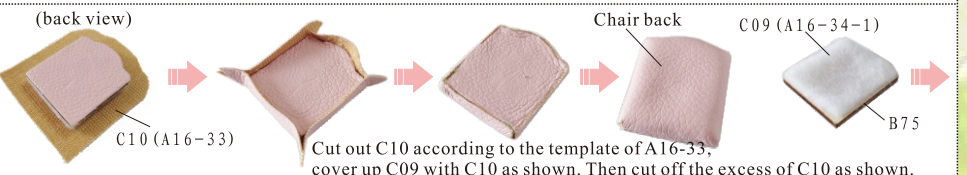

Cut out C10 according to the template of A16-33, cover up C09 with C10 as shown. Then cut off the excess of C10 as shown.



Finish the cushion well according above steps.

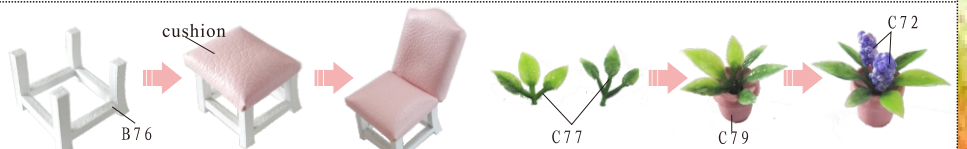

Sofa

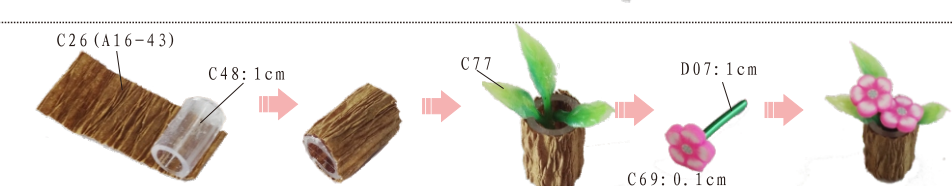
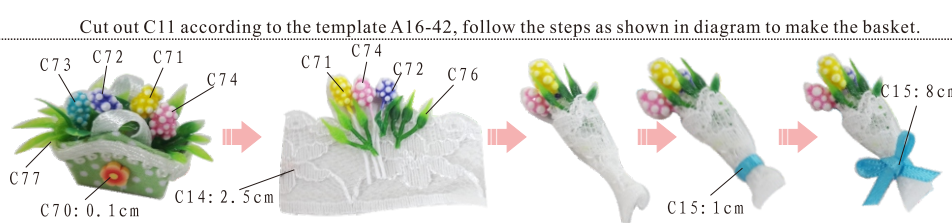
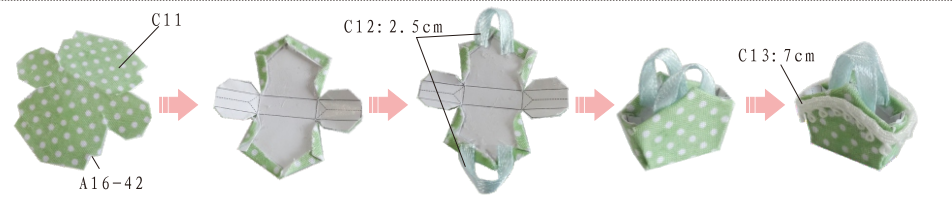
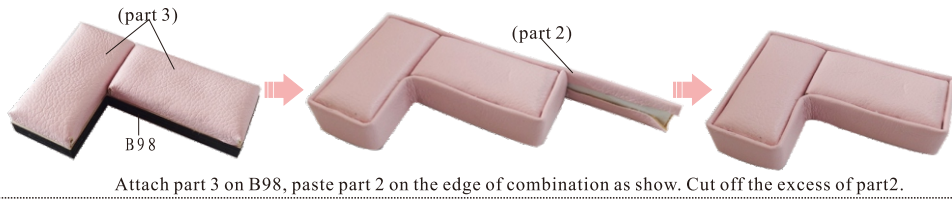
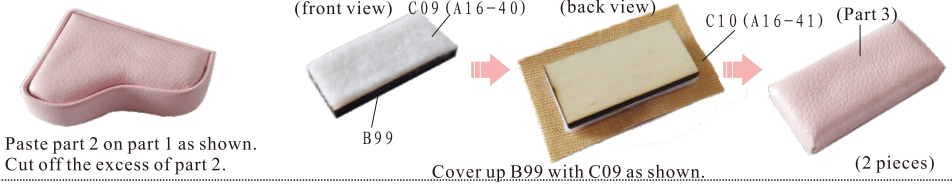
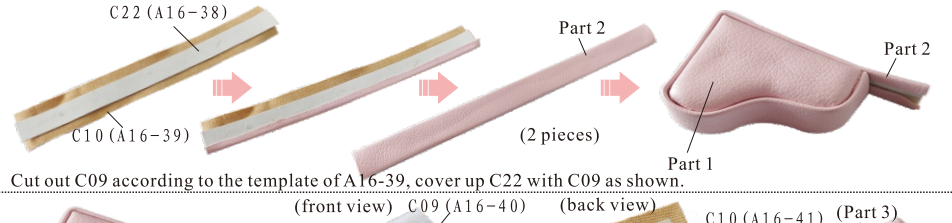

Dressing Table

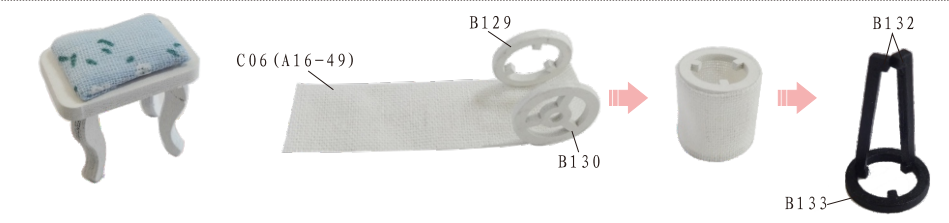
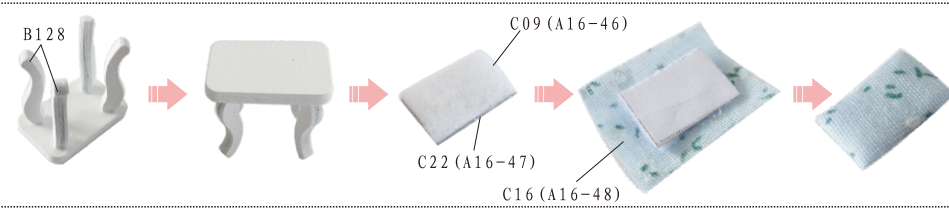
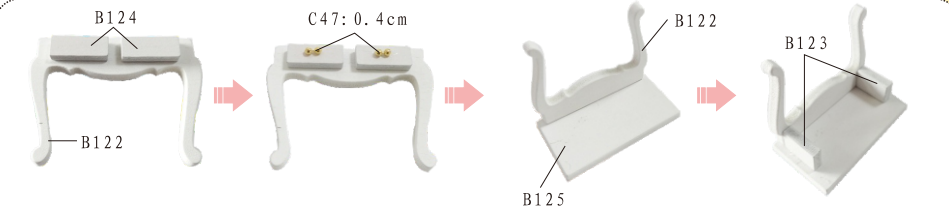

Bed

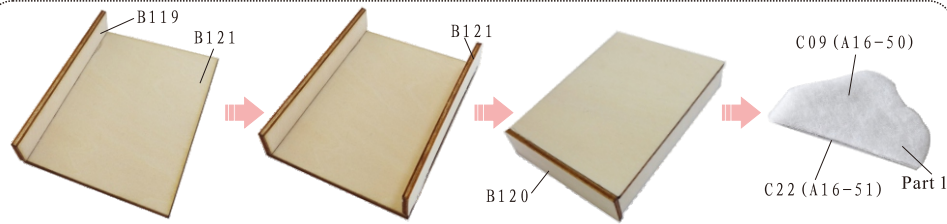

Cut out C09 and C22 according to the template of A16-50 and A16-51, attach them together as shown.



Cut out C16 according to the template of A16-52, cover up part 1 with C16 as shown.

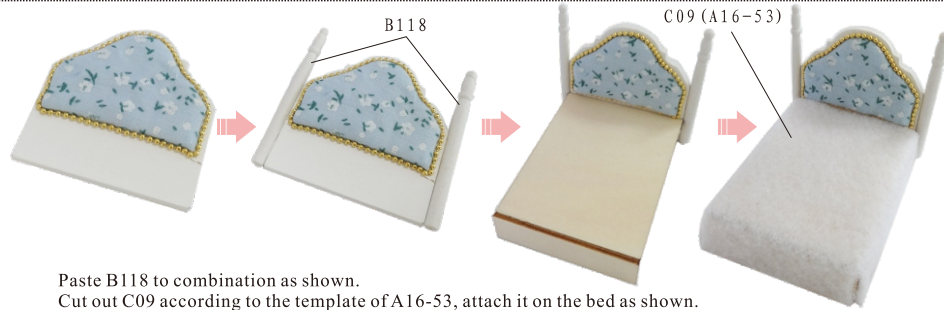

Paste B118 to combination as shown.

Cut out C09 according to the template of A16-53, attach it on the bed as shown.

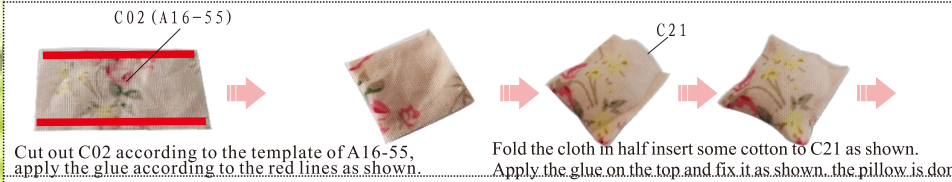

Cut out C02 according to the template of A16-55, apply the glue according to the red lines as shown.

Fold the cloth in half insert some cotton to C21 as shown. Apply the glue on the top and fix it as shown, the pillow is done.

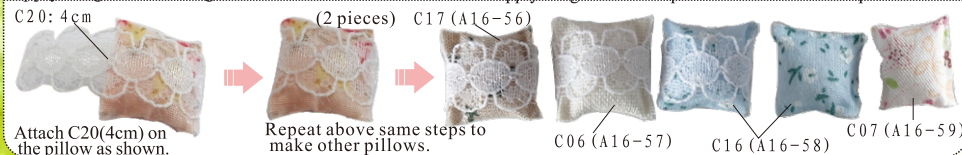

Attach C20(4cm) on the pillow as shown.

Repeat above same steps to make other pillows.

Rocking-chair

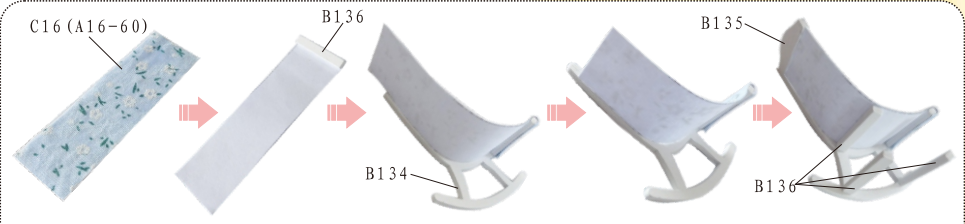

Attach C16 on A16-60 and cut out as shown.

Paste C16 to B134, cut off the excess of C16 as shown.

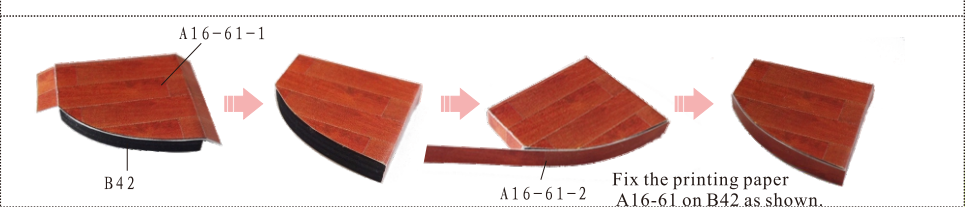

Fix the printing paper A16-61 on B42 as shown.

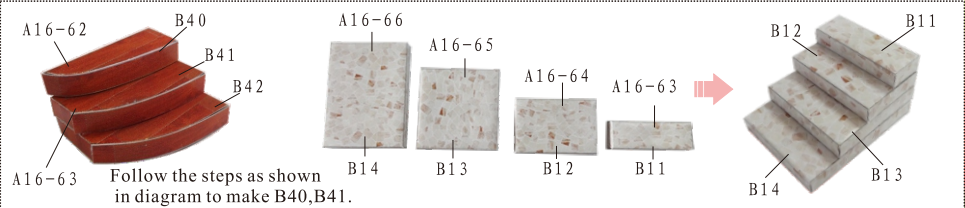

Follow the steps as shown in diagram to make B40, B41.

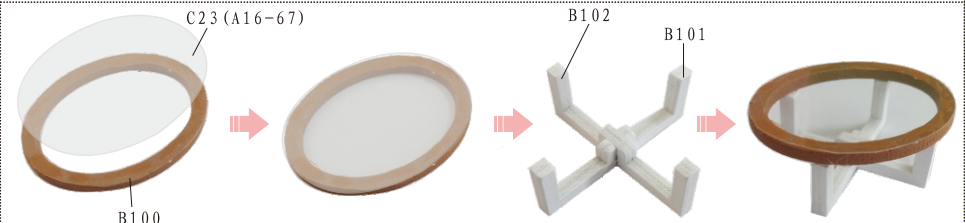

Cut out C23 according to the template of A16-67, and paste it on B100 as shown.



The making method of cup, please refer to page 4.

Bathroom

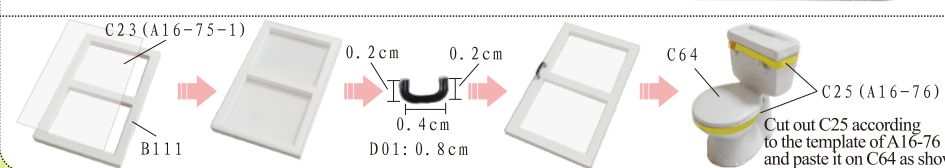
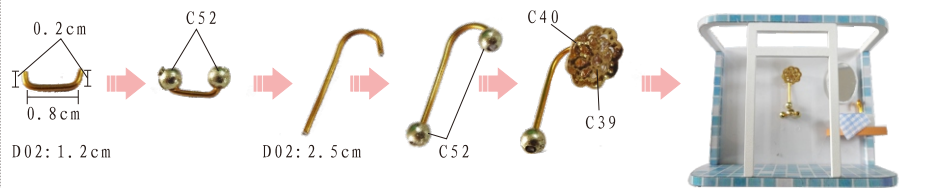
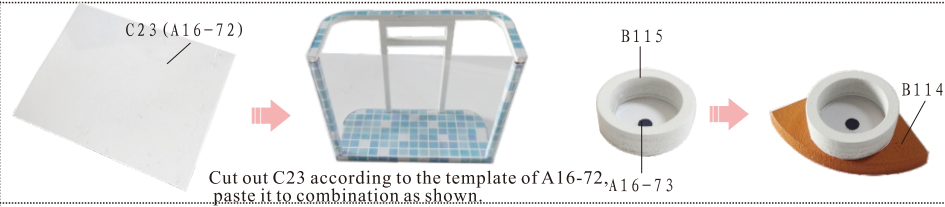
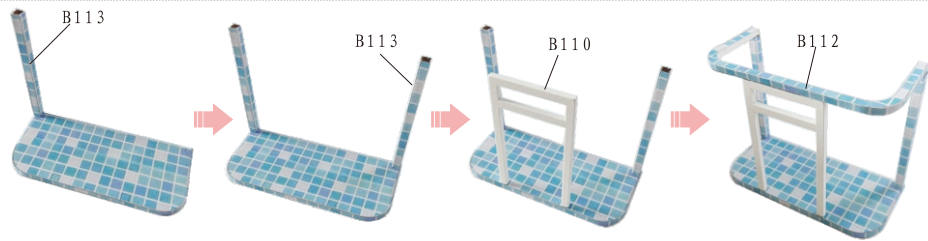
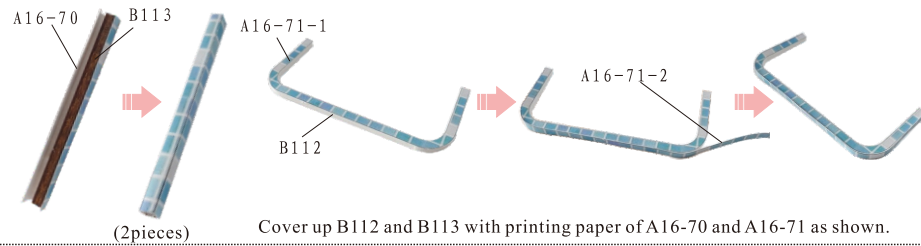
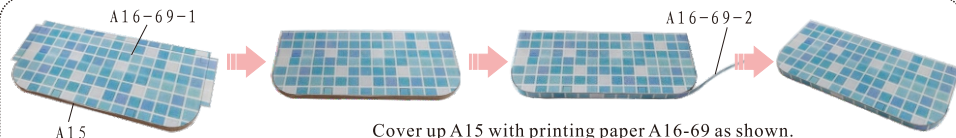

Bathroom

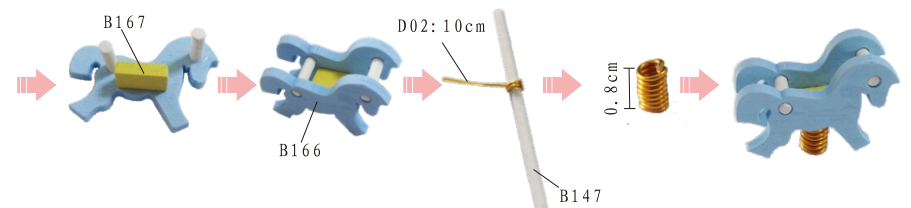
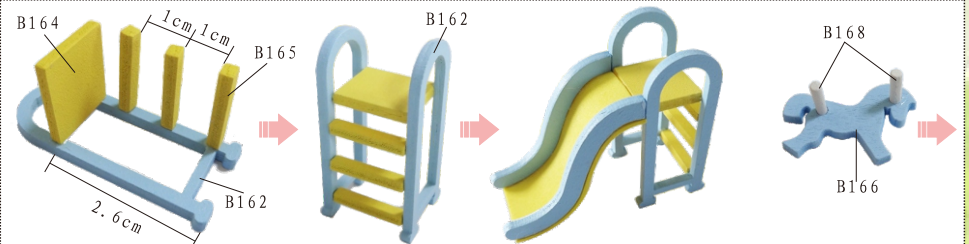
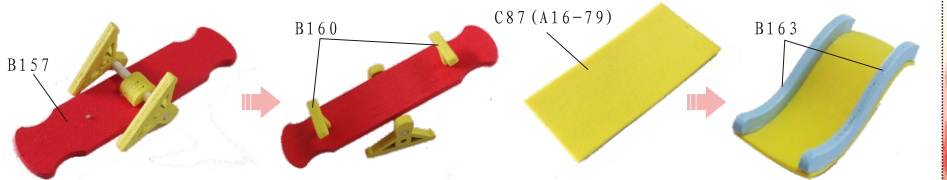
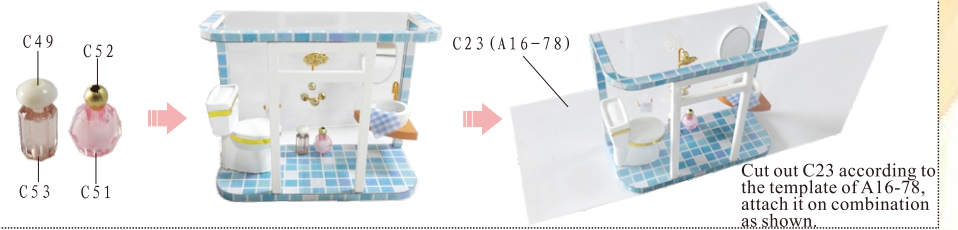
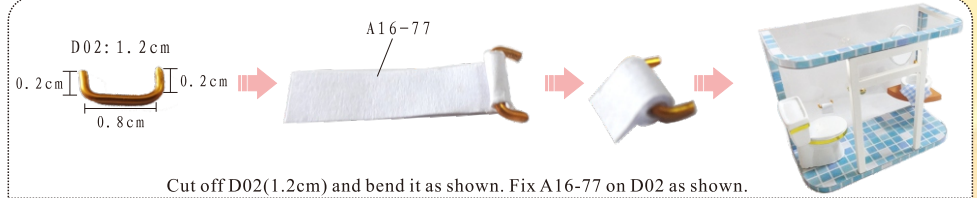

Cut off 1 piece of D02(10cm) and roll up as shown.(Please make it out of B147)

Swing

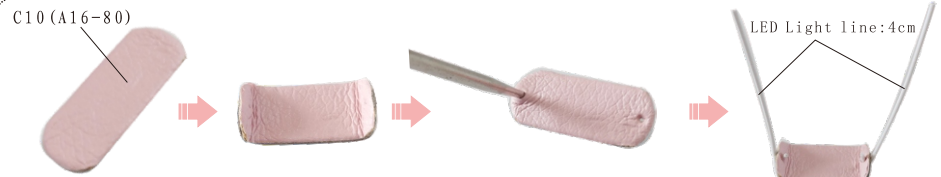

Attach C10 on A16-80 and cut out, fold it as shown. Use the tool to make two small hole on the side of C10 as shown.

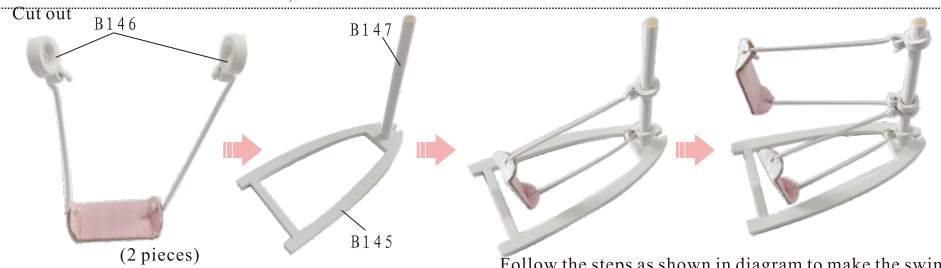

Follow the steps as shown in diagram to make the swing.

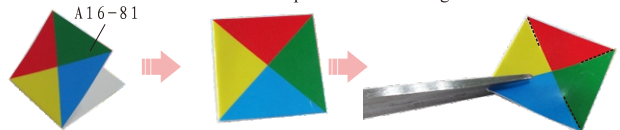

Cut off A16-81, fold it well, cut the dotted line as shown.



Follow the steps as shown in diagram to make the windmill.

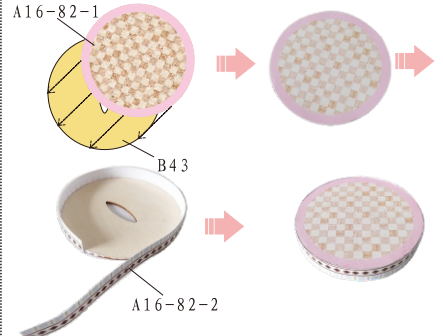
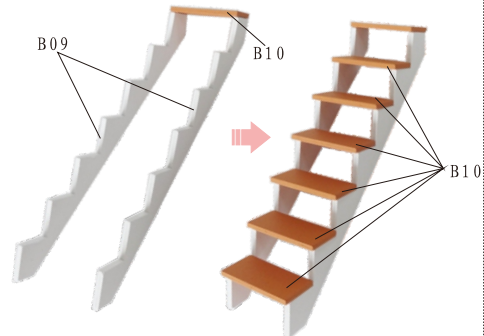

Piano

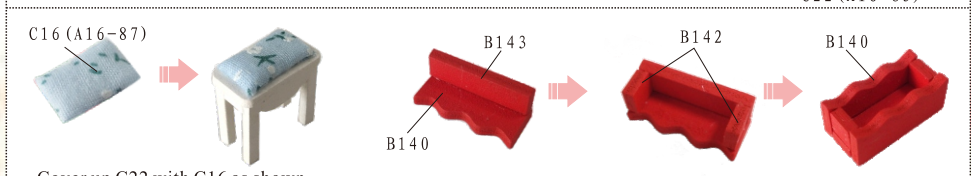
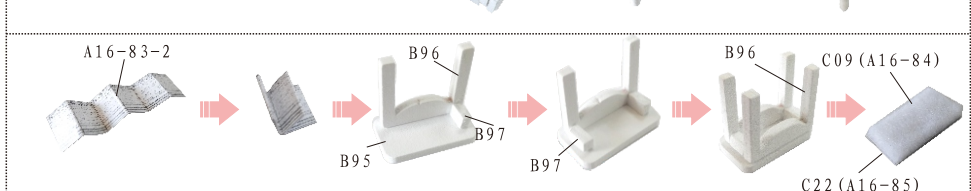
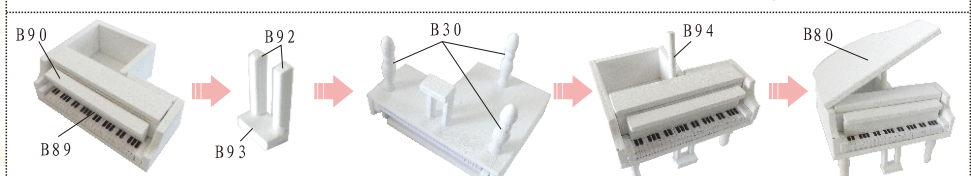
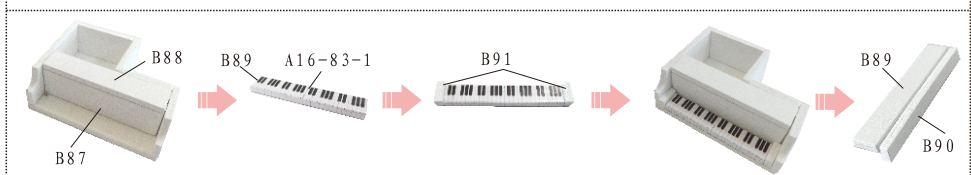
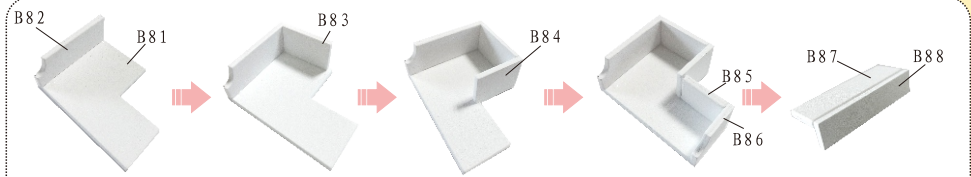

Cover up C22 with C16 as shown.

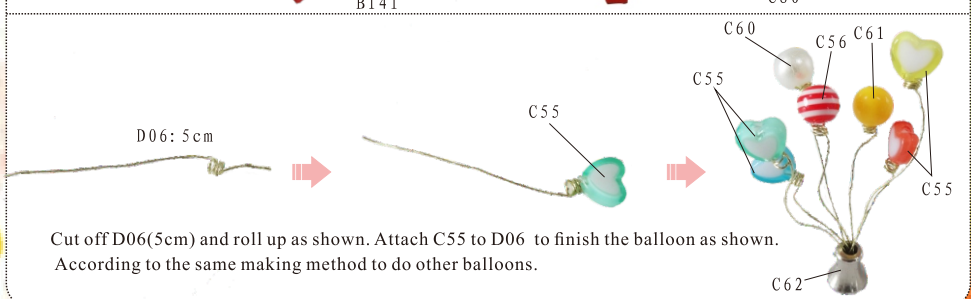
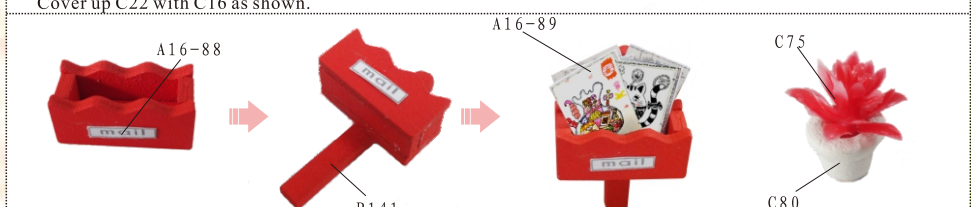

Cut off D06(5cm) and roll up as shown. Attach C55 to D06 to finish the balloon as shown. According to the same making method to do other balloons.

Swimming pool

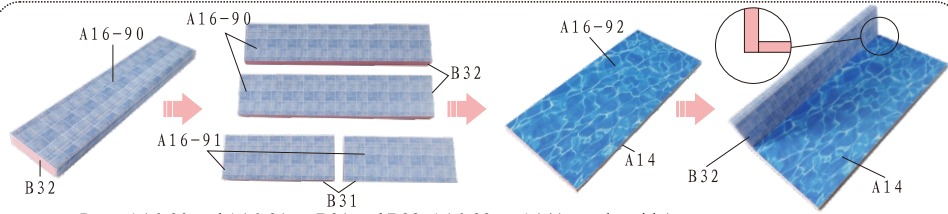

Paste A16-90 and A16-91 on B31 and B32. A16-92 on A14 (no color side)

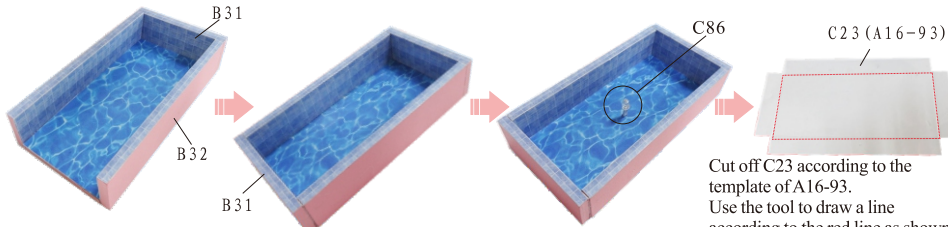

Fix C86 on the hole of A14 as shown.

Cut off C23 according to the template of A16-93. Use the tool to draw a line according to the red line as shown, fold it well.

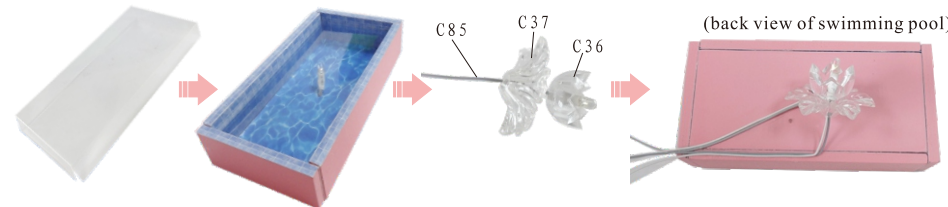

(back view of swimming pool)

Paste C23 on the swimming pool as shown.

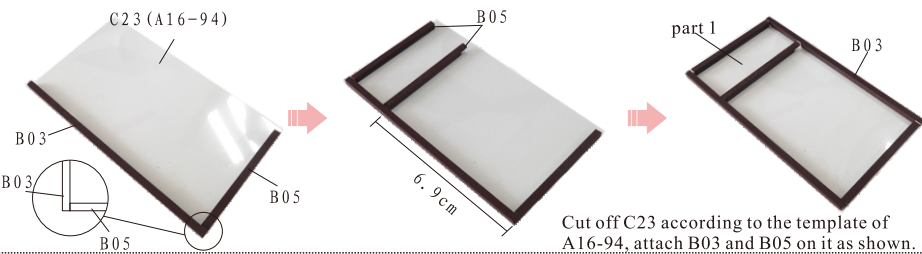

Cut off C23 according to the template of A16-94, attach B03 and B05 on it as shown.

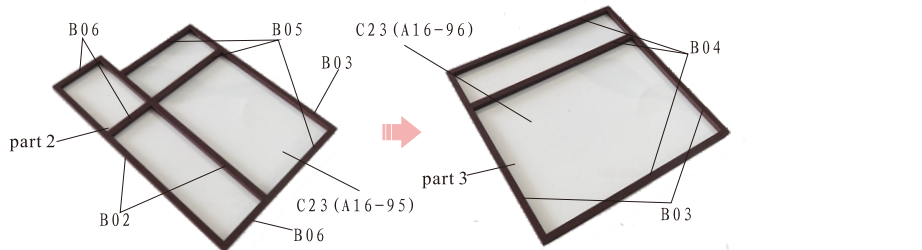

Follow the steps as shown in diagram to make the street lamp.

Grass room

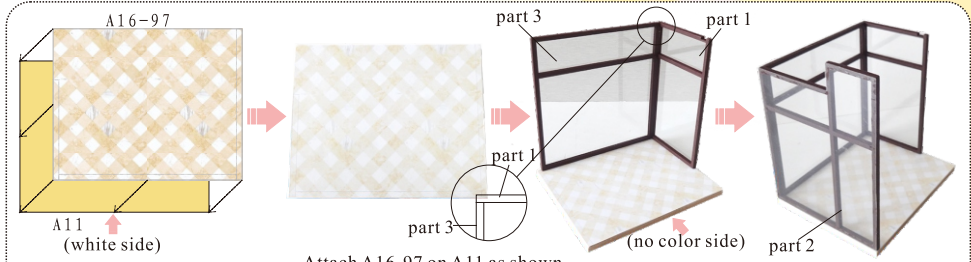

Attach A16-97 on A11 as shown.



Paste C01 to combination, cut off the excess of C01 as shown.

Follow the steps as shown in diagram to make the curtain.

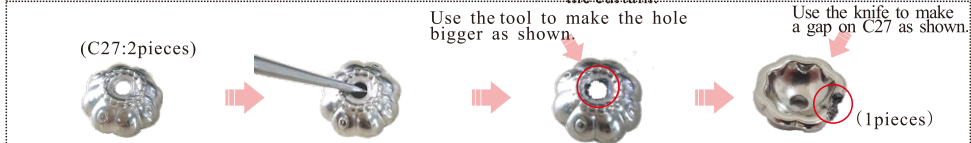

Use the tool to make the hole bigger as shown.

Use the knife to make a gap on C27 as shown.

(C27:2pieces)

(1pieces)

Follow the steps as shown in diagram to make it. (PS: Use the tools to make the hole bigger to make sure the LED wires can through).

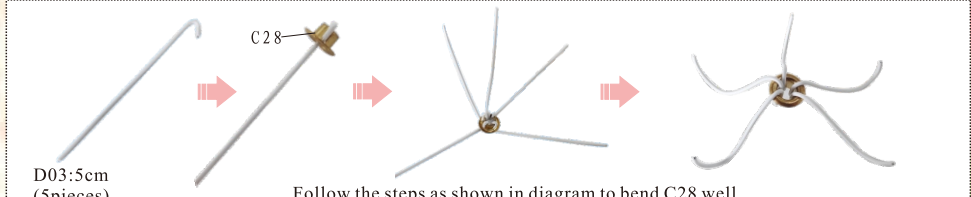

D03:5cm (5pieces)

Follow the steps as shown in diagram to bend C28 well.

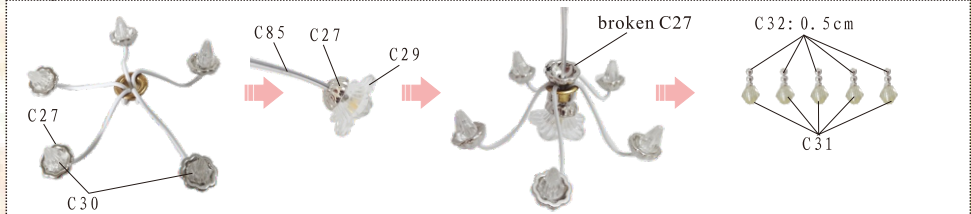

C27

C85

C27

C29

broken C27

C32: 0.5cm

C31



on the first floor lamp

C27(3pieces)

Paste C47 and C31 well as shown. Cut C27 and C38 in half according to the dotted line as shown. (need 3pieces)

Chandelier

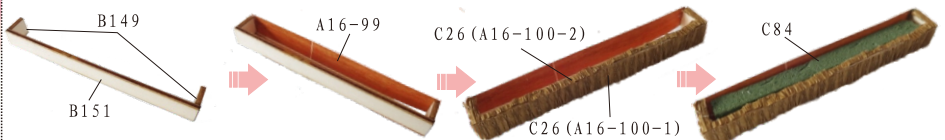
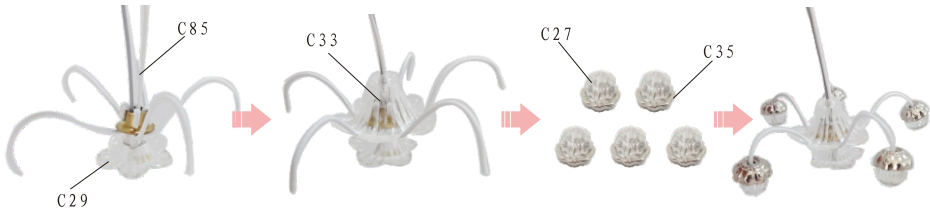
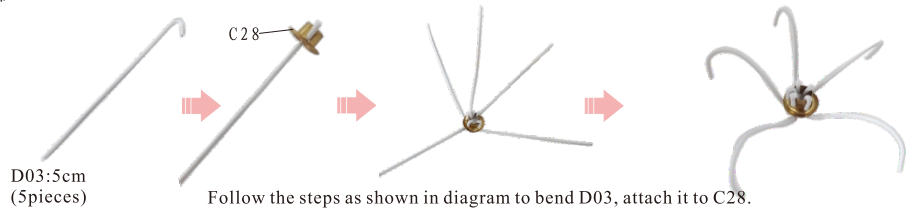

Follow the steps as shown in diagram to make the flower groove. Then put C84 in.

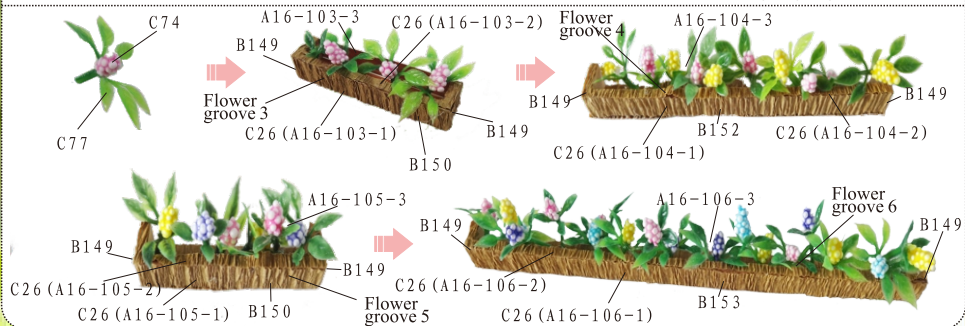
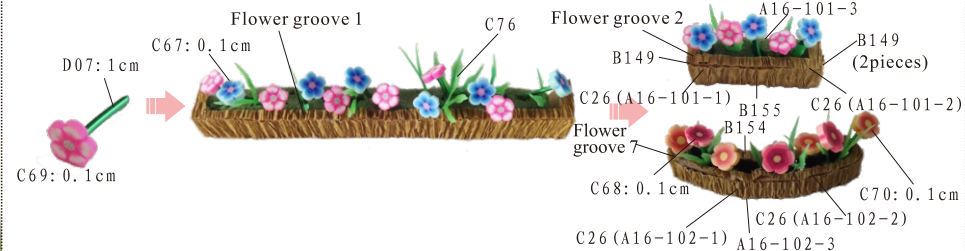

Outer Frame

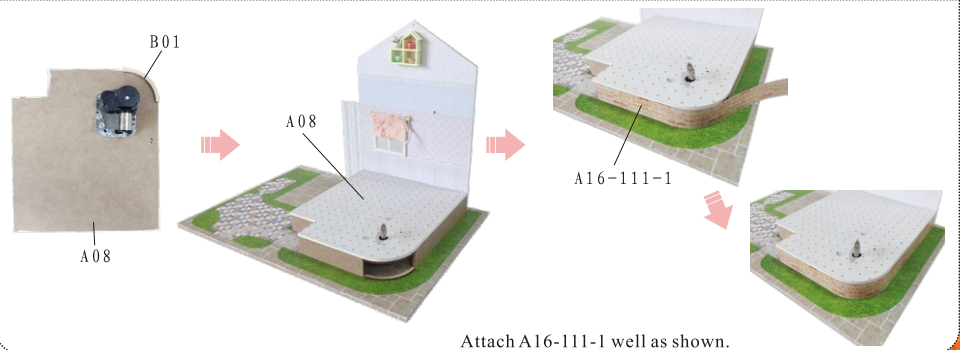
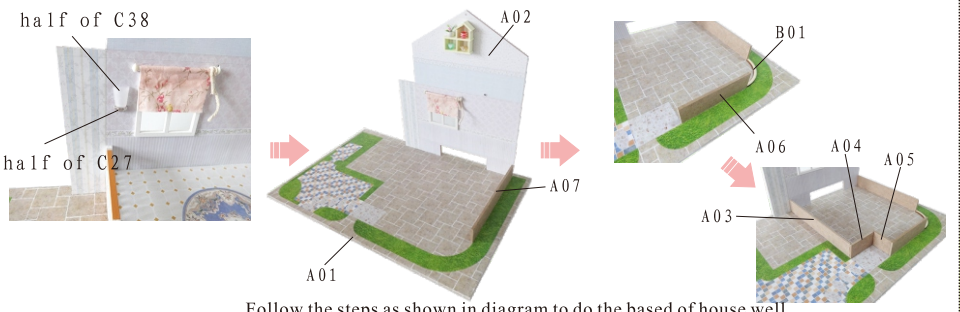
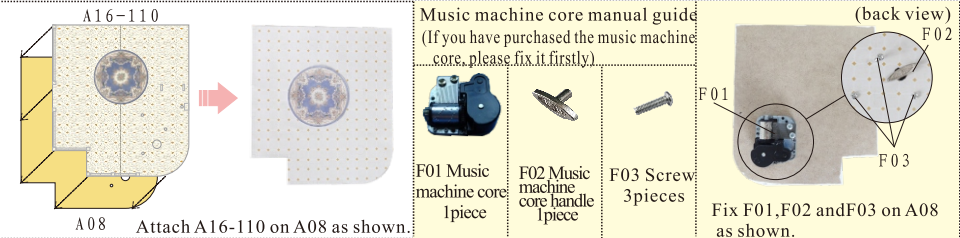
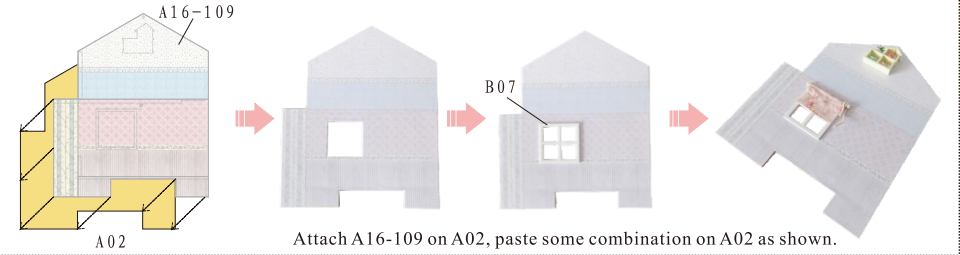
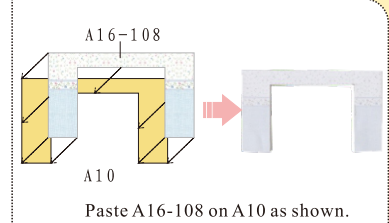
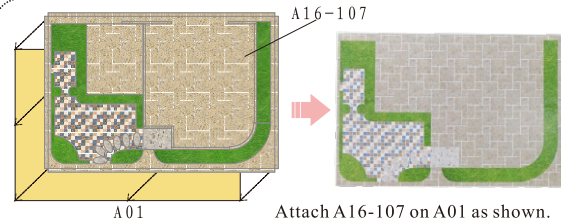

Outer Frame

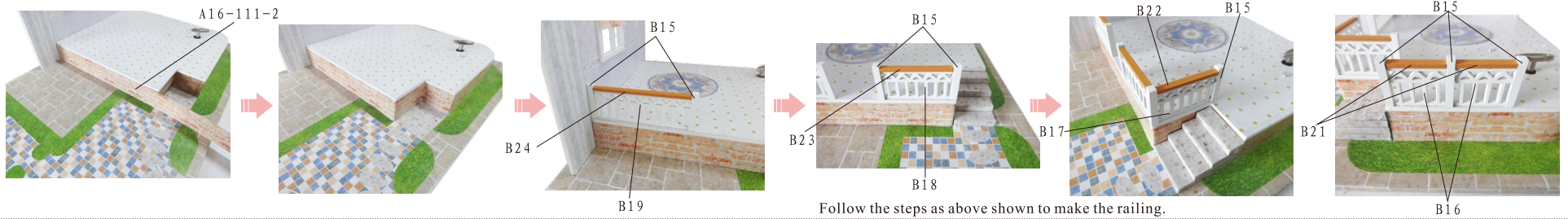

Follow the steps as above shown to make the railing.

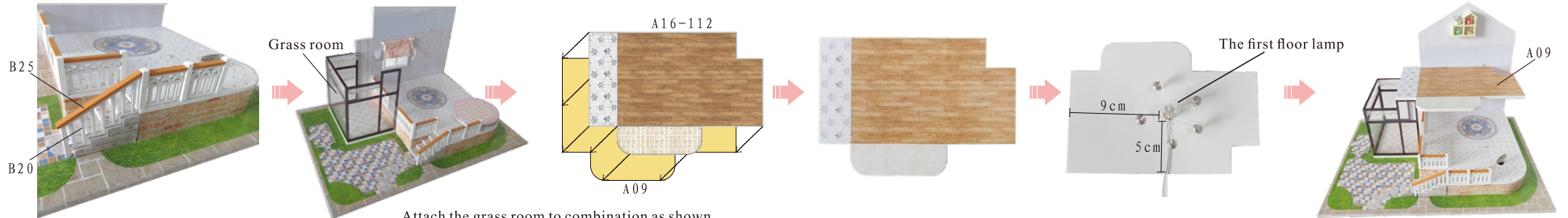

Attach the grass room to combination as shown.



Follow the steps as shown to make B156 well and fix it to combination.

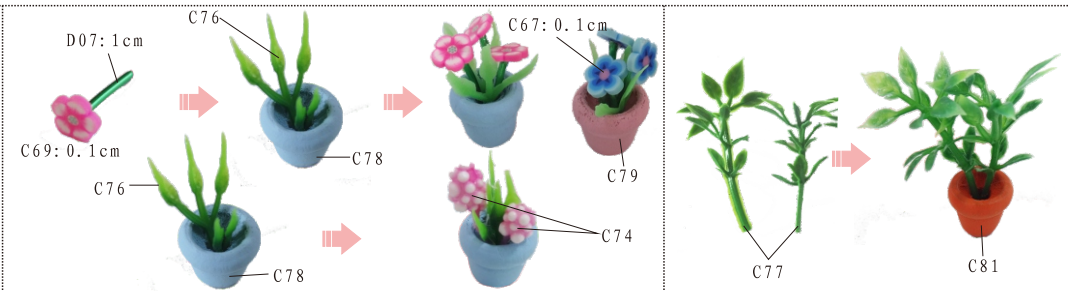

Fix the stairs to combination as shown.

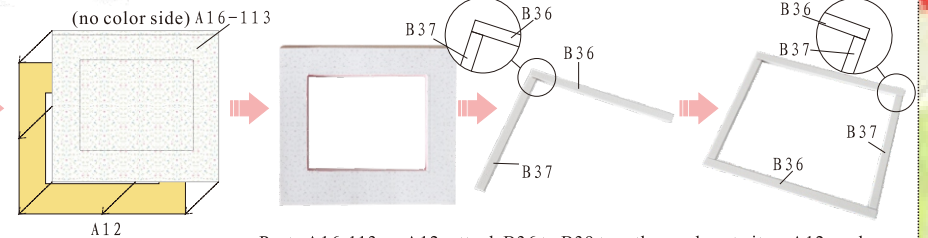

Paste A16-113 on A12, attach B36 to B39 together and paste it on A12 as shown.

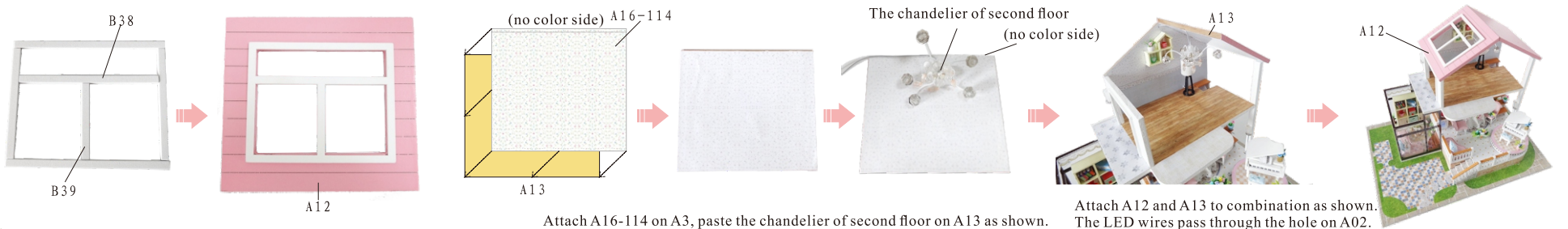

Attach A16-114 on A3, paste the chandelier of second floor on A13 as shown.

Attach A12 and A13 to combination as shown. The LED wires pass through the hole on A02.

Outer Frame



Cut off C23 according to the template of A16-115, attach it on B35 as shown.

Fix the flower groove 3 and steps to combination as shown.

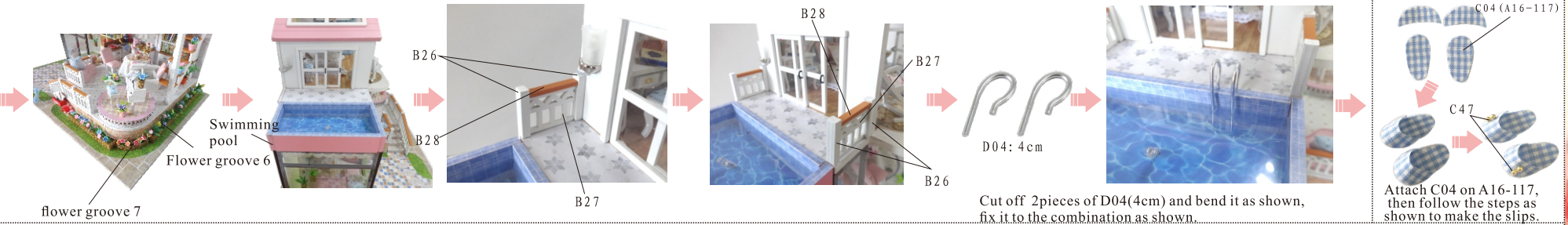
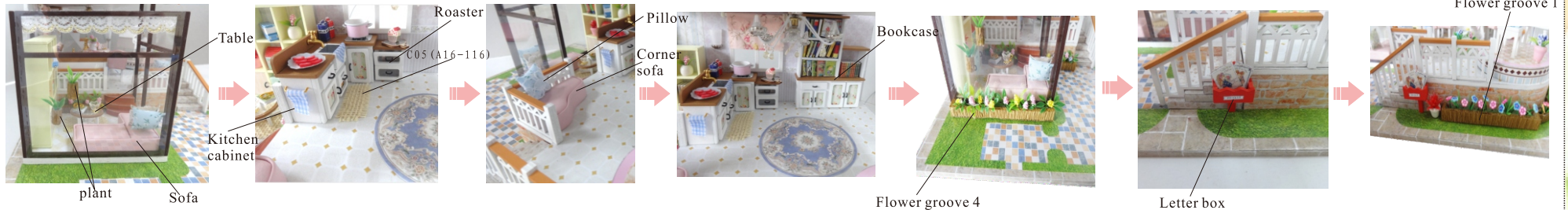

Cut off 2pieces of D04(4cm) and bend it as shown, fix it to the combination as shown.

Attach C04 on A16-117, then follow the steps as shown to make the slippers.

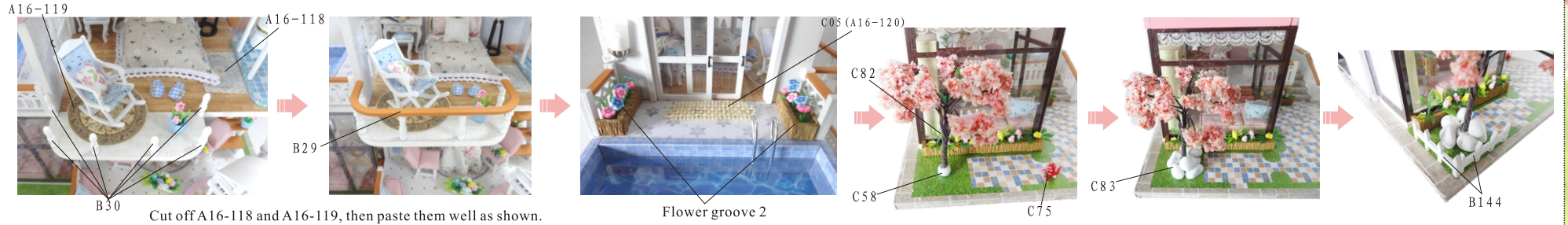

Cut off A16-118 and A16-119, then paste them well as shown.

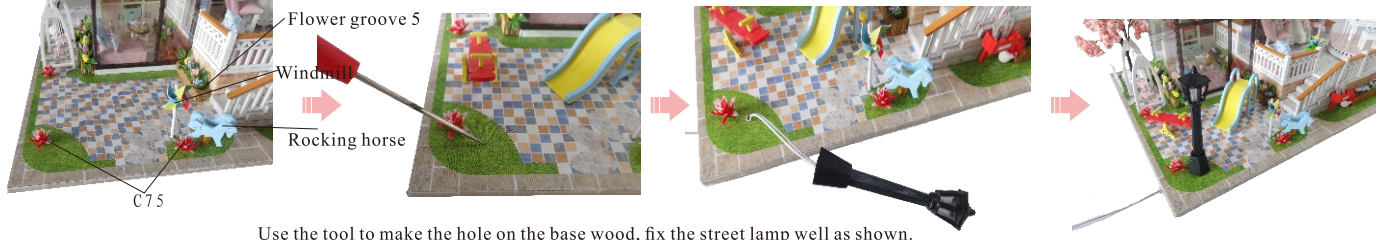

Use the tool to make the hole on the base wood, fix the street lamp well as shown.

How to connect to battery box

Statement: the lamp wires cannot be inserted into the output socket.

- Please notice the place of anode and cathode when pit in the batteries
- Rechargeable batteries are not blunt electricity
- Rechargeable batteries can only be charged under adult supervision

- Rechargeable batteries should be removed from the toy before charging
- Different types of batteries cannot mix; Do not mix new batteries in use with semi-used batteries.
- Run out of battery should be removed from the toy
- The power shall not be short circuit

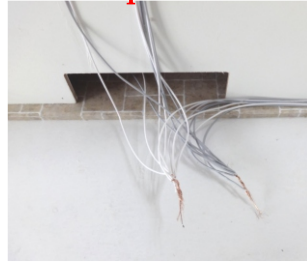

1. Trim all the LED wiring to the same length.
2. Use a craft blade to carefully skim over the plastic to bare the copper wire. Twist the same colour wire together.

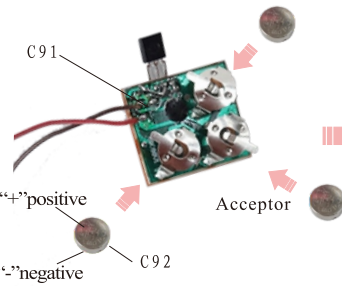

Insert the battery take notes on the polarity.

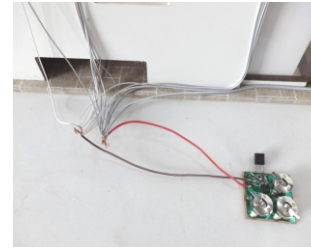

3. Twist the following wire together:
 - (I) BLACK wire from the battery box with the WHITE wire from LED bulb.
 - (II) RED wire from the battery box with the GREY wire from LED bulb.

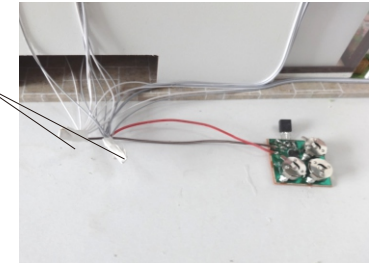

4. Roll and seal the duly twist copper with the white tape provided. Place the battery box in the allocated space

Installation of dust proof cover (For updated version, the parts need to be purchased separately)



F04 Transparent cover
0.18*1.5*32 (1piece)



F05 Transparent cover
0.18*24*32 (2pieces)



F06 Transparent cover
0.18*21.14*24 (2pieces)



1. Tear off kraft paper of each piece of transparent cover.

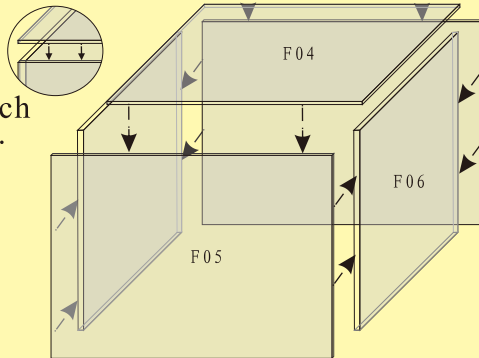

2. Paste F04, F05, and F06 together to complete the dust proof cover as shown.

Photo of Dust proof cover



Photo Gallery





Attention: Please keep the instruction manual for future enquires after installation.