

13848

DIY handmade goods—

Dream back to
Ancient Town

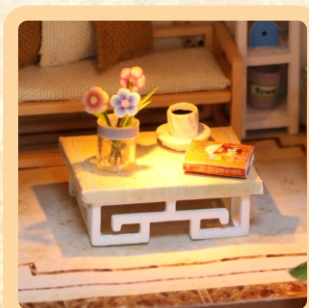

13848 Instruction manual

NOTICE OF ASSEMBLE

Bring your own tools



Scissors:
Can be used to cut printed paper, cloth, etc.



Screw Driver:
For fixing screws, mostly can be used to install doors and music components.



Tweezers:
For holding small materials and rolling up iron wire.



Cutter knife:
For peeling off power wire skin and cutting off materials.



Ruler:
For measuring materials to identify the number of materials so as to enhance work efficiency.

⚠ Warnings

- The product is not suitable for children under 14 years old. They should be under custody of adults when playing with the product.
- There are small parts, please do not swallow them for avoiding dangerous accidents.
- Please also pay attention to the sharp-pointed materials to avoid injuries.

Making tips

1. LED wiring indication: White=Positive; Grey=Negative.
2. Use a craft blade to carefully skim over the plastic to bare the copper wire.
3. For LED wiring extension, please refer to the below steps:

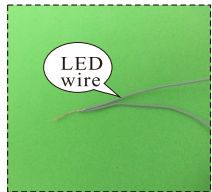

Twist the copper of both LED wire and extension wire together.



Do the same on the white wire.
Remarks: Tie a knot at the end of the grey wire to differentiate the polarity.

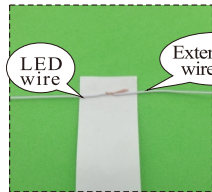

Place the duly twist wire on the tapes provided.

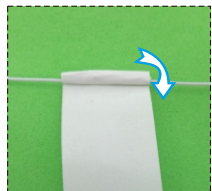

Roll and wrap the wire.

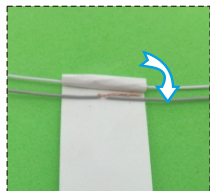

Place another wire next to it.
Remarks: DO NOT contact both copper wire to avoid short circuit.



Roll and wrap it together.

Tips for assembling

1. Pictures shown on the package may be slightly different from the actual product.
2. Please use the provided tracing paper for cutting purpose to achieve the best outcome.
3. Product designs and specification may be subject to change without advance notice for purpose of making improvement.
4. Testing on LED function:



DO NOT contact the LED wire end directly to the battery cell.

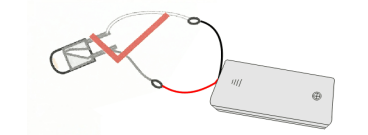

Use the provide battery holder.
Make sure the correct polarity.

How to assemble the battery holder



1. Material and tools needed:
- Battery holder, LED bulb, tape, screw driver and 2 piece AA size battery (not provided)



2. Use screw driver and take the lid off from the battery holder.



3. Insert the battery take notes on the polarity.



4. Connect the red wire to grey wire. Connect the black wire to white wire.

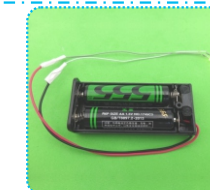

5. Wrap the exposed wire with the tapes.



6. Place the box lid and fasten with screw driver.

Product information



Tea table

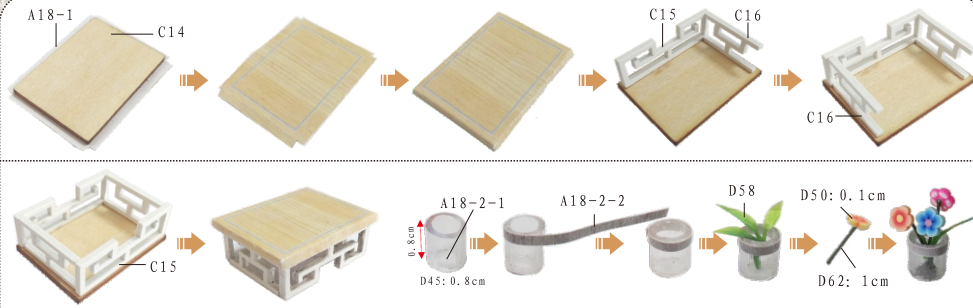

Book folding



Sofa

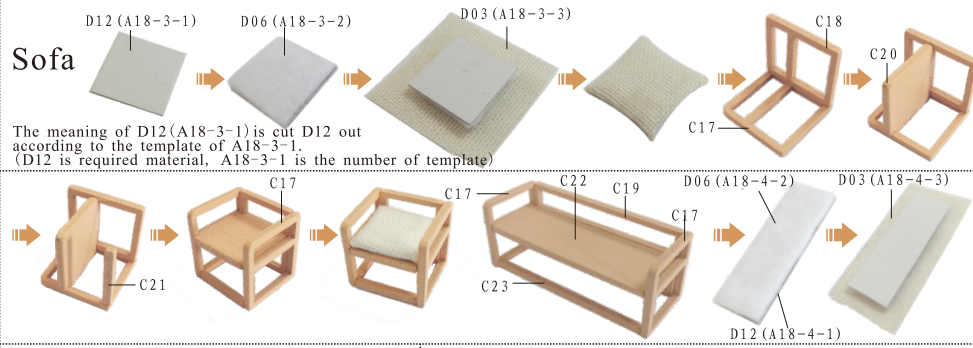

Shelving

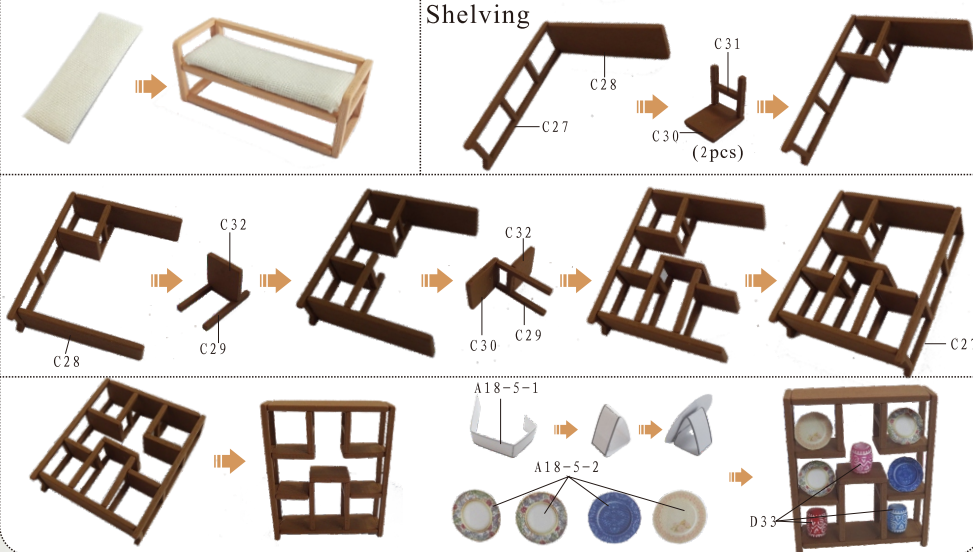

Bookcase



Bed

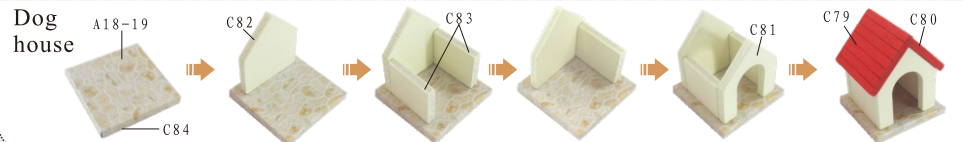
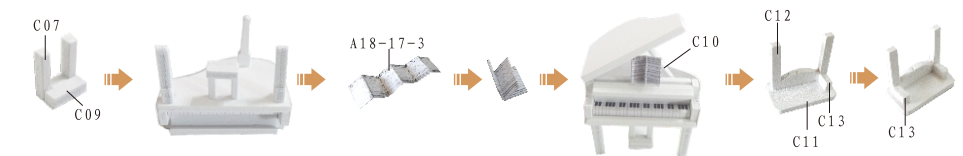
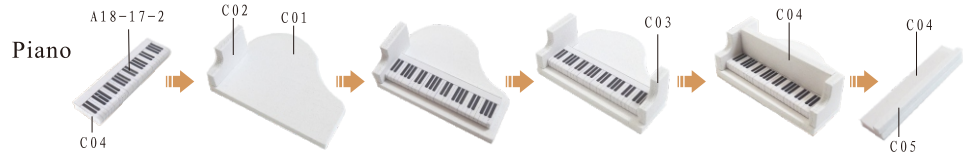
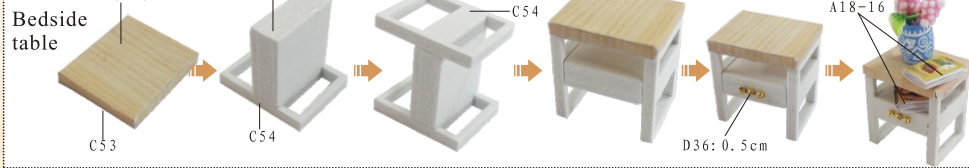
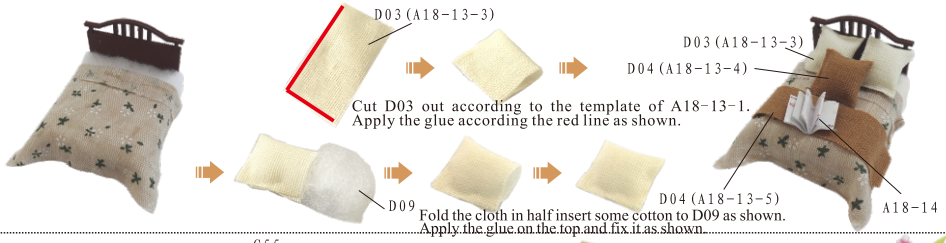
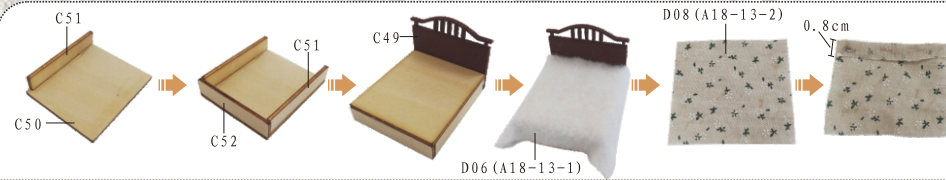

Wash basin cabinet

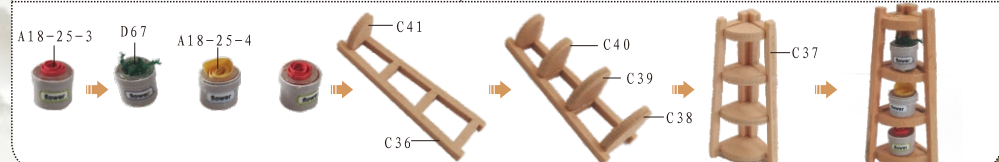
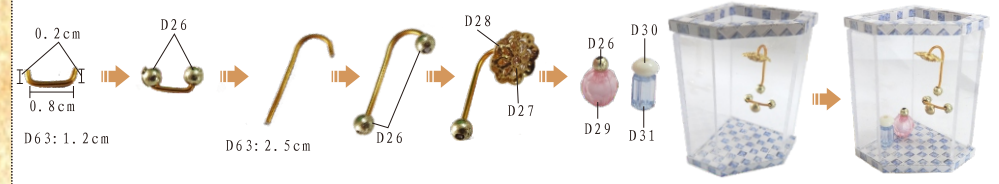
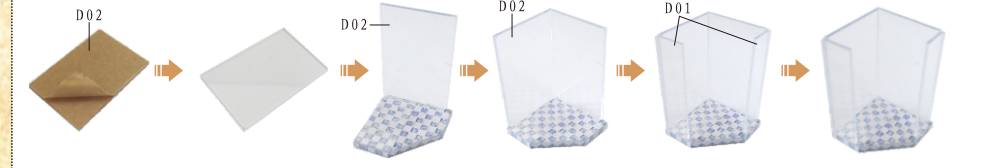
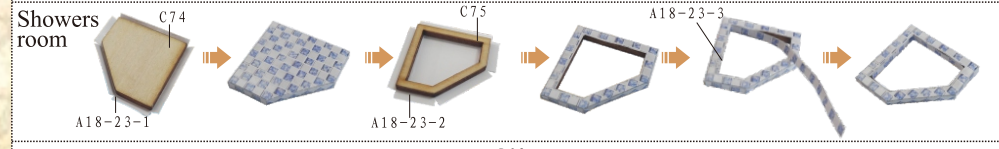
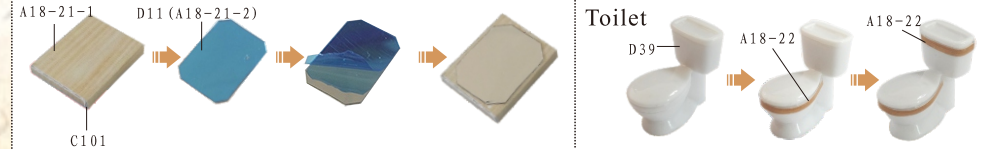
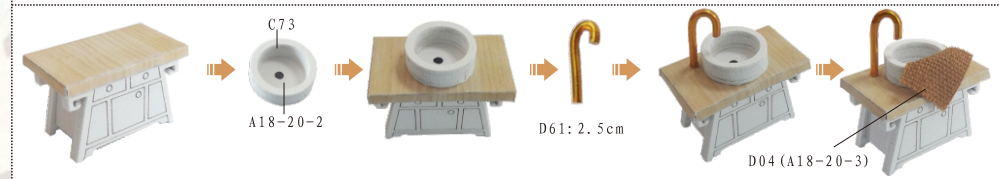
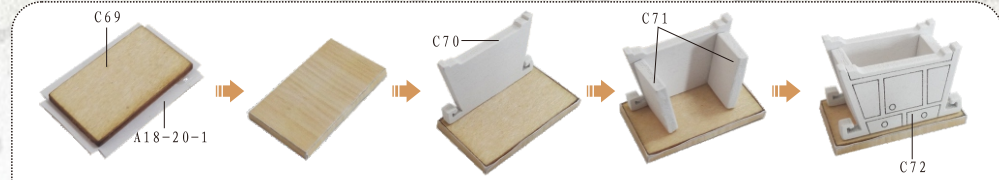

Flower shelving

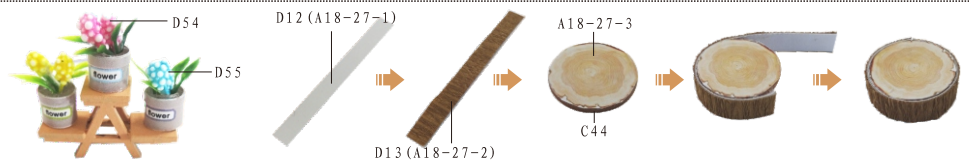
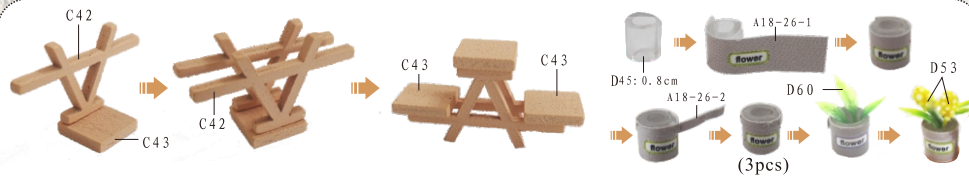

According to the same steps to do the other flowers, the material is D48,D49,D51.

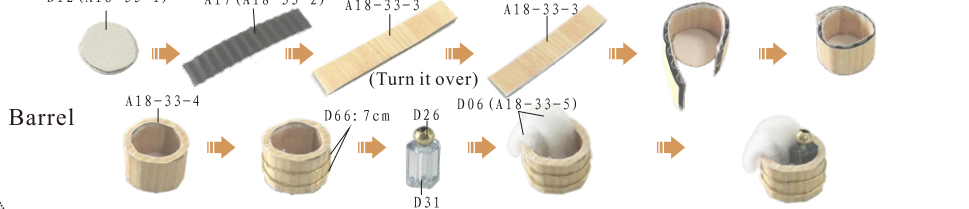
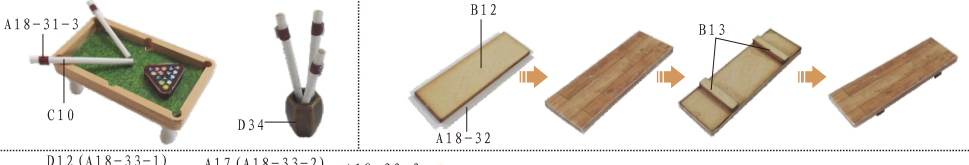
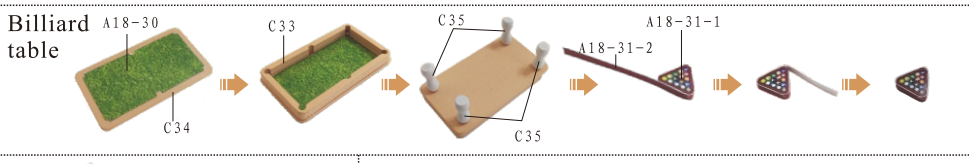
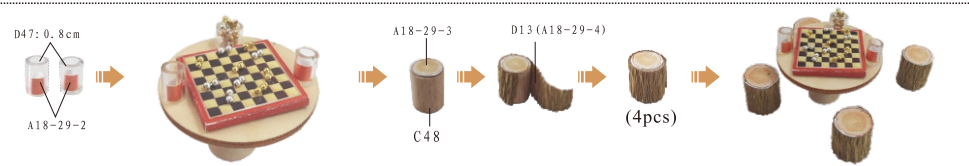
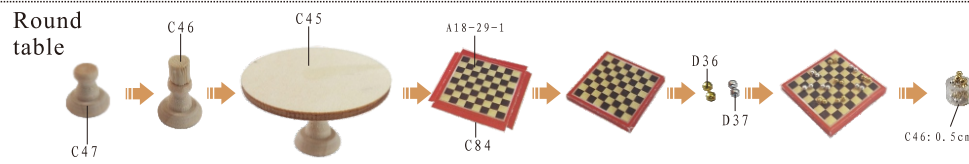

Lantern

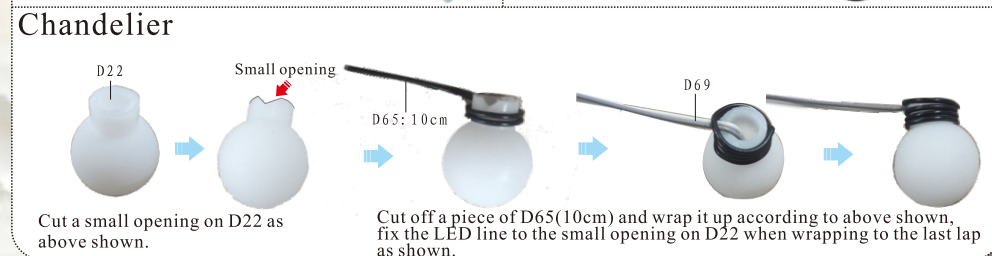
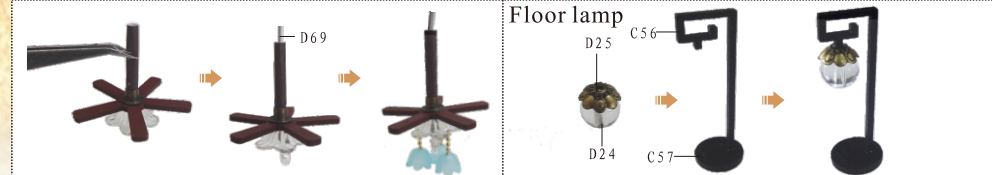
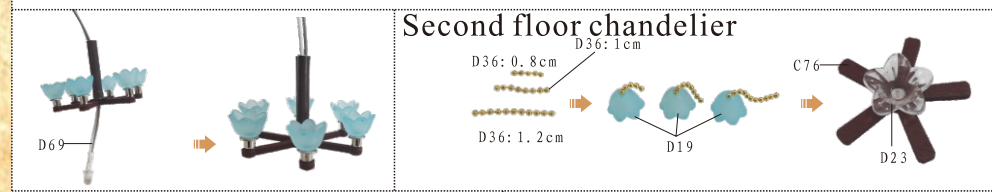
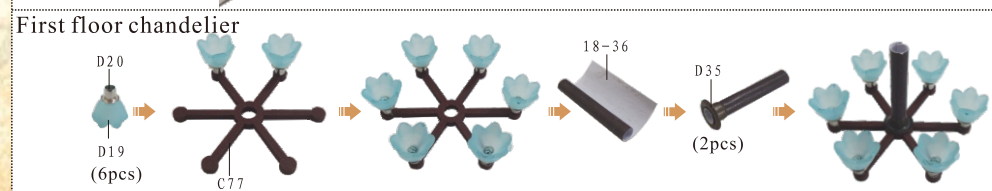
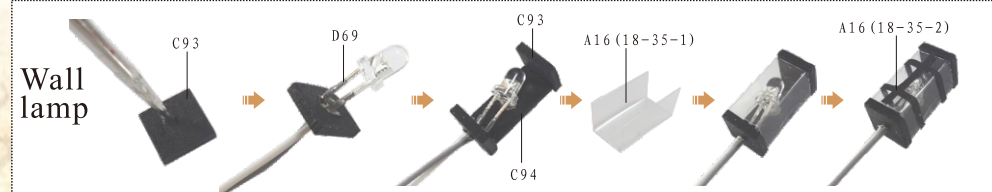
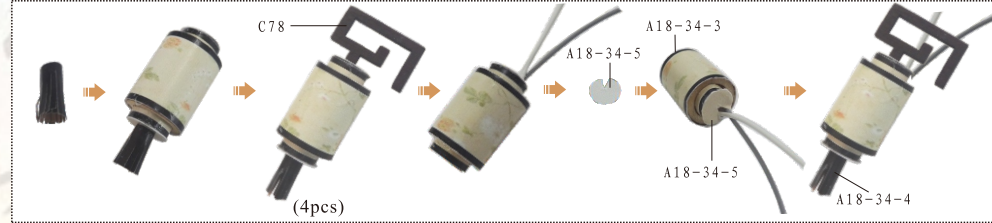

Cut a small opening on D22 as above shown.

Cut off a piece of D65(10cm) and wrap it up according to above shown, fix the LED line to the small opening on D22 when wrapping to the last lap as shown.

Chandelier

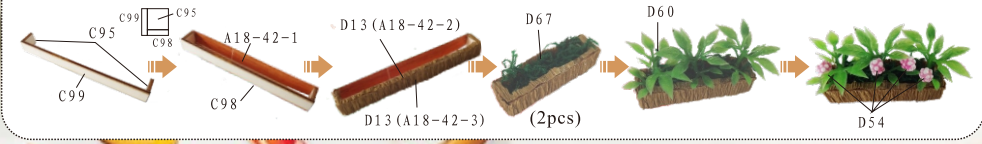
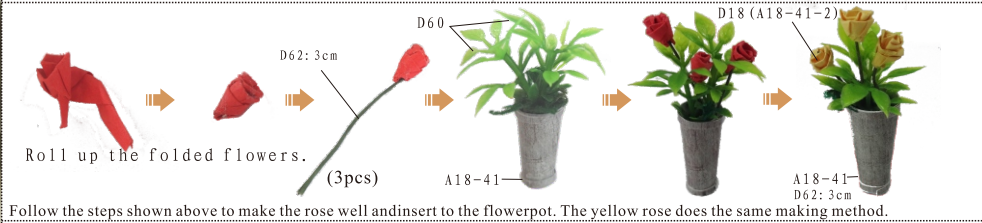
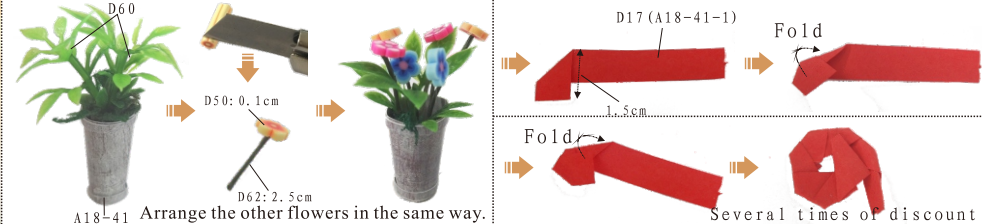
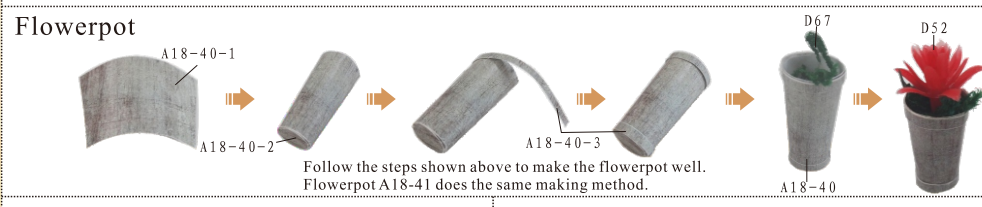
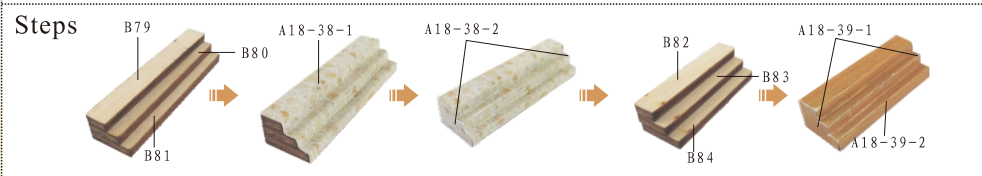
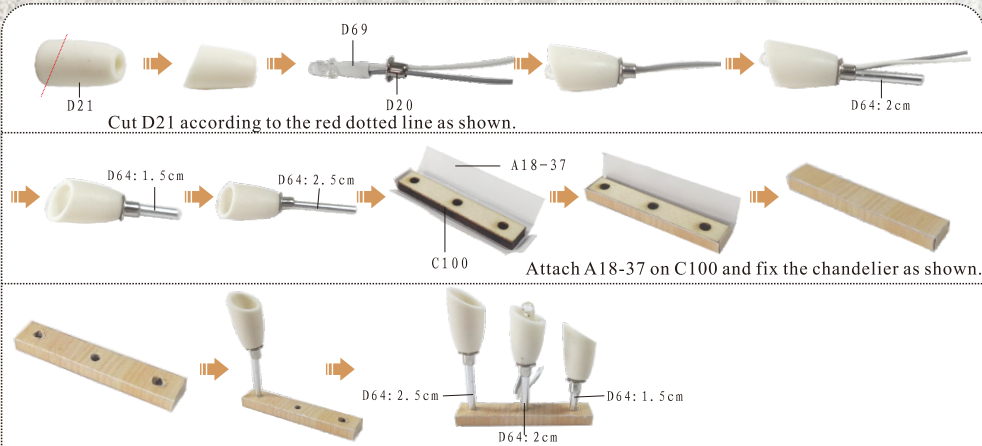

Sunflower

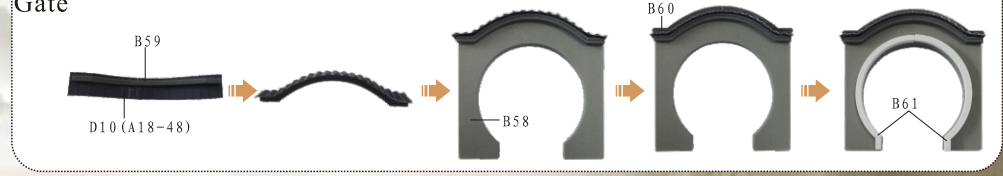
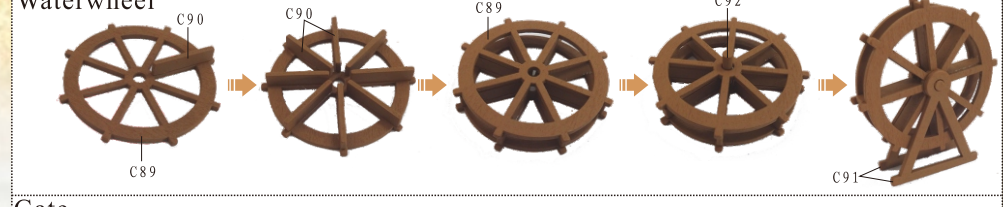
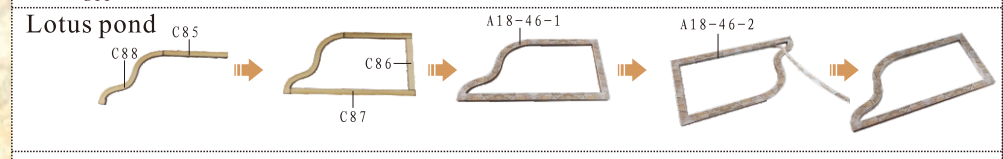
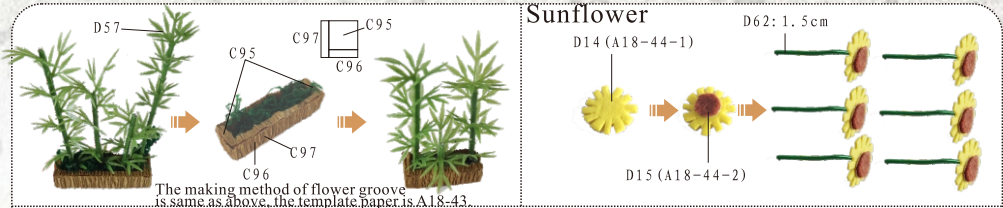

Outer frame

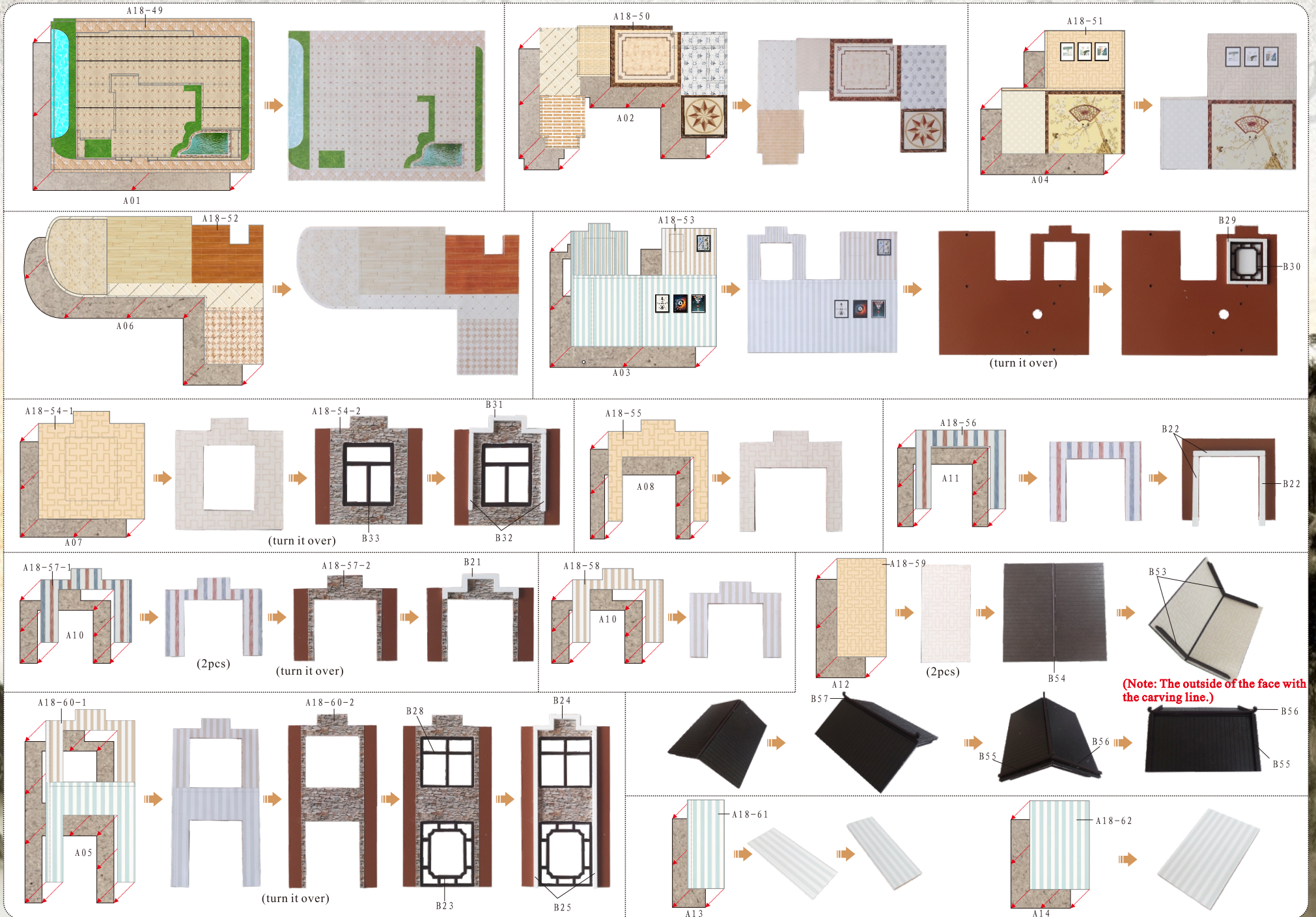

Outer frame

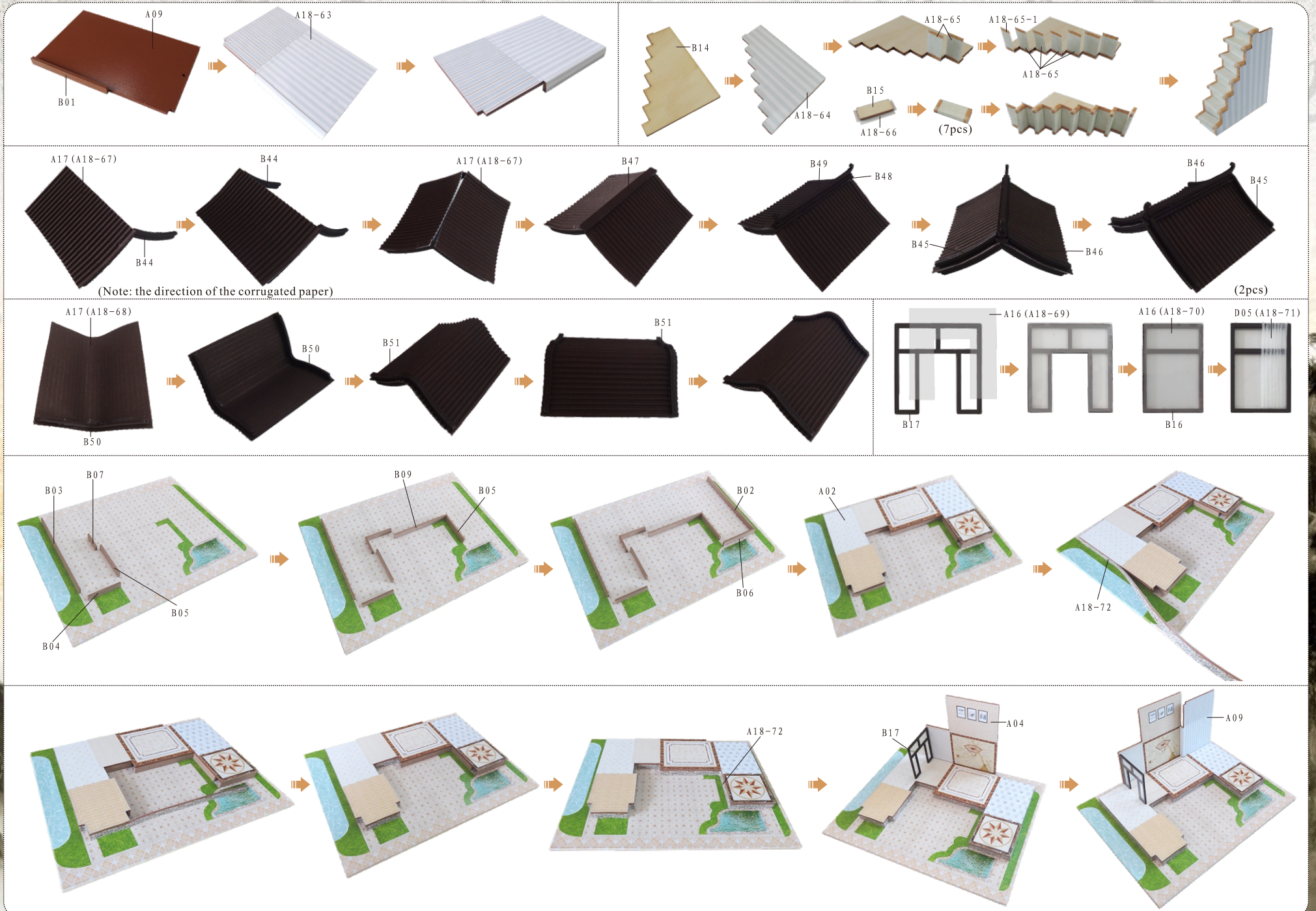

Outer frame

Music machine core manual guide (If you have purchased the music machine core, please fix it firstly)



E01 Music machine core
1 piece



E02 Music machine core handle
1 piece



E03 Screw
3 pieces

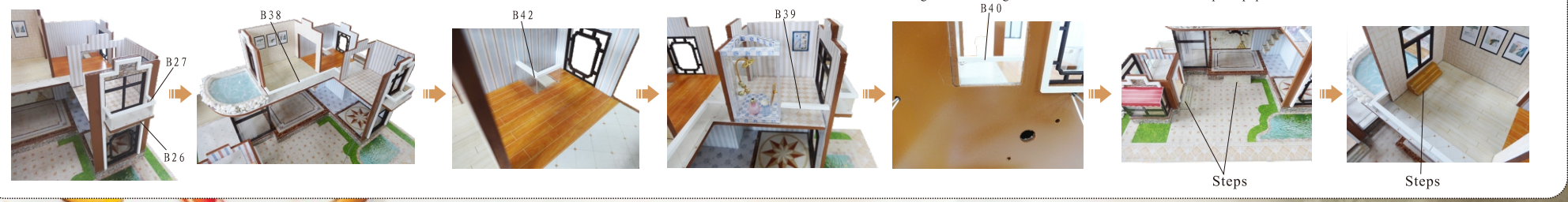
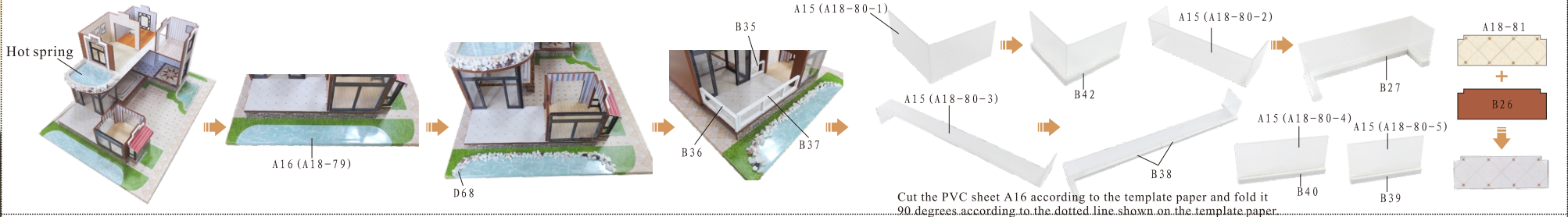
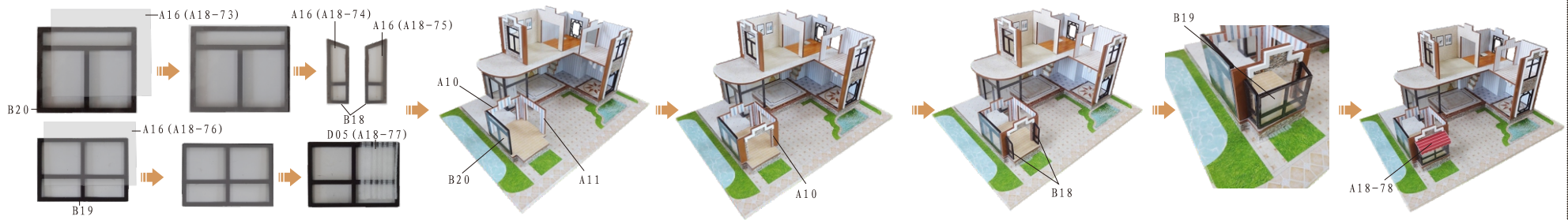
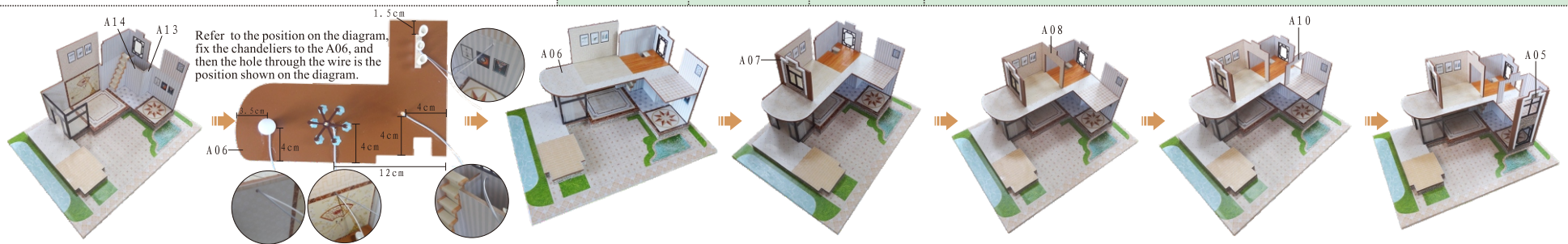
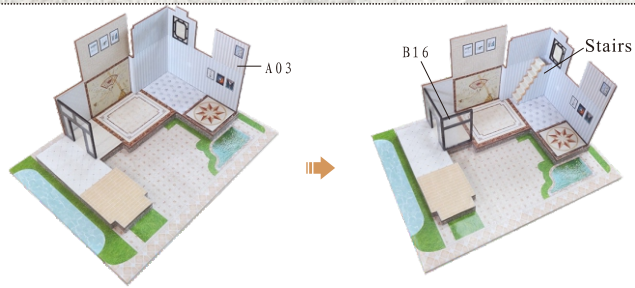
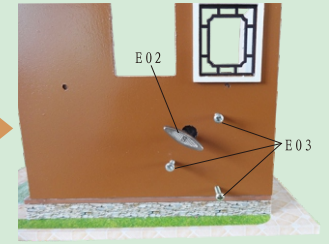

Outer frame

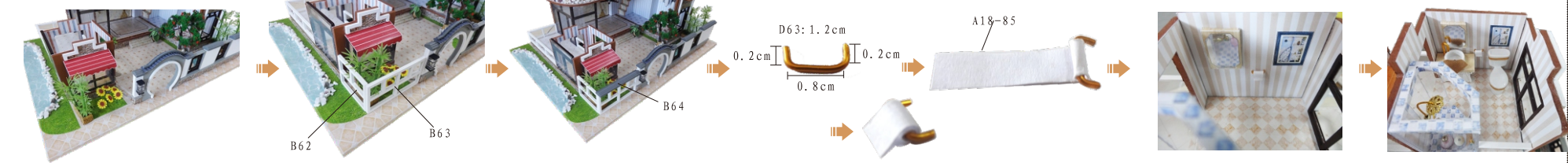
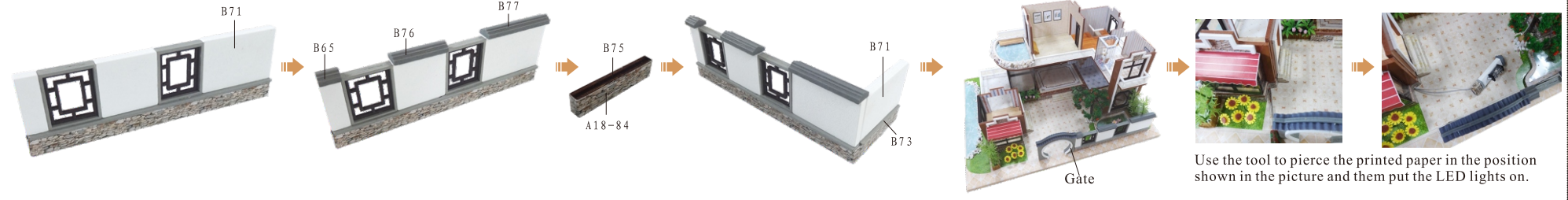
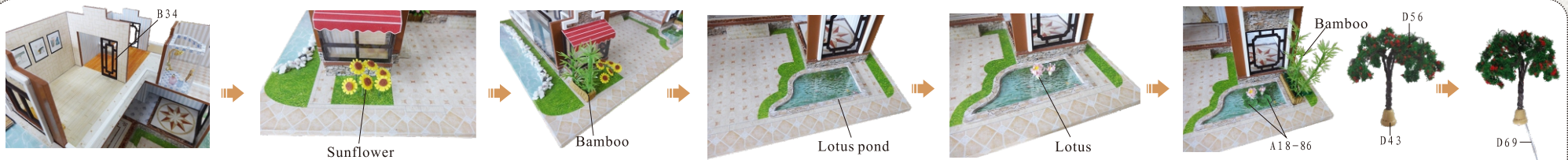

Outer frame

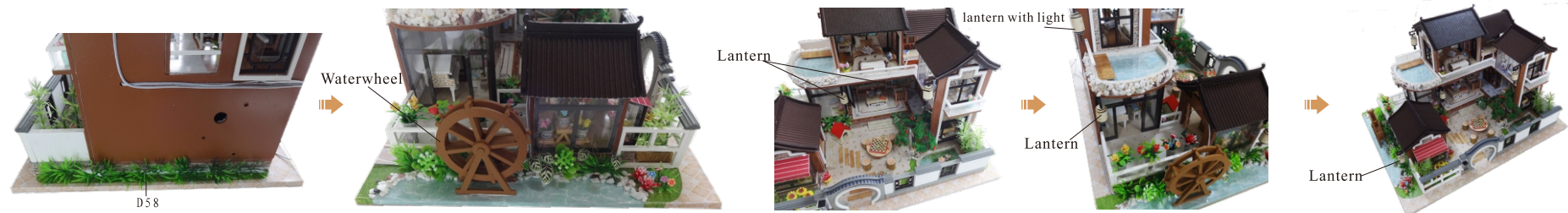
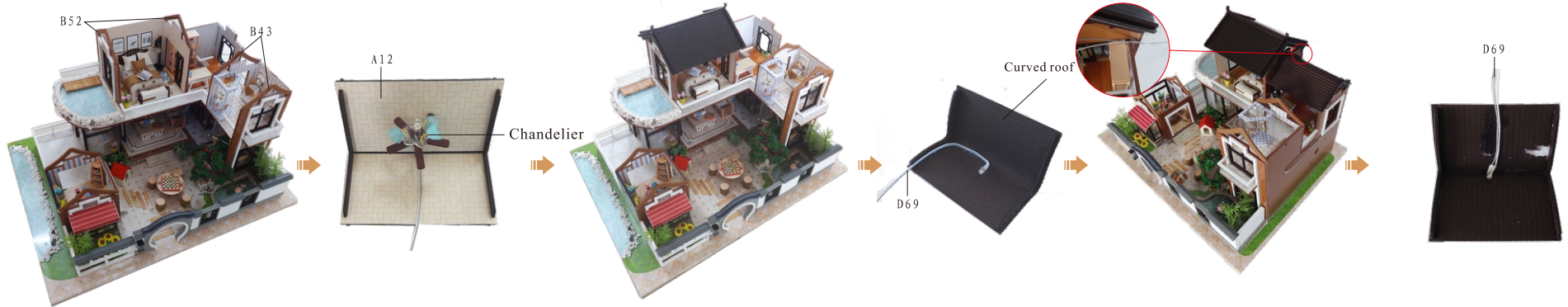

How to assemble the battery holder

Statement: the lamp wires cannot be inserted into the output socket.

-- Rechargeable batteries should be removed from the toy before charging
 -- Different types of batteries cannot mix; Do not mix new batteries in use with semi-used batteries.

-- Please notice the place of anode and cathode when pit in the batteries
 -- Rechargeable batteries are not blunt electricity
 -- Rechargeable batteries can only be charged under adult supervision

-- Run out of battery should be removed from the toy
 -- The power shall not be short circuit

The alignment of the wires



1. Trim all the LED wiring to the same length.

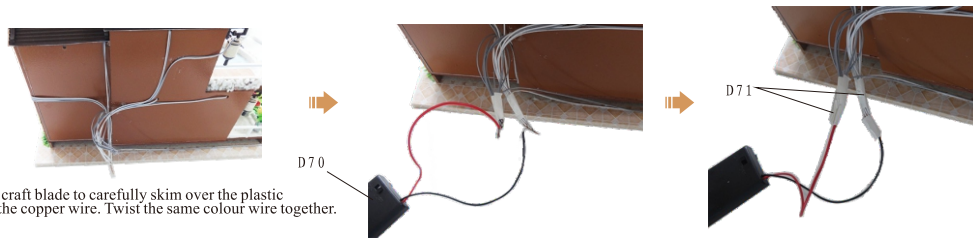

2. Use a craft blade to carefully skim over the plastic to bare the copper wire. Twist the same colour wire together.

3. Twist the following wire together:
 (I) BLACK wire from the battery box with the WHITE wire from LED bulb.
 (II) RED wire from the battery box with the GREY wire from LED bulb.

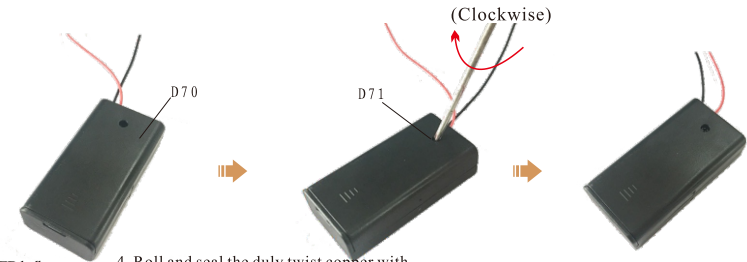

4. Roll and seal the duly twist copper with the white tape provided. Place the battery box in the allocated space.



Cut a small hole in the position shown.

(Refer to the same production method to make the plant A18-91)

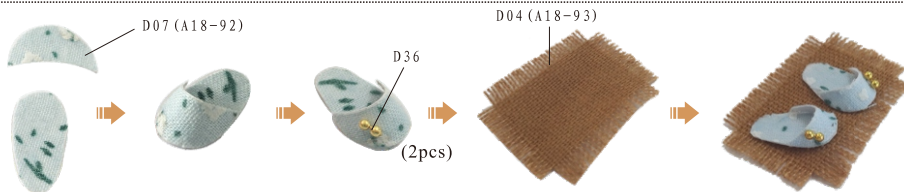

Attach D07 on A18-92 and cut it out, make the slippers according to above shown.

**Installation of dust proof cover
(For updated version, the parts need to be purchased separately)**



E04 Transparent cover
0.18*24*32 (1piece)



E05 Transparent cover
0.18*19*32 (2pieces)



E06 Transparent cover
0.18*19*23.64(2pieces)



1. Tear off kraft paper of each piece of transparent cover.

2. Paste E03, E04 and E05 together to complete the dust proof cover as shown.

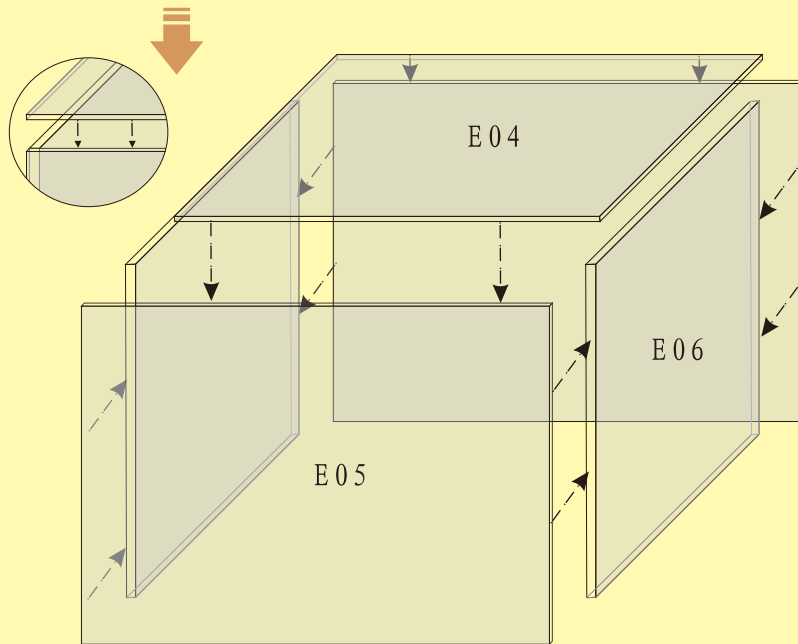

Photo of Dust proof cover



Photo Gallery





之
告

之
告

之
告

Attention: Please keep the instruction manual for future enquires after installation.