

L901

# DIY mini house kits – Love you all the way



L901 Instruction manual



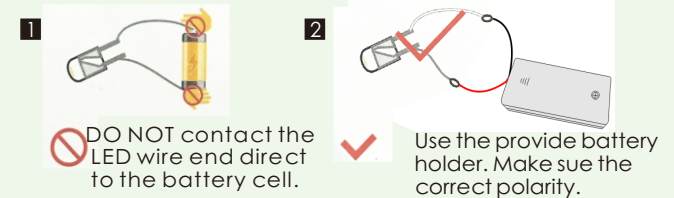
# NOTICE OF ASSEMBLE

## Tips for assembling

1. Pictures shown on the package may be slightly different from the actual product.
2. All the materials are taken in the operation step, put the remaining materials back into the original pocket until the installation is completed. (Avoid material loss during installation)
3. The dimensions indicated in the step diagram are "cm".
4. If there have template paper material, please cut the material according to the template to avoid mistakes..
5. According to the part rule example at the bottom of this page, refer to the part on the part number drawing, find the material object and compare with the material list, confirm and install. (Wooden parts only)
6. Glue should not be applied too much, so as not to dry longer, overflow will affect the effect of the finished product.
7. Part shapes may differ from the photographs depending on the production batch

## Testing on LED function

Be sure to test the LED lights before making the lighting, note that the LED white wire to the negative, gray wire to the positive reference to the following figure operation test.



## Product comes with tool:

1



**White glue:**  
It dries slowly and can paste materials firmly without trace. Can be used to paste wallpaper and printed paper.

2



**Ruler:**  
For measuring materials to identify the number of materials so as to enhance work efficiency.

3



**Scissors:**  
Can be used to cut printed paper, cloth, etc.

4



**Cutter knife:**  
For peeling off power wire skin and cutting off materials.

5



**Alcohol gel:**  
It dries fast and can paste materials firmly, but may leave some trace. Can be used to paste small metal materials and small components of furniture.

6



**Tweezers:**  
For holding small materials and rolling up iron wire.

7



**Screw Driver:**  
For fixing screws, mostly can be used to install doors and music components.

1



**Drill:**  
Can be used to drill holes in timbers, roll up hard iron wire or fix screws.

2



**Needle-nose pliers:**  
For cutting, bending wire, folding harder material

## Bring your own tools:

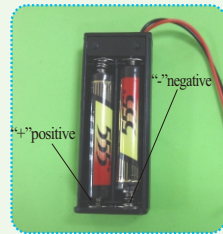
## How to assemble the battery holder



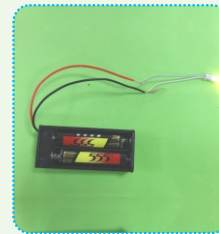
1. Material and tools needed:  
- Battery holder, LED bulb, tape, screw driver and 2 piece AA size battery (not provided)



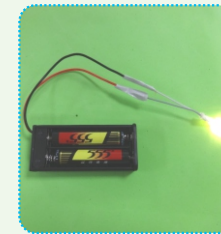
2. Use screw driver and take the lid off from the battery holder.



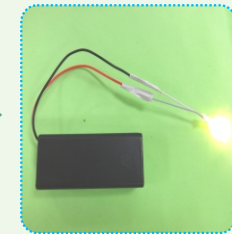
3. Insert the battery take notes on the polarity.



4. Connect the red wire to grey wire. Connect the black wire to white wire.



5. Wrap the exposed wire with the tapes.



6. Place the box lid and fastness with screw driver.

## Example of parts rule:

A01: The parts are directly in the box.; B01: parts in bag B; C01: part in bag C, and so on.

(Note: display the printing paper A32-01 in the step: the printing paper is placed directly in the box, part number is A32-01)

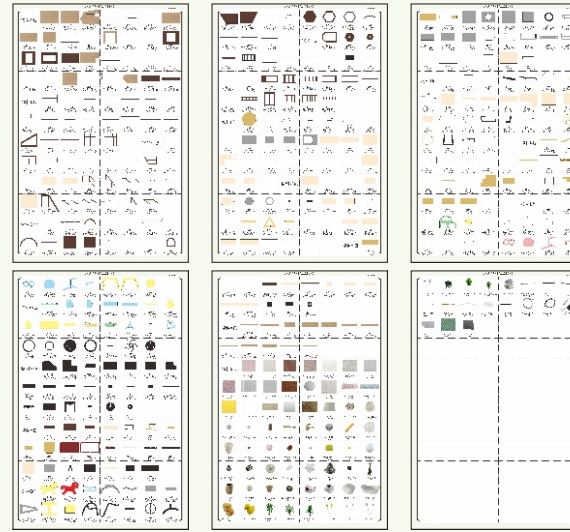


## details of miniature kit

| Name                  | Material package   |
|-----------------------|--|
| printing paper        | Bag A-A32(All printing and template papers are shown on A25paper, total 4pieces of A2) |
| dining table          | F bag + printing paper+template paper  |
| sunflower             | S bag+template paper   |
| microwave oven        | F bag+S bag+printing paper   |
| cabinet               | F bag+G bag+S bag+ printing paper  |
| closet                | G bag+S bag+ printing paper  |
| cooker hood           | G bag+printing paper   |
| kitchen chandelier    | G bag+S bag  |
| bookcase              | G bag+ printing paper  |
| cabinet               | H bag+S bag+ printing paper  |
| washing machine       | H bag+S bag+printing paper   |
| bathroom shelf        | H bag+S bag+ printing paper  |
| towel rack            | H bag+S bag  |
| bath cabinet          | H bag+S bag+ printing paper  |
| long chair            | J bag+S bag+printing paper   |
| bedside lamp          | J bag+S bag  |
| bed                   | J bag+S bag+ template paper  |
| sofa                  | J bag+S bag+ template paper  |
| tea table             | J bag+S bag+template paper+printing paper  |
| floor lamp            | J bag +S bag+printing paper  |
| double bed            | K bag+S bag+ template paper  |
| toy cart              | L bag+S bag+printing paper   |
| wooden horse          | L bag  |
| table and chair       | J bag+S bag+template paper+printing paper  |
| storage cabinet       | M bag+S bag  |
| helicopter chandelier | M bag+S bag  |
| aircraft chandelier   | M bag+S bag  |
| double chandelier     | M bag+S bag  |
| piano                 | N bag+ printing paper  |
| street lamp           | N bag+S bag+printing paper   |
| closet                | P bag+S bag  |
| table                 | P bag+S bag+ printing paper  |
| table tennis table    | P bag+S bag+ printing paper  |
| chandelier            | P bag+S bag  |

|                            |  |
|----------------------------|--|
| plant                      | S bag  |
| single sofa                | P bag+S bag+ template paper+printing paper                         |
| projection screen          | P bag+ printing paper  |
| rocking chair              | P bag+S bag  |
| slipper                    | S bag+template paper   |
| slide                      | Q bag+S bag+ printing paper  |
| outdoor lamp               | Q bag+S bag+printing paper+template paper                          |
| outdoor table and chair    | Q bag+S bag+printing paper+template paper                          |
| bathtub                    | H bag+S bag+printing paper+template paper                          |
| bar chandelier             | P bag+S bag  |
| bedroom chandelier         | M bag+S bag  |
| chandelier                 | S bag  |
| refrigerator               | F bag+printing paper   |
| big sunflower              | S bag+ template paper  |
| flower nursery             | Q bag+S bag+printing paper+template paper                          |
| swimming pool              | R bag+printing paper+template paper                                |
| curtain                    | G bag+S bag+template paper   |
| first floor stairs         | C bag+ printing paper  |
| stairs on the second floor | C bag+ printing paper  |
| third floor stairs         | C bag+printing paper   |
| castle                     | D bag+E bag+S bag  |
| outer frame                | A bag+B bag+C bag+D bag+E bag+S bag +template paper+printing paper |
| battery holder             | S bag  |

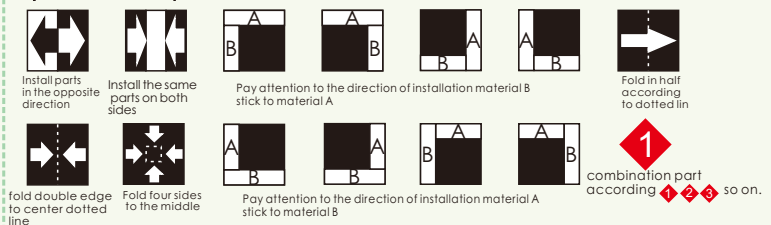
## Thumbnail of material list (reference only)



## Thumbnail of printing paper & template paper (reference only)



## Symbol description used





Cut out the material S01, S10 and S19 according to the template paper before making.

**Dining table**

S10 (dining chair cushion) S01 (dining chair cushion) S19 (dining chair cushion) S01 (dining chair back) S01 (dining chair back) (4pieces)

(turn it)

Cut the cloth at the position on the drawing, and then wrap the cushion. Glue them together.

F02 F03 F03 F03 F01  
F04 F04 F04 F04  
F05 F05 F05 F05  
F06 F06 F06 F06

F05 F04 F06 F03 F03 F03

Cut out the material S11 and S16 according to the template paper before making.

**Sunflower**

S16 (sunflower) S11 (sunflower) S23 S23 A32-1 A32-1 S30 S30 S32 S32 S32 S53 S53

S72:1.8cm S72:1.8cm S72:1.8cm S72:1.8cm S72:1.8cm S72:1.8cm

cut out 0.1 cm with a knife S30:0.1 cm (12pieces) S22 S22 S22 (3pieces)

**Microwave Oven**

F08 F08 F08 F12 A32-2-2 (turn it) A32-2-1 F10 F11 F09 F09 F10 F10 F09 F11

0.2cm 0.2cm 1.2cm S70:1.4cm

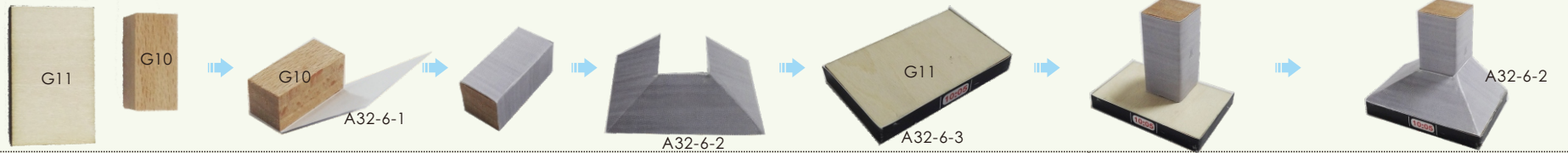
F08 F08 F07 F08 A32-3 (8pieces)



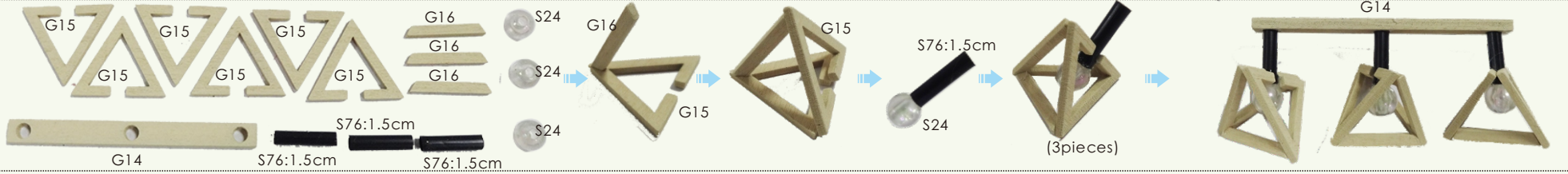




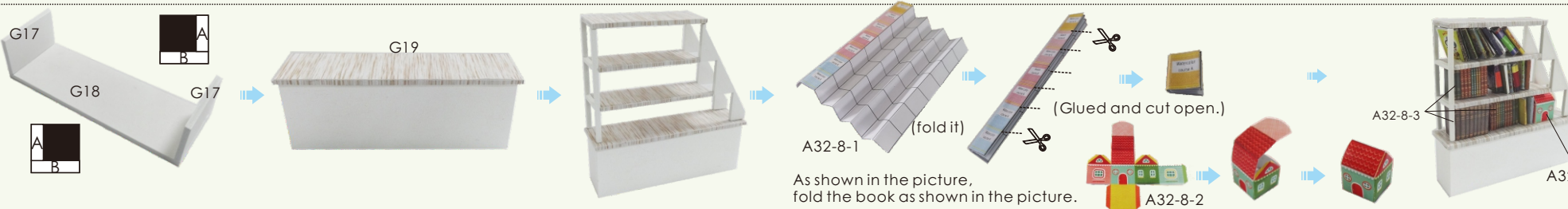
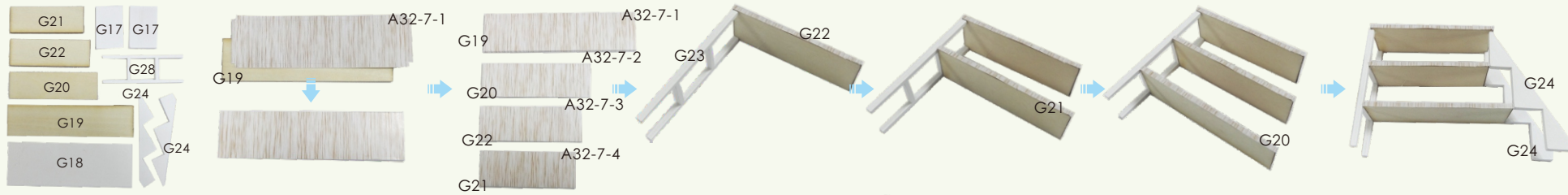
Cooker hood



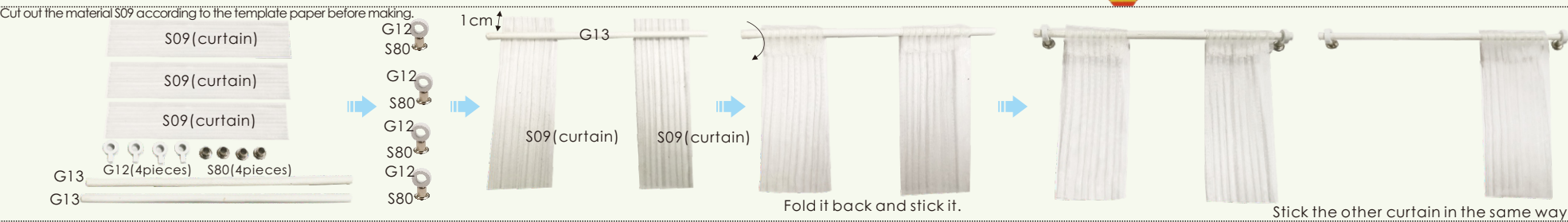
Kitchen Chandelier



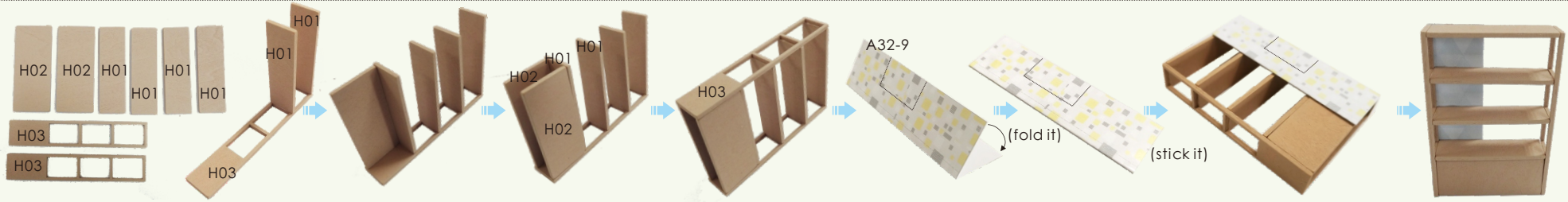
Bookcase



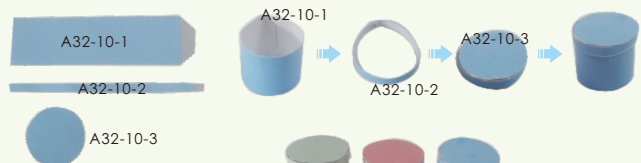
Curtain



Cabinet







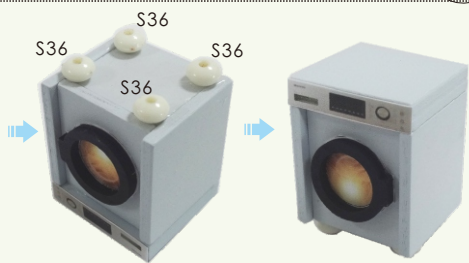
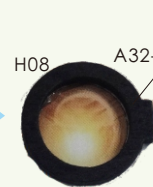
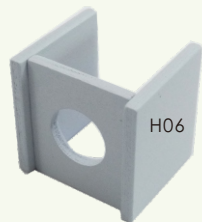
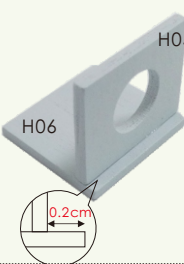
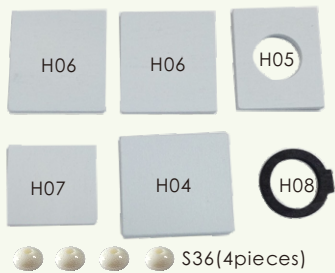
Make the other 2 boxes in the same way.



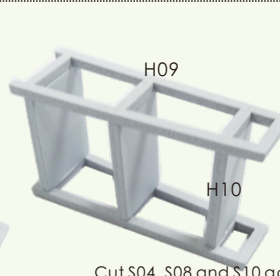
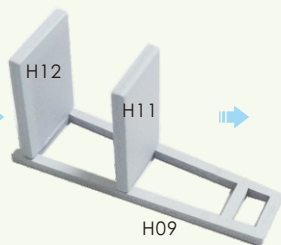
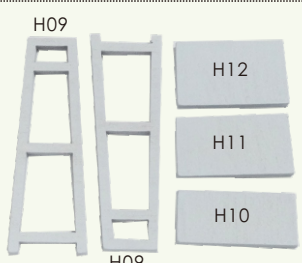
A32-12



Washing machine

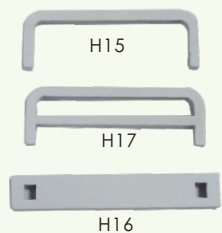


bathroom shelf

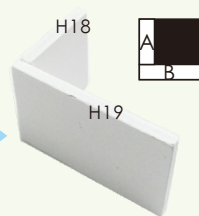
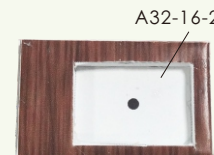
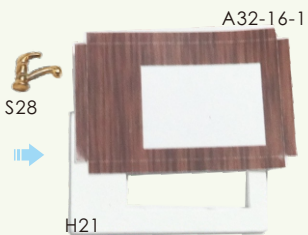
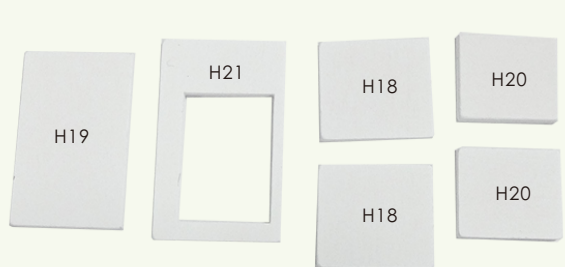


Cut S04, S08 and S10 according to the template and fold them in half on the shelf.

Towel Rack



Bath cabinet





Note: the back of the cabinet is aligned

Cut S21 out according to the mirror template and stick it to H22.

Bath tub



Cut out the material S08 according to the template paper before making.

Bed

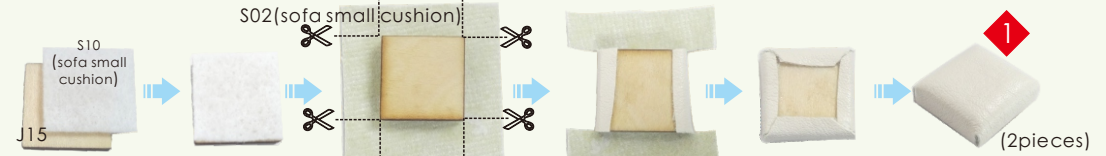
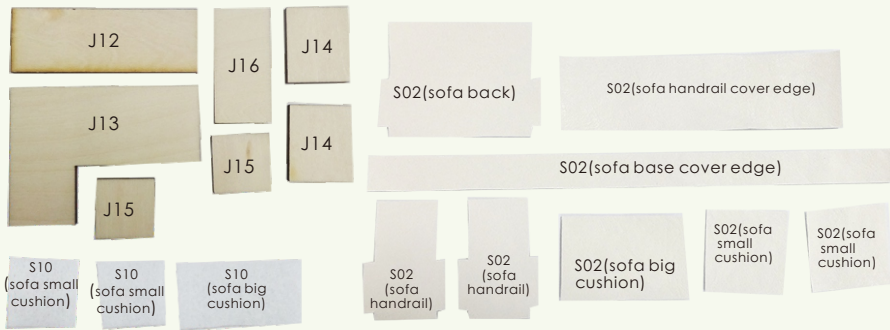


Cut the cloth according to the position on the drawing, and then put the bed back.

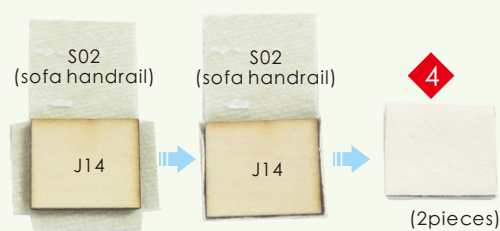
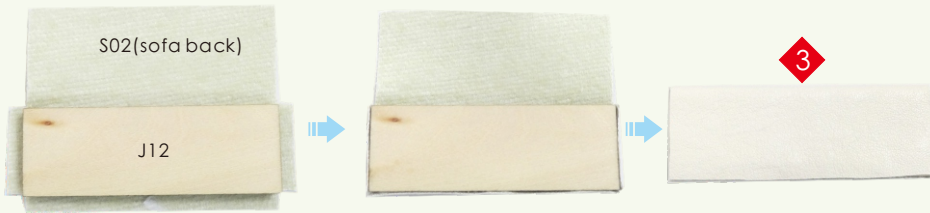
Refer to the next page for the pillow.



Sofa



Cut the cloth according to the position on the picture, and then wrap up the big cushion of the sofa.

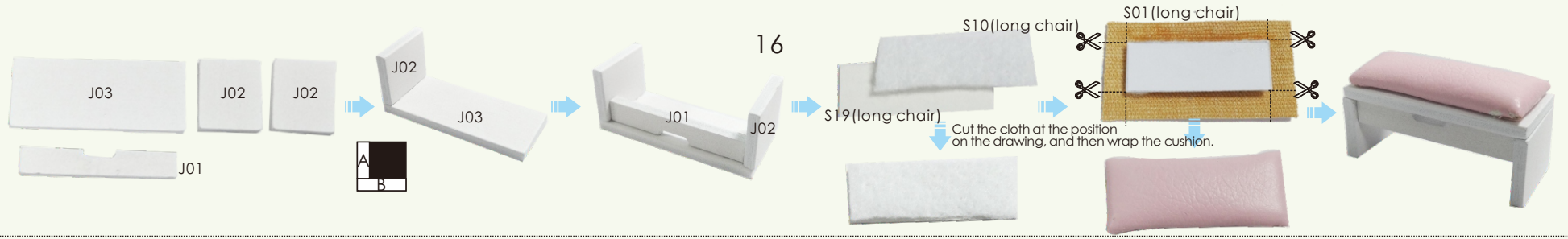


Cut the cloth according to the position on the drawing, and then wrap the sofa base.

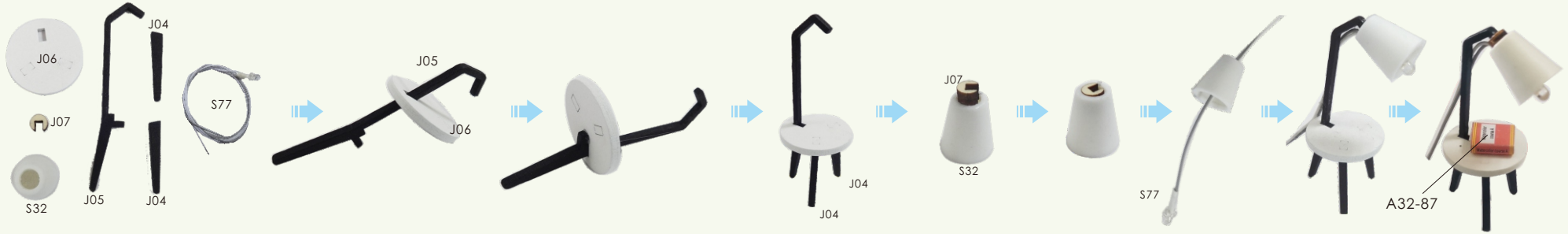


Make 4 white linen pillows, 5 pink linen pillows and 2 floral linen pillows as shown.

Long chair



Bedside Lamp



Tea table

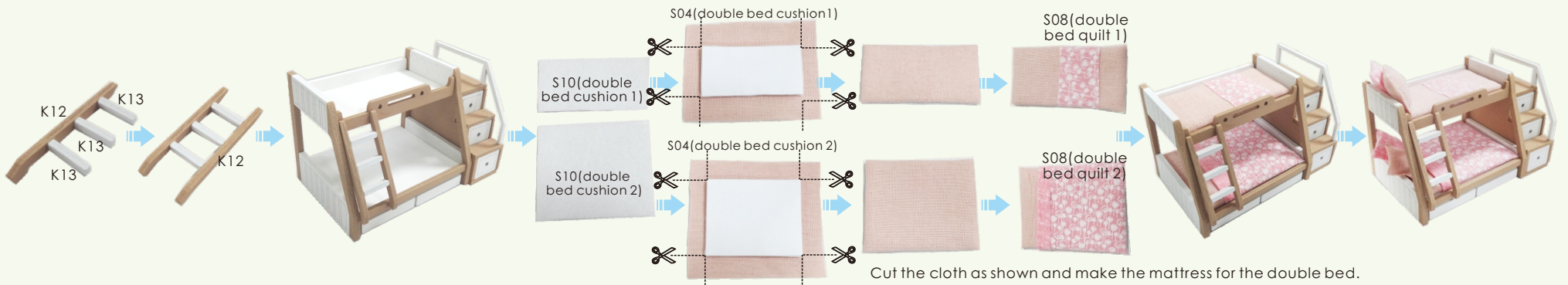
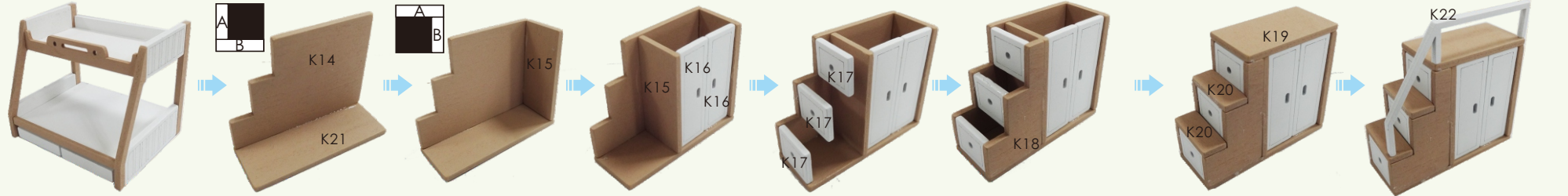
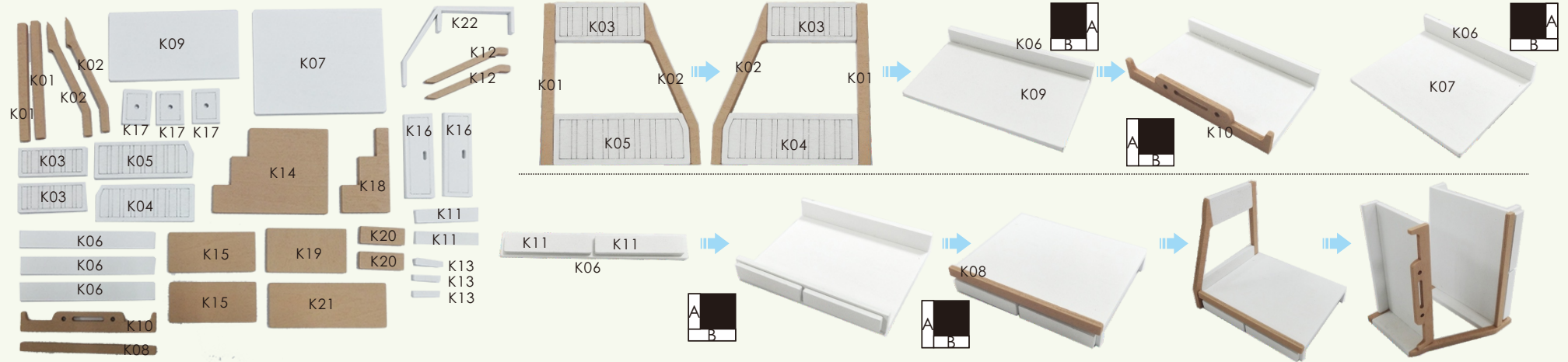


Floor Lamp

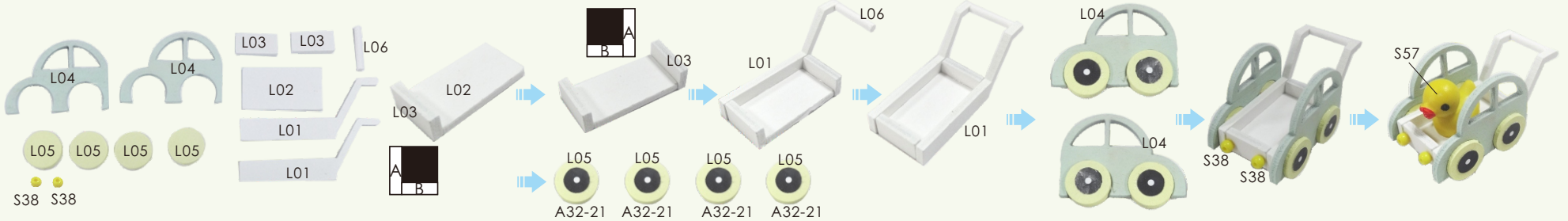




Double bed



Toy cart



Wooden horse

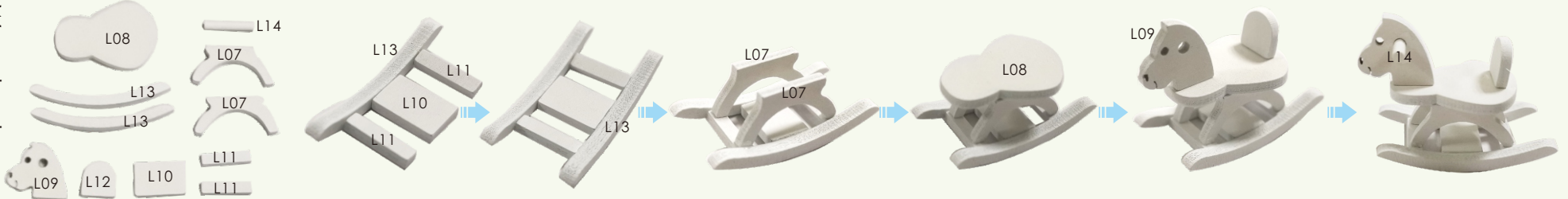
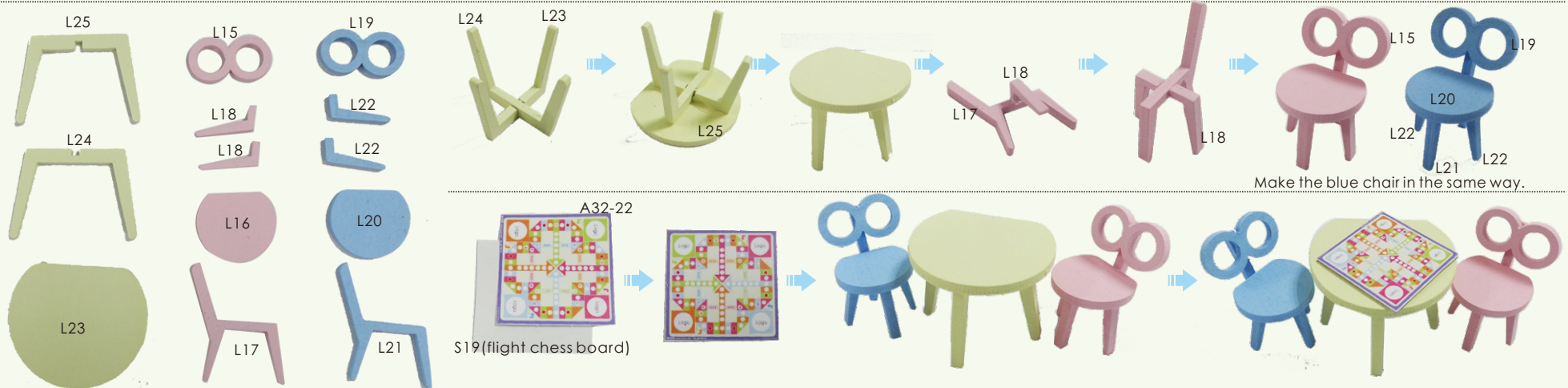
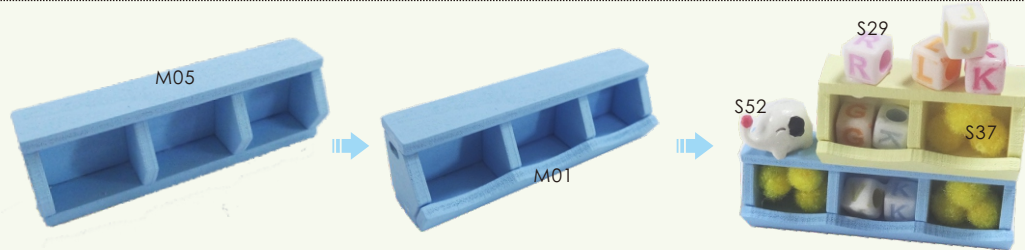
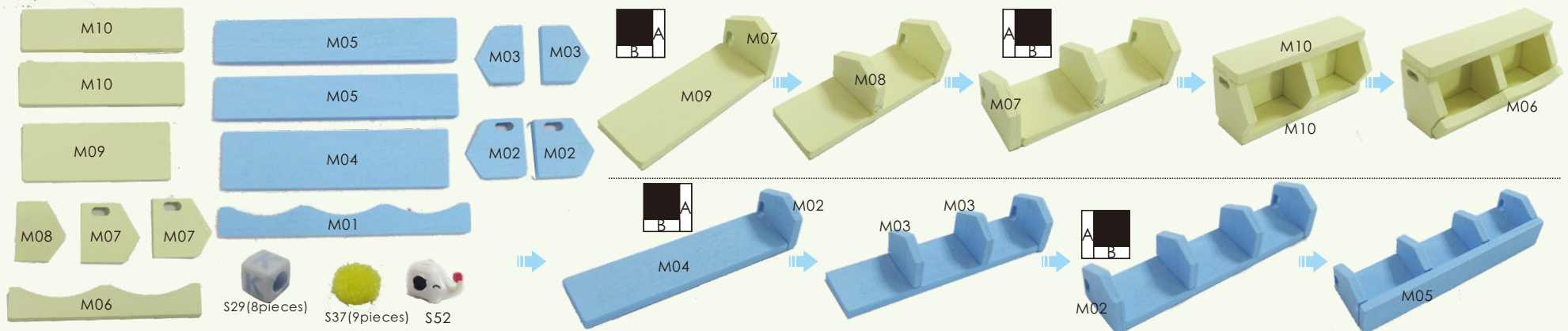


Table and Chair



Storage cabinet

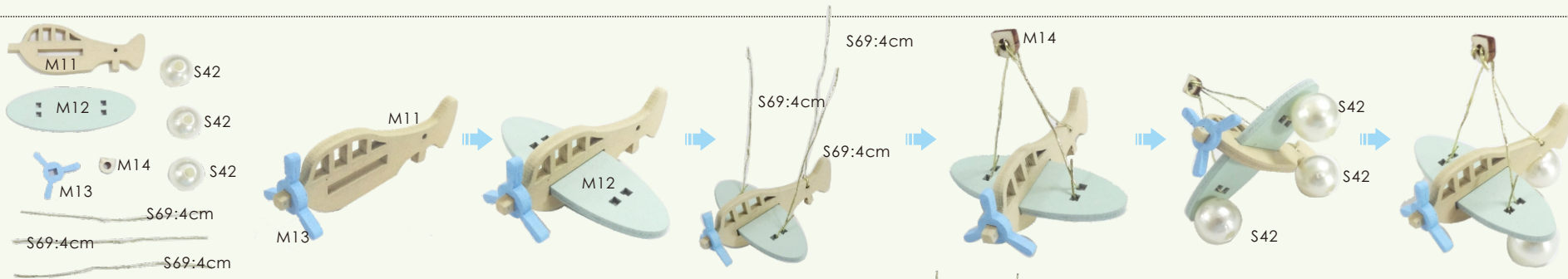


Helicopter Chandelier





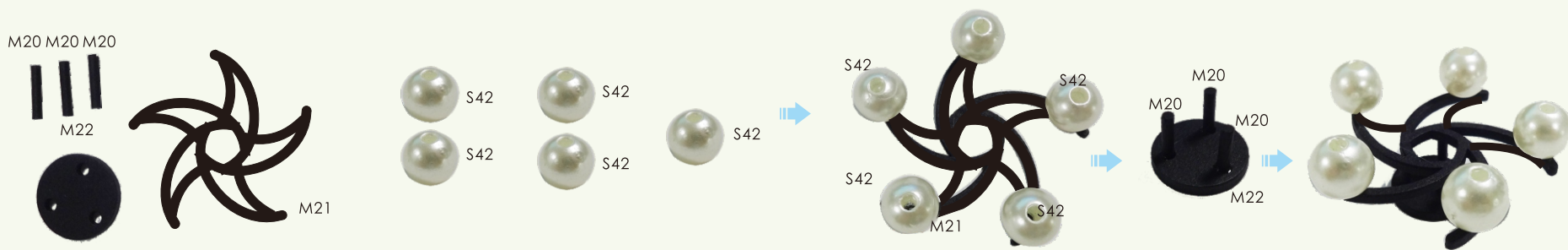
Aircraft Chandelier



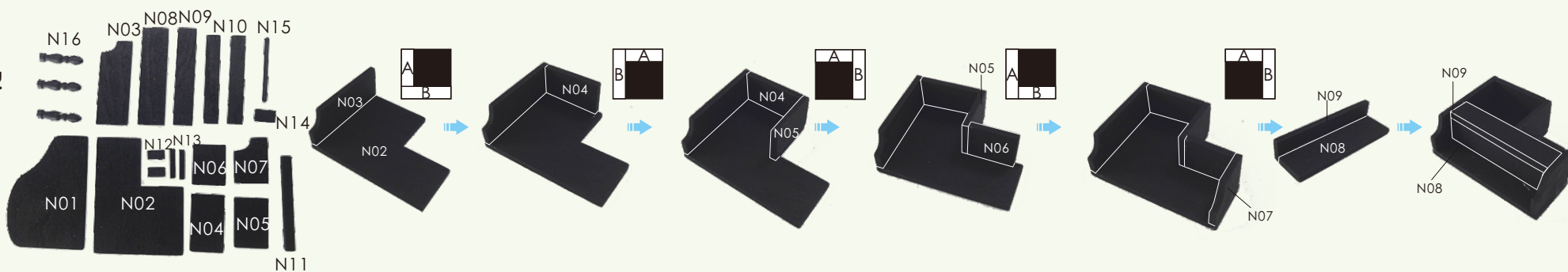
Double Chandelier



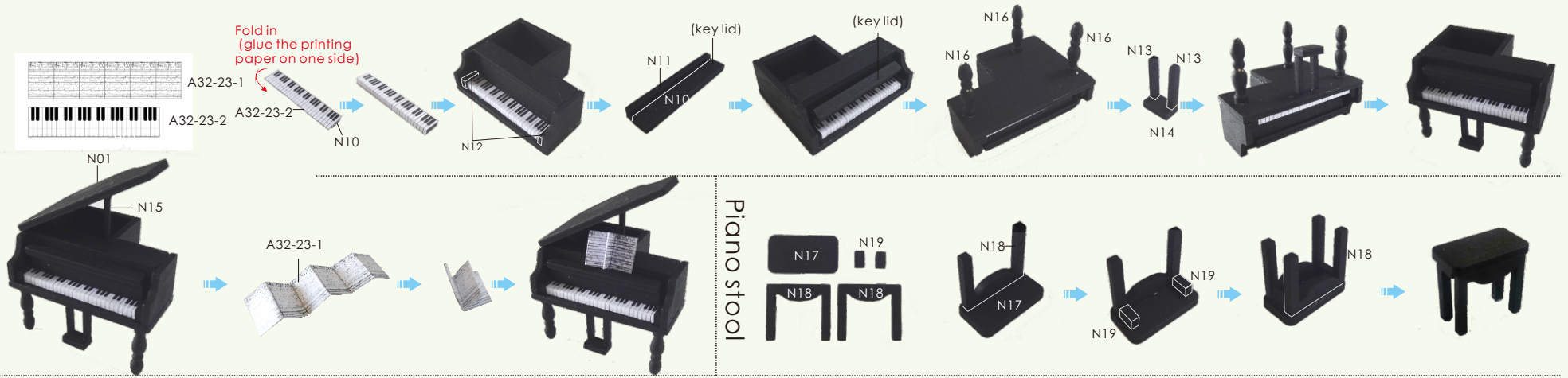
Bedroom Chandelier



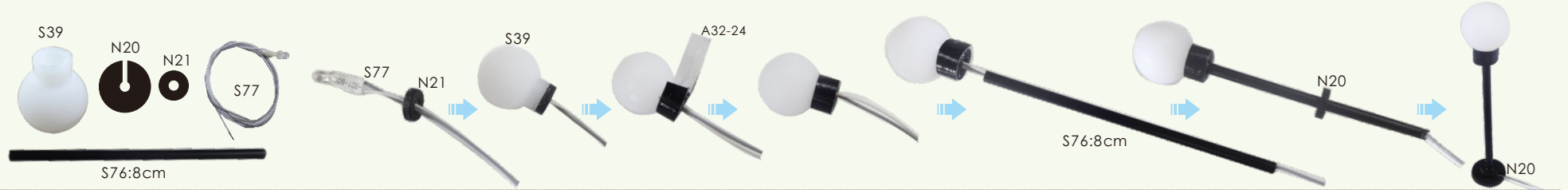
Piano



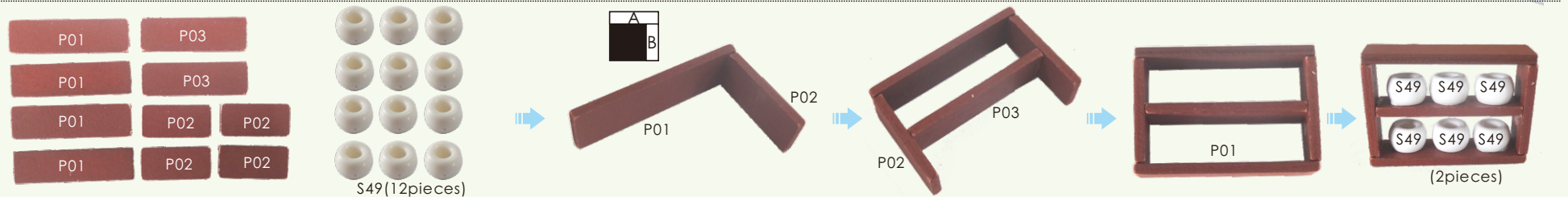
Piano



Street lamp



Closet



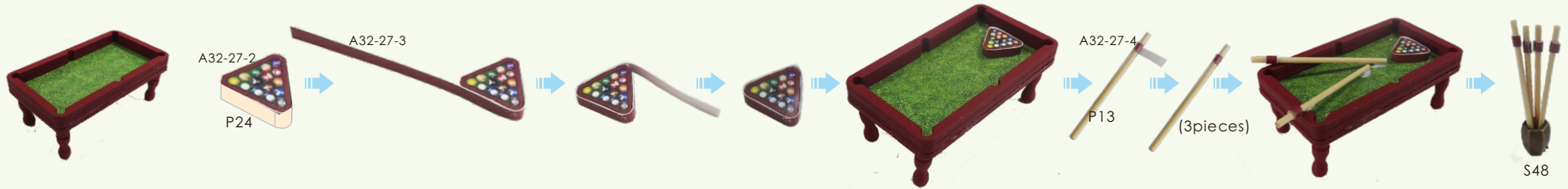
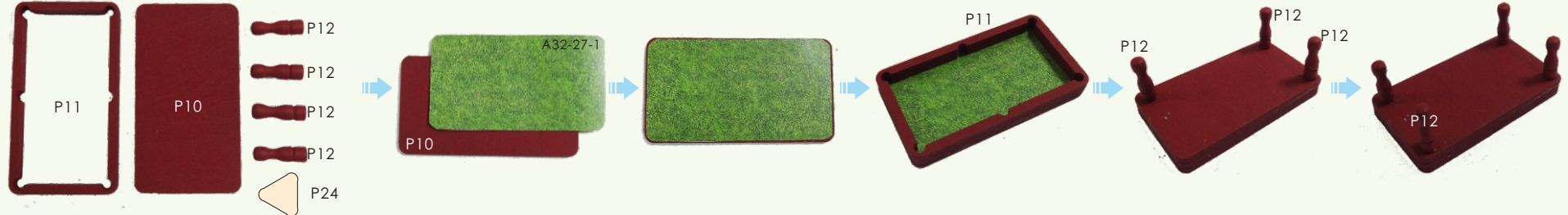
Table



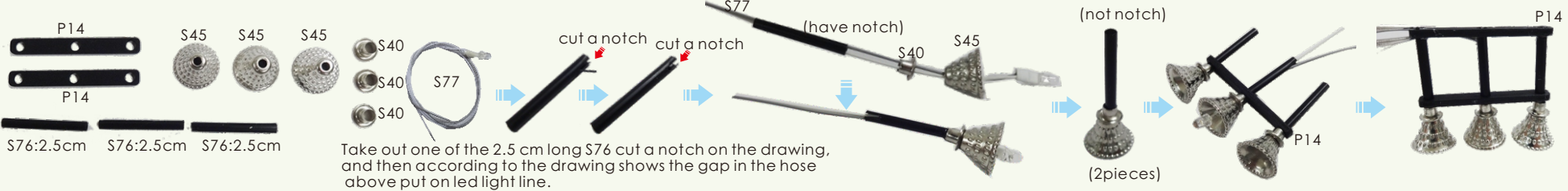




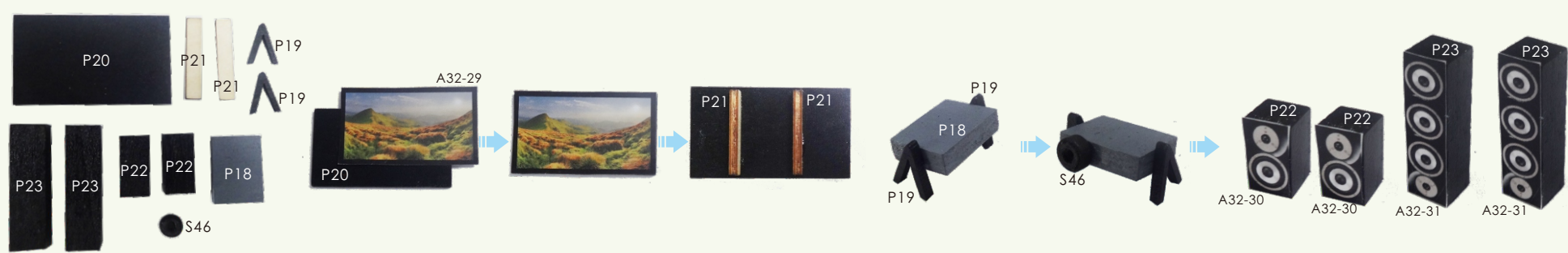
Table Tennis Table



Chandelier



Projection screen



Single Sofa

Cut out the material S03 and S10 according to the template paper before making.

S03(single sofa back 1)  
S03(single sofa back 2)  
S03(single sofa cover edge)  
S03(single sofa cover edge)  
S36(4pieces)  
S10 (single sofa back)  
S10 (single sofa cushion 2)  
P16  
S03 (single sofa cushion 1)  
Cut the cloth at the position on the drawing, and then make the cushion.

S03(single sofa cover edge)  
P16  
S03(single sofa cushion)  
S10 (single sofa cushion)  
Cut out the cloth according to the position on the drawing, and then make the base.

S10 (single sofa cushion 1)  
P17  
S03 (single sofa cushion 2)  
Cut the cloth at the position on the drawing, and then make the cushion.

S03(single sofa cover edge)  
P17  
Cut out the cloth according to the position on the drawing, and then make the base.

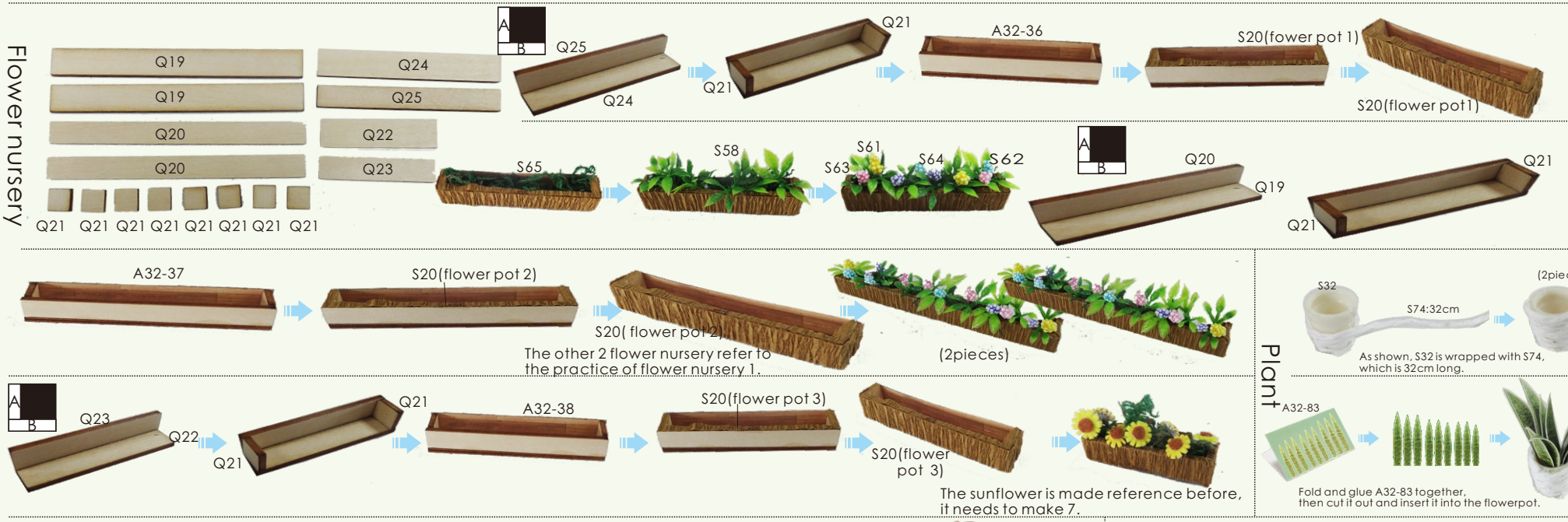
S03(single sofa back 1)  
S10 (single sofa back)  
S03(single sofa back 2)  
A32-28

Glue the parts 10 and 11 together as shown.

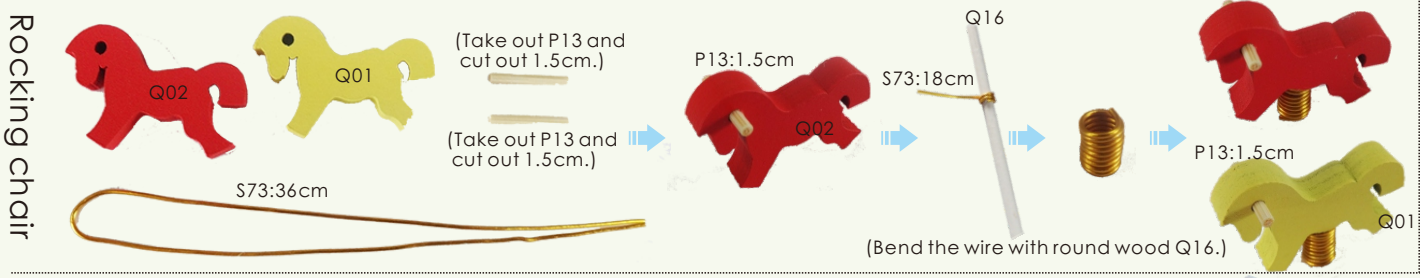
S36 S36  
S36 S36



Flower nursery



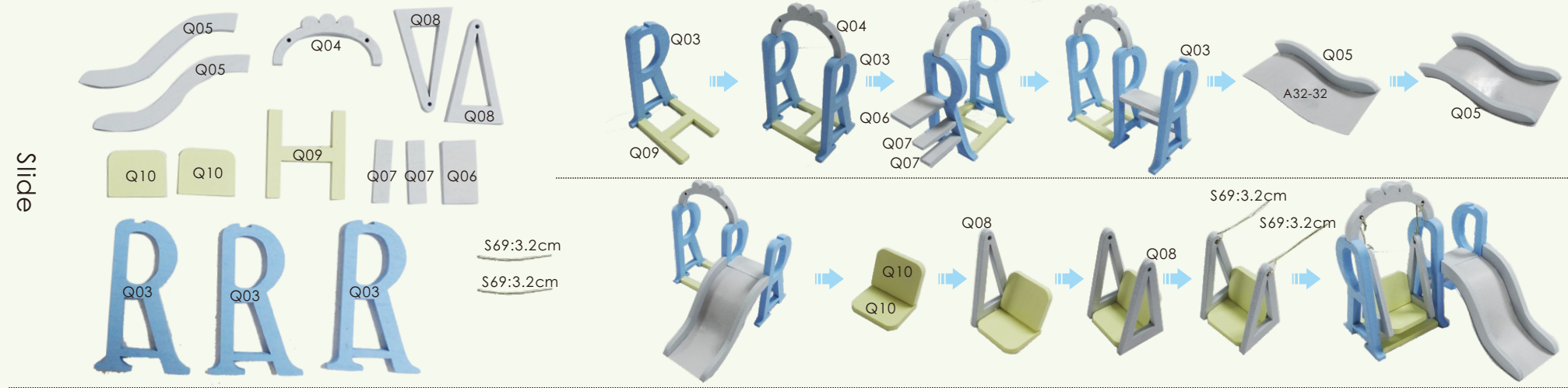
Rocking chair



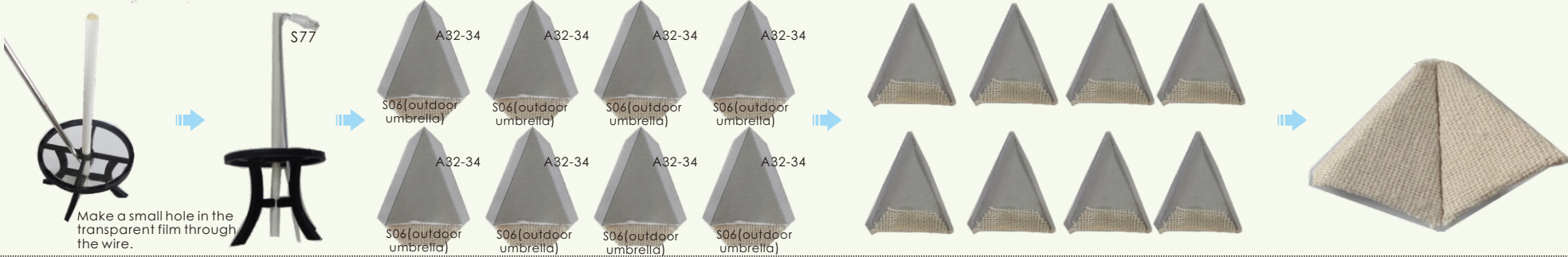
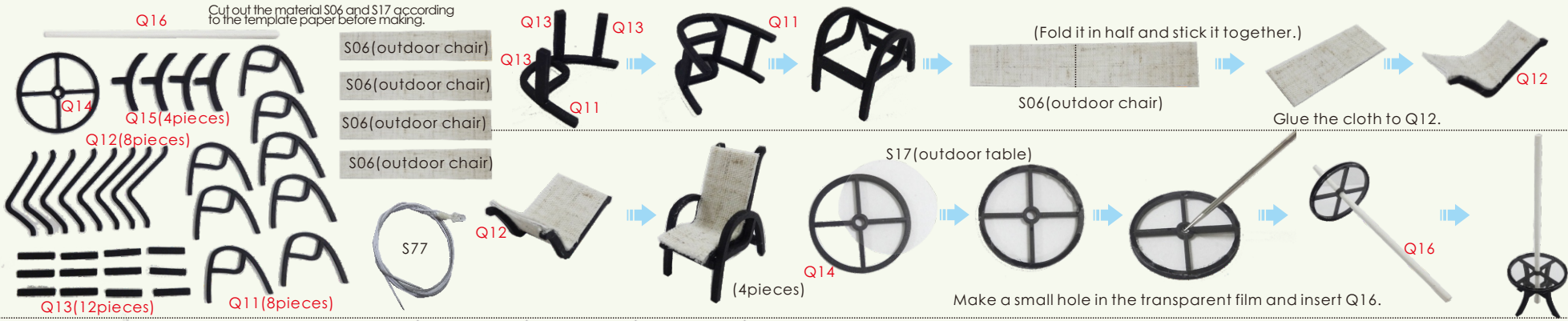
Slipper



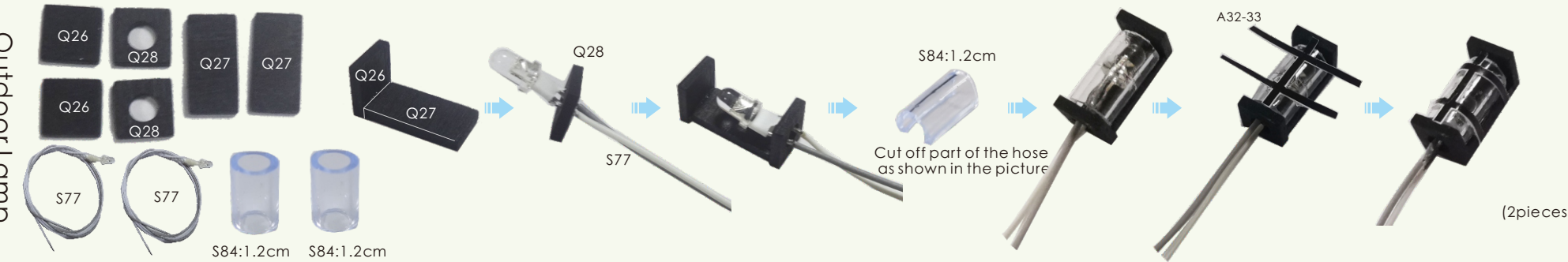
Slide



Outdoor table and chairs



Outdoor Lamp



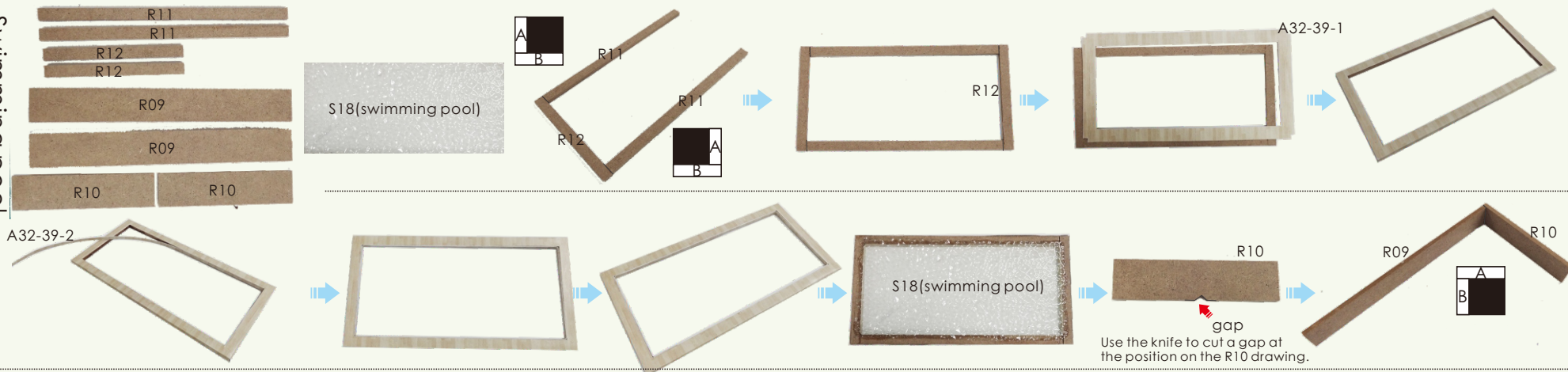
(Note: use a long LED light line)



Bar Chandelier



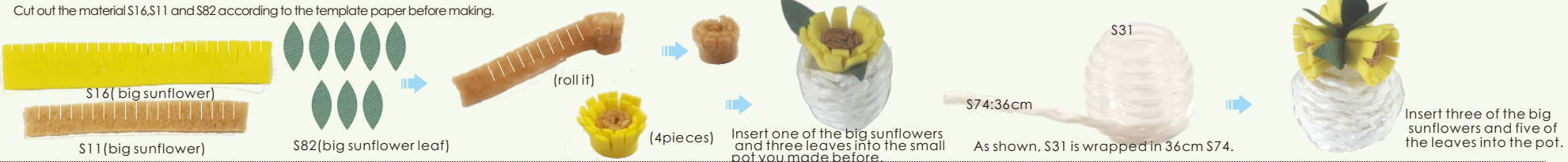
Swimming pool



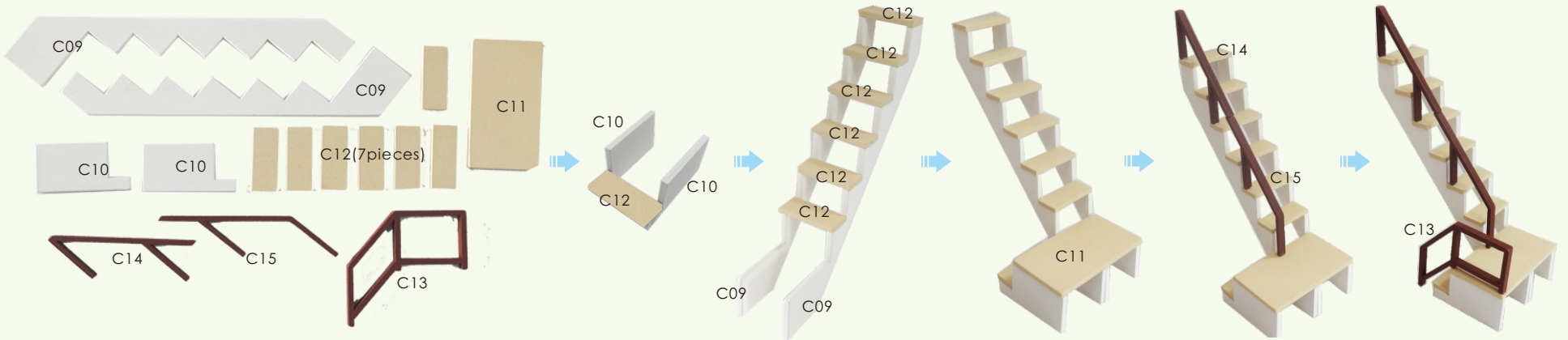
Chandelier



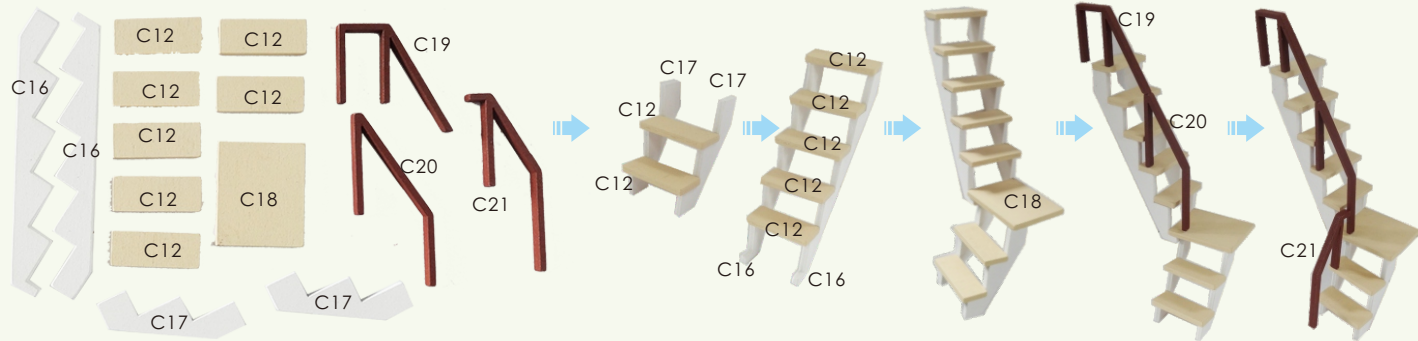
Big sunflower



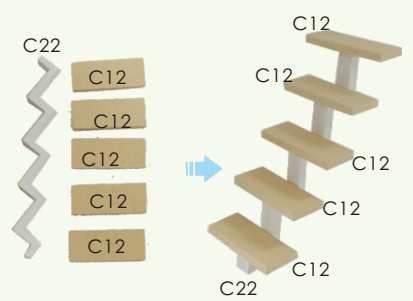
First Floor Stairs



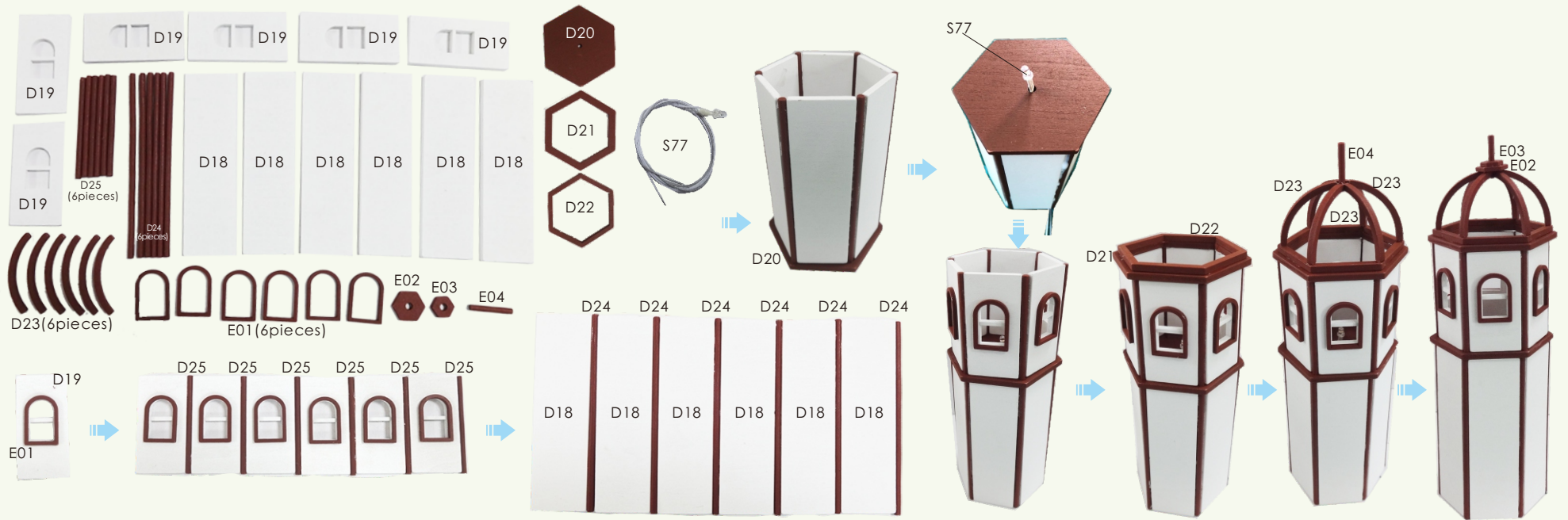
Stairs on the second floor



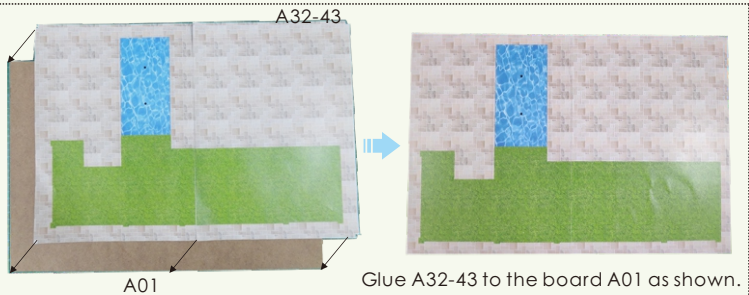
Third Floor Stairs



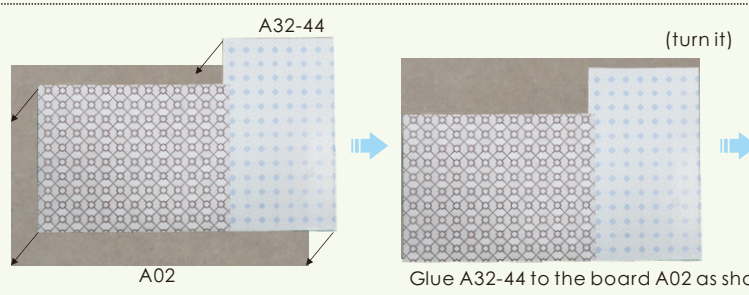
Castle



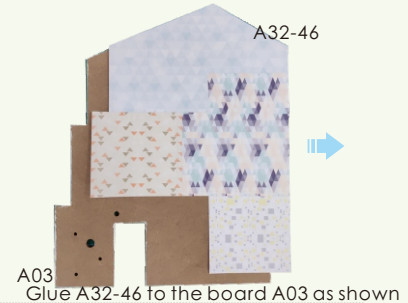
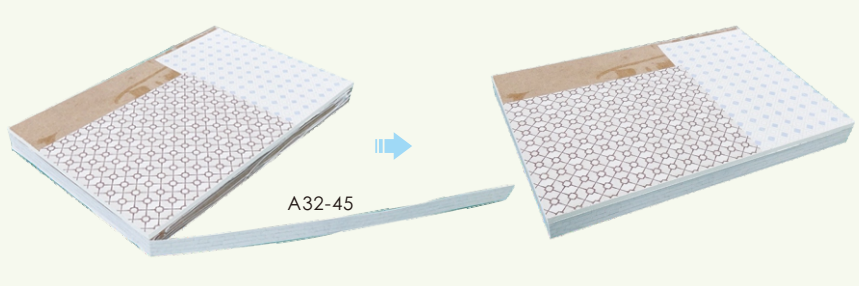
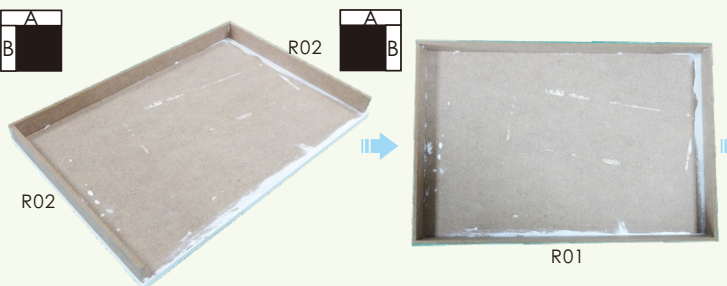




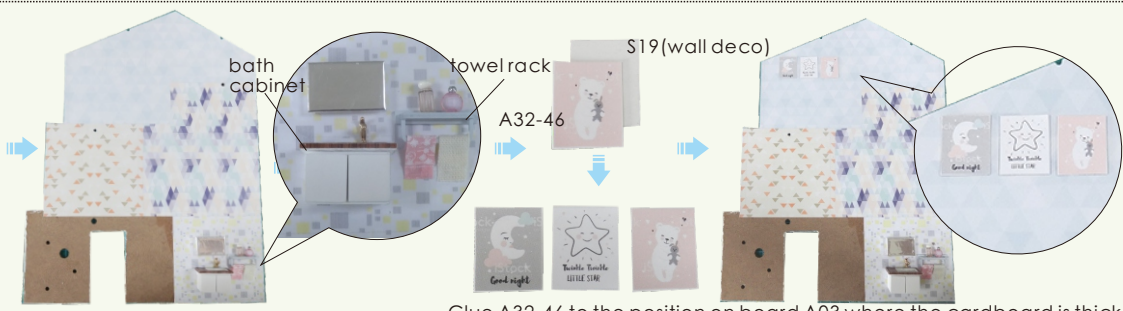
Glue A32-43 to the board A01 as shown.



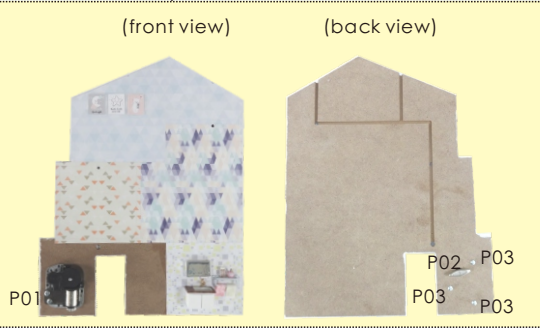
Glue A32-44 to the board A02 as shown.



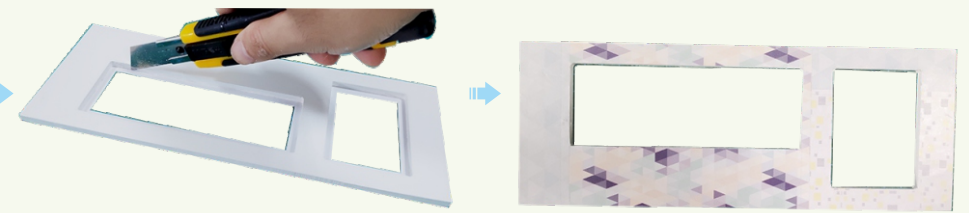
Glue A32-46 to the board A03 as shown



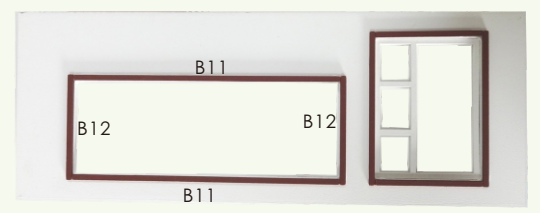
Glue A32-46 to the position on board A03 where the cardboard is thick.

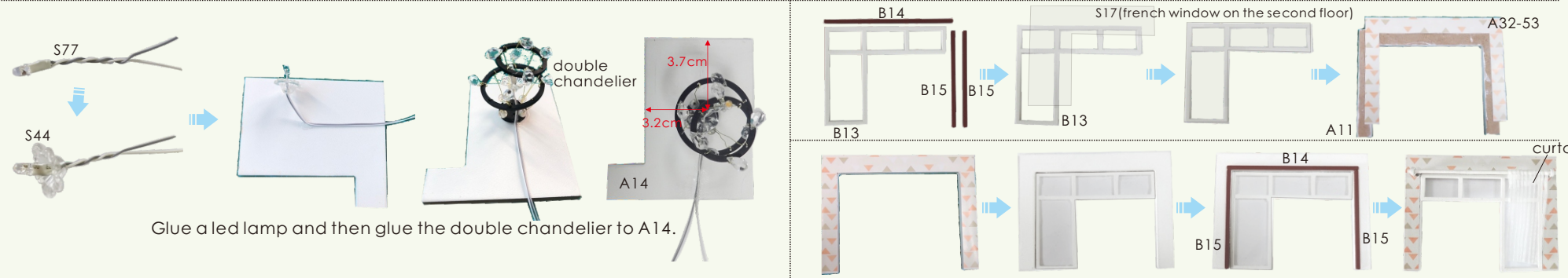
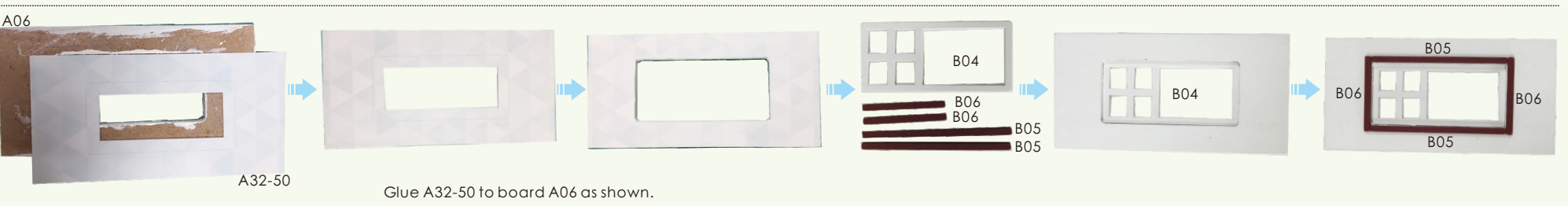
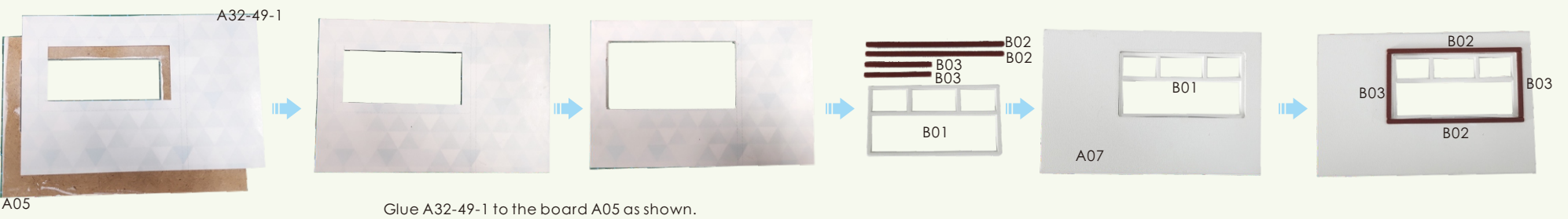
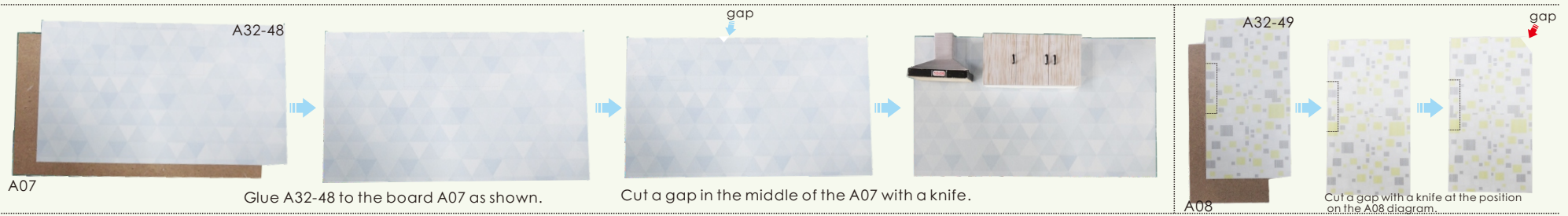


Glue A32-47 to the board A04 as shown.

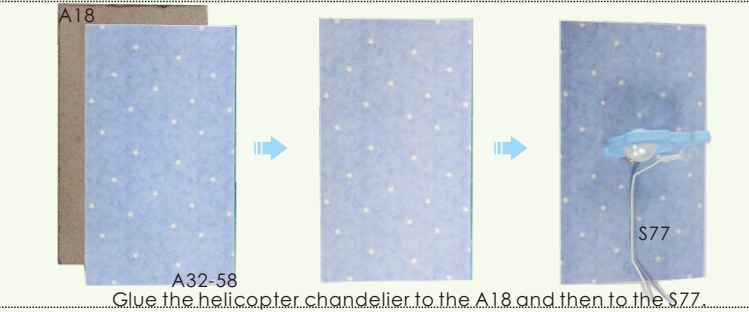
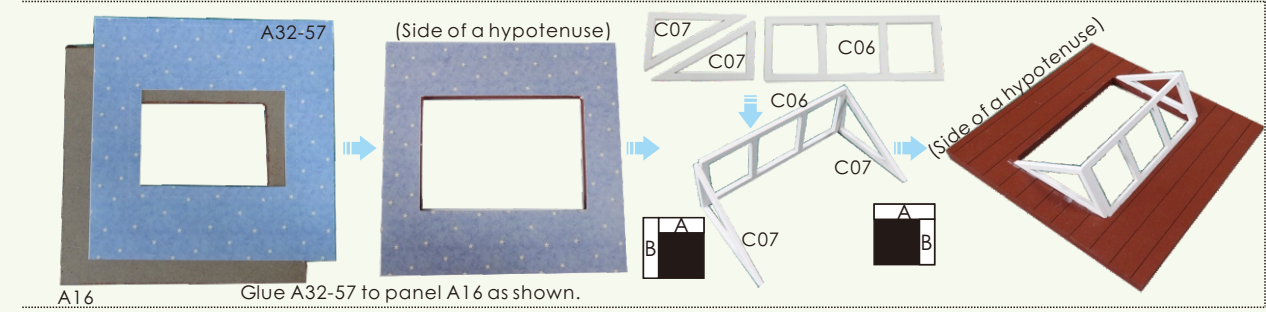
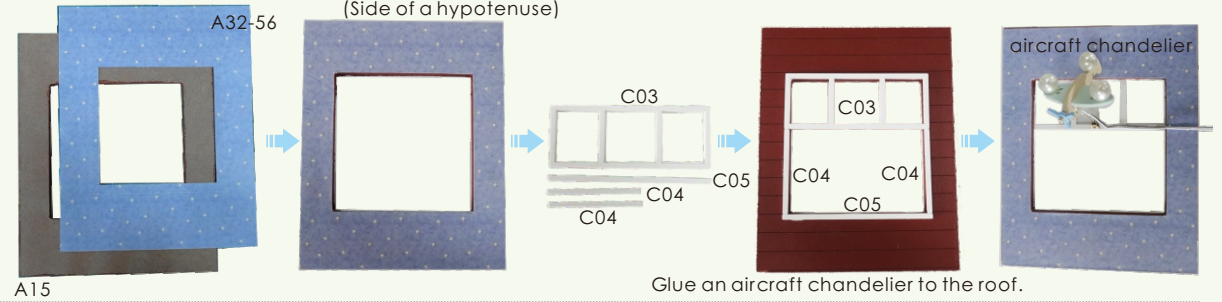
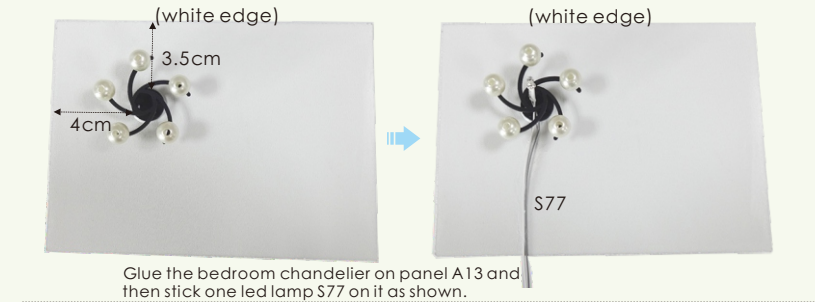
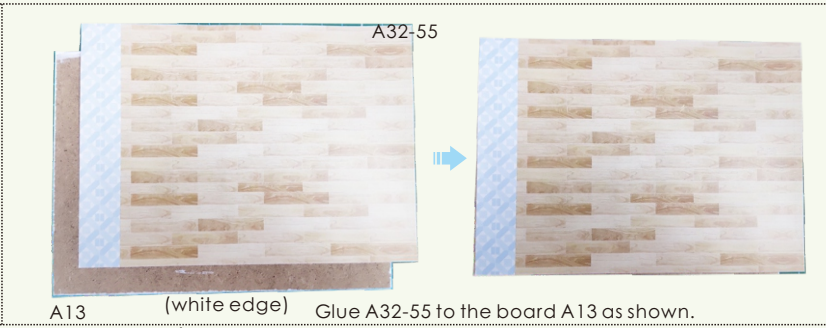


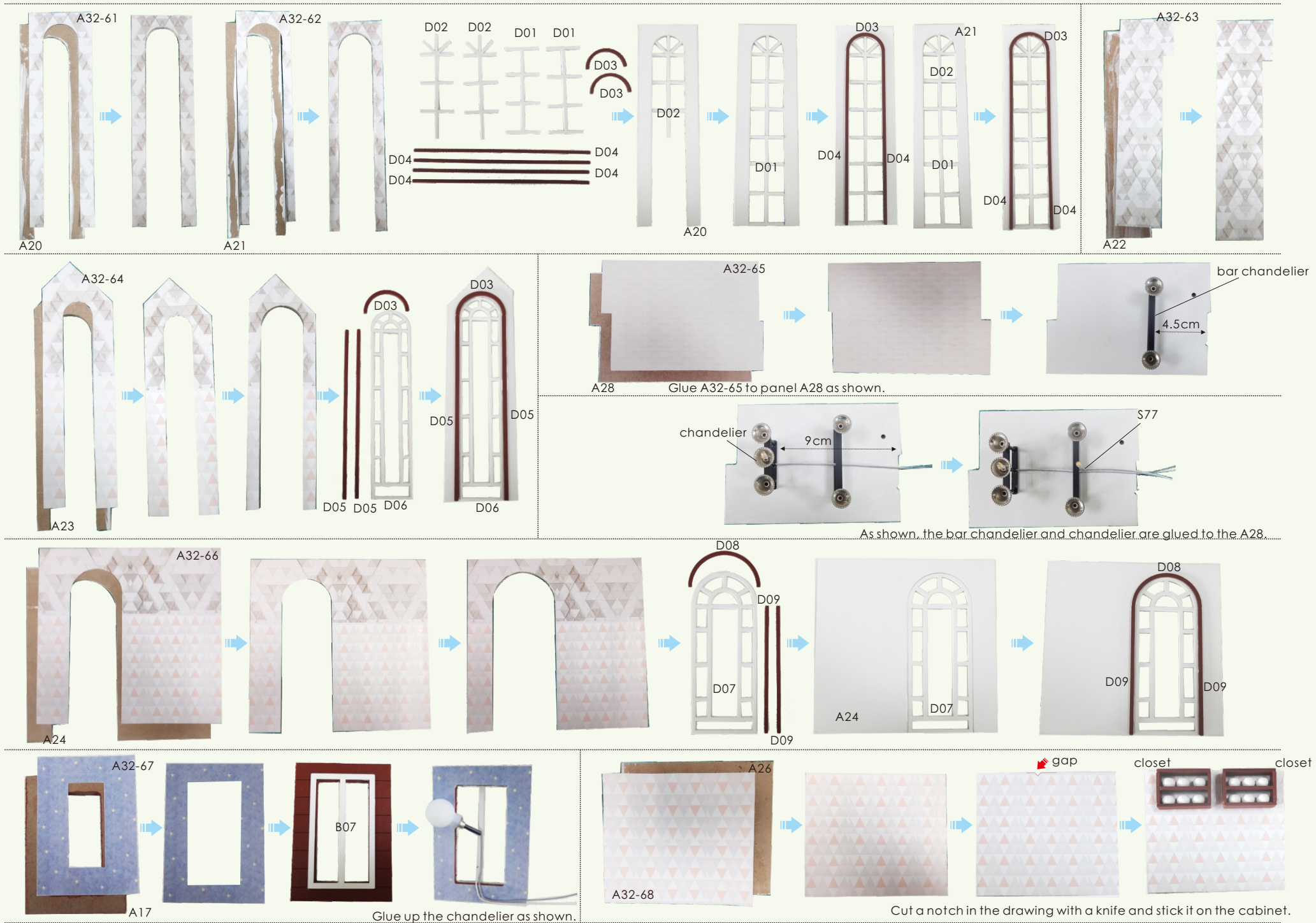
Use a knife to cut off the excess printing paper, and then deal with it in the same way.



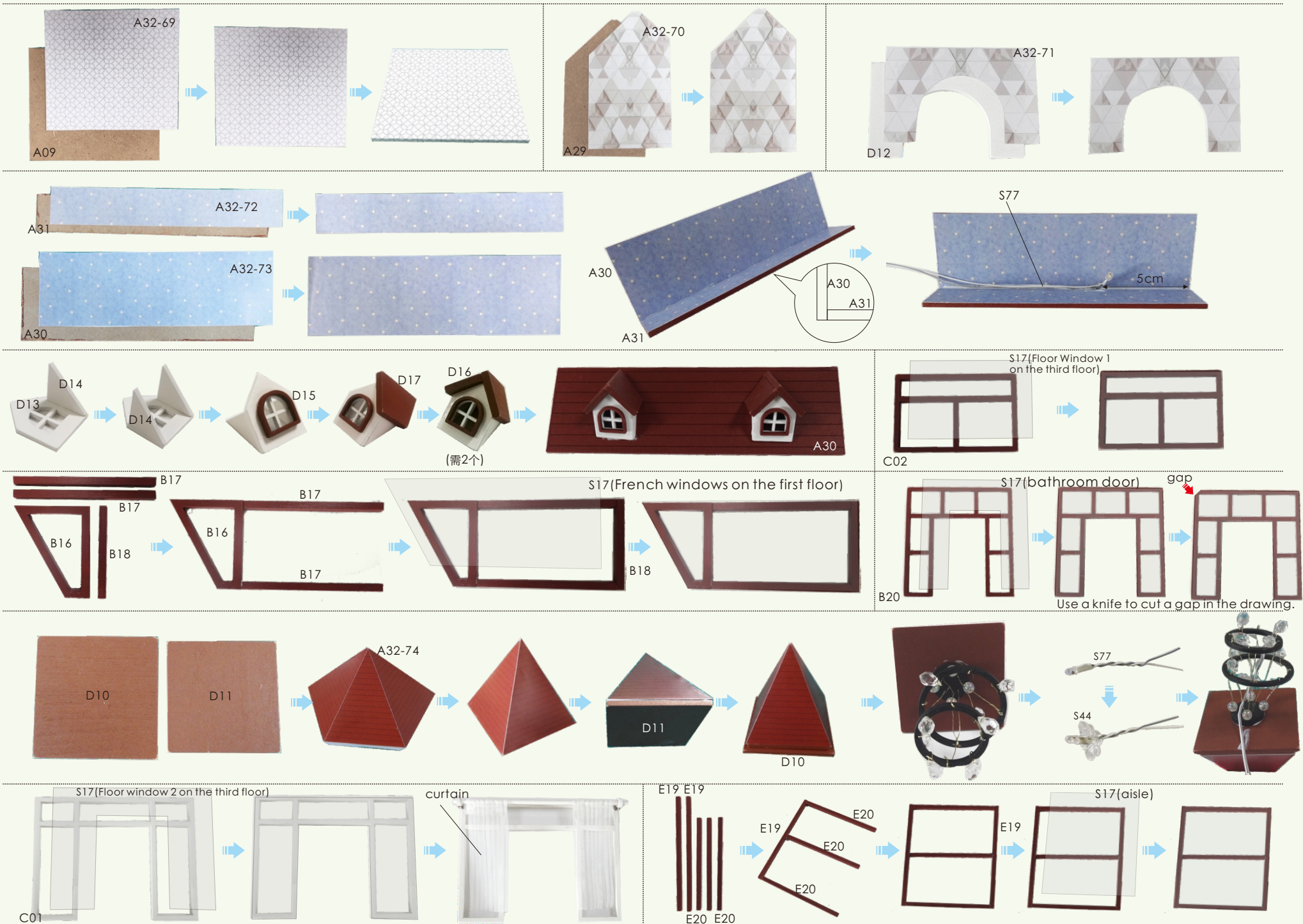




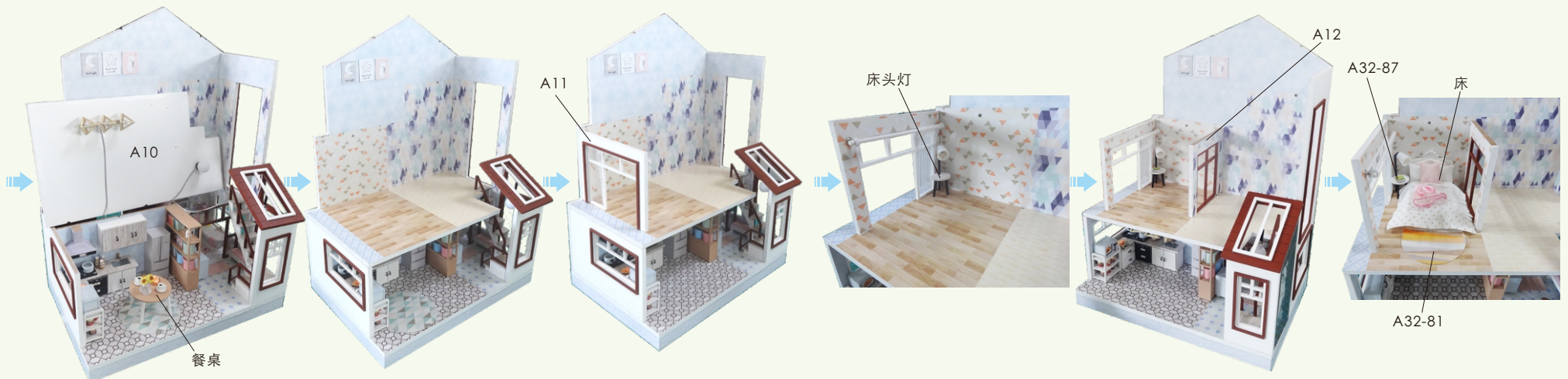
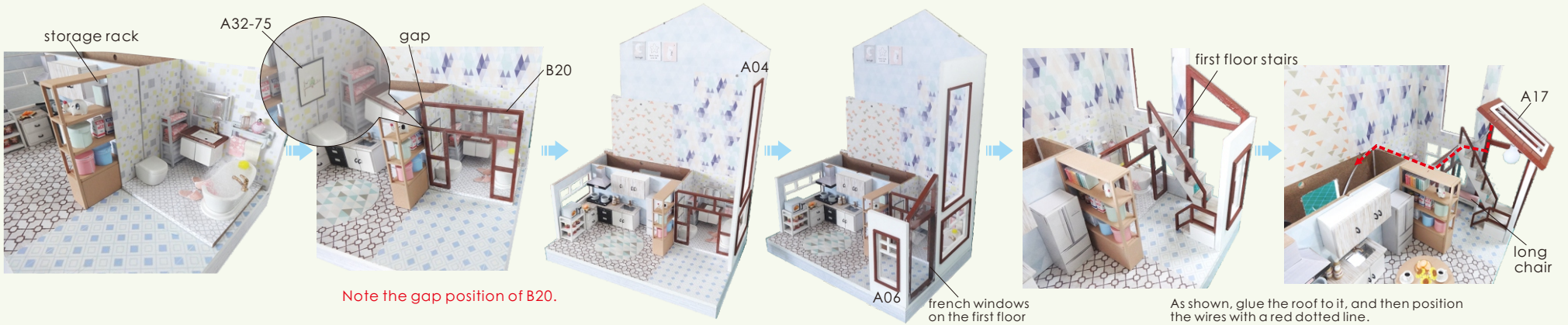
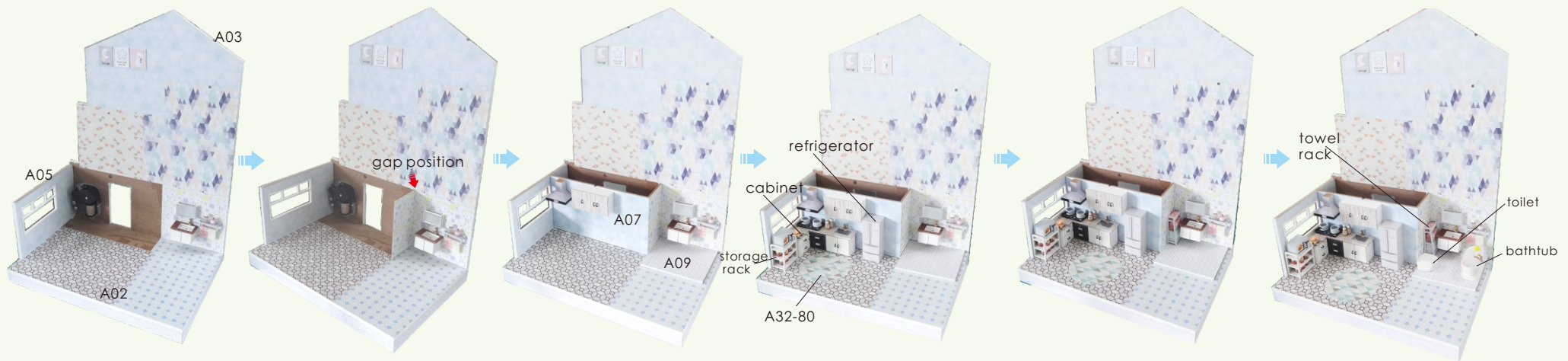




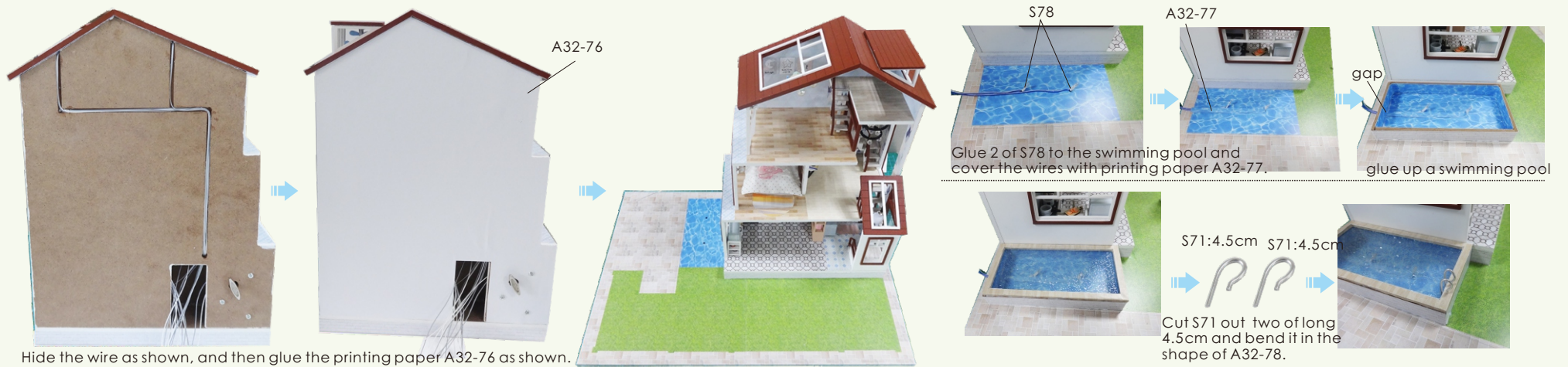
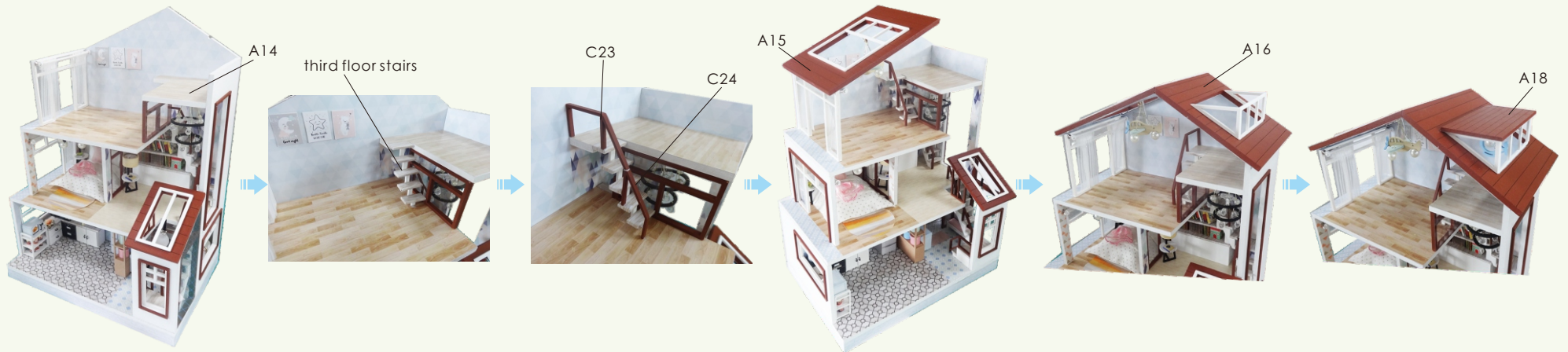




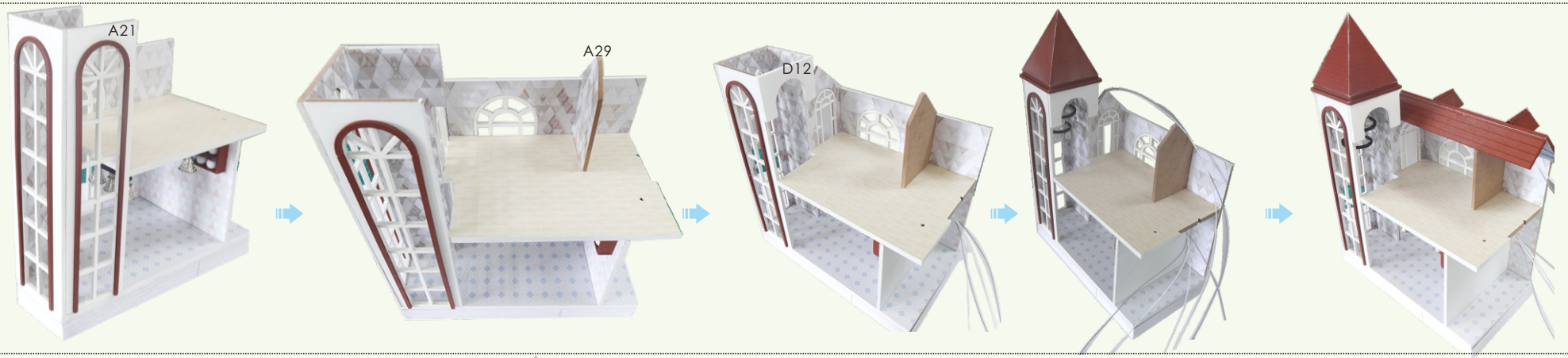
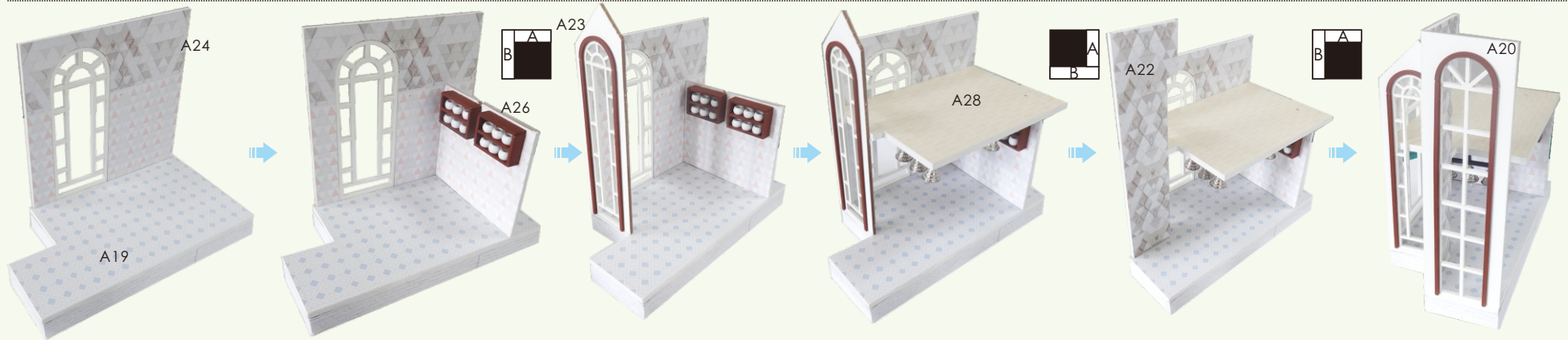




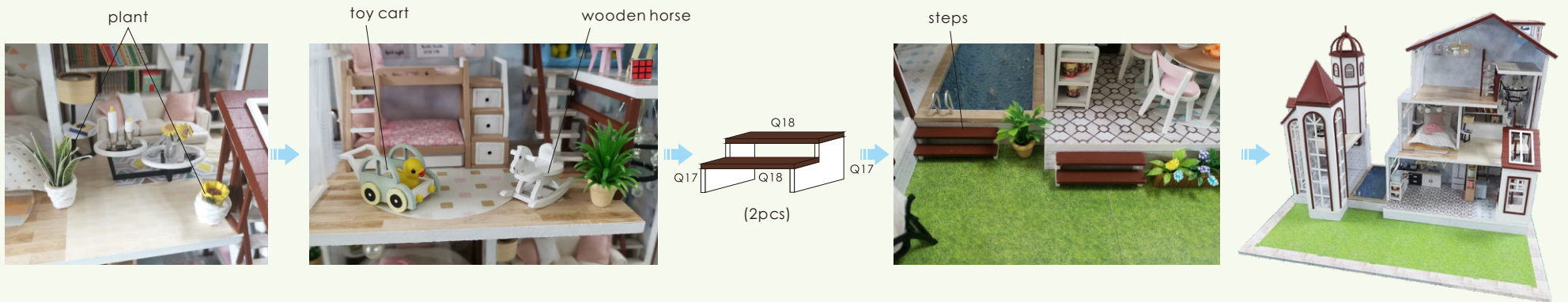
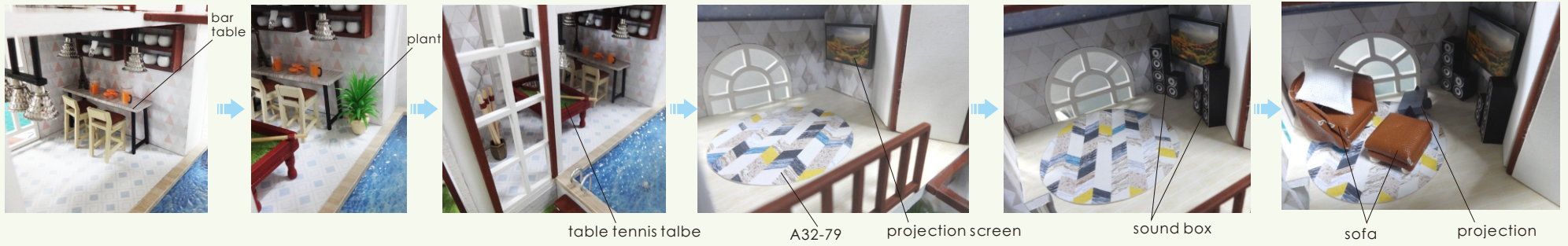




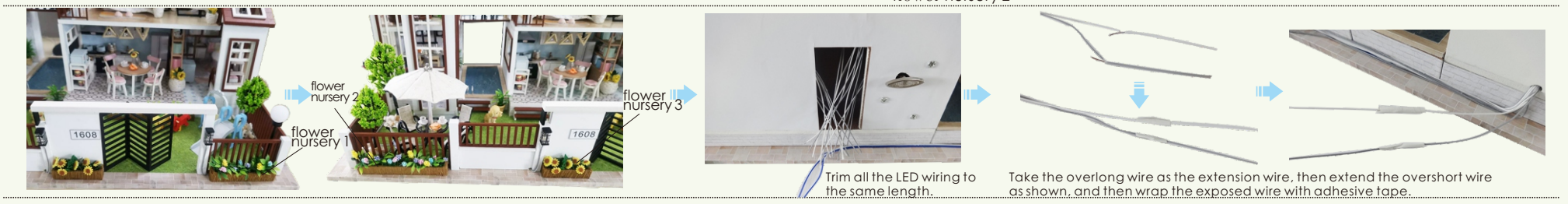
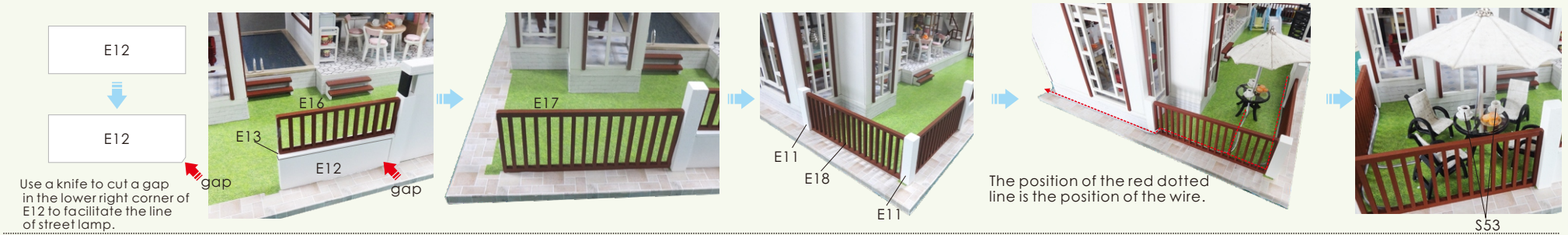










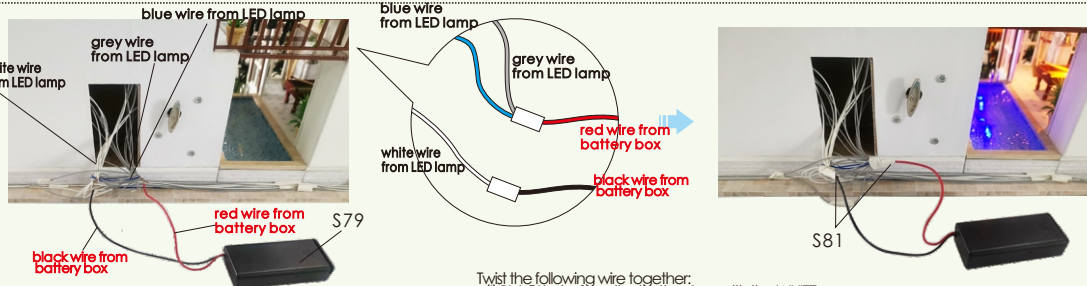




## How to assemble the battery holder

**Statement: the lamp wires cannot be inserted into the output socket.**

- Can use 7 batteries
- Please notice the place of anode and cathode when pit in the batteries
- Rechargeable batteries are not blunt electricity
- Rechargeable batteries can only be charged under adult supervision
- Rechargeable batteries should be removed from the toy before charging
- Different types of batteries cannot mix; Do not mix new batteries in use with semi-used batteries.
- Run out of battery should be removed from the toy
- The power shall not be short circuit



Trim all the LED wiring to the same length.

Use a craft blade to carefully skim over the plastic to bare the copper wire. Twist the same color wire together.

Twist the following wire together:  
 (I) BLACK wire from the Battery box with the WHITE wire from LED bulb.  
 (II) RED wire from the battery box with the GREY wire & BLUE wire from LED bulb.

Roll and seal the duly twist copper with the white tape S81 provided.

## Installation of dust proof cover (For updated version, the parts need to be purchased separately)



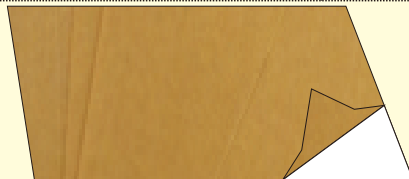
scale 1:10  
 P04 Transparent cover  
 0.15\*30\*44cm  
 1piece



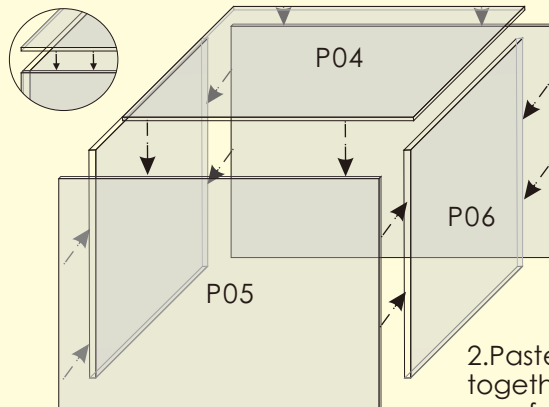
scale 1:10  
 P05 Transparent cover  
 0.3\*34\*44cm  
 2pieces



scale 1:10  
 P06 Transparent cover  
 0.15\*29.4\*34cm  
 2pieces



1. Tear off kraft paper of each piece of transparent cover.



2. Paste P04, P05 and P06 together to complete the dust proof cover as shown.

## Photo of Dust proof cover





**Attention: Please keep the instruction for future enquires after installation.**