

L902

Poems and
Dreams



NOTICE OF ASSEMBLE

Tips for assembling

1. Pictures shown on the package may be slightly different from the actual product.
2. All the materials are taken in the operation step, put the remaining materials back into the original pocket until the installation is completed. (Avoid material loss during installation)
3. The dimensions indicated in the step diagram are "cm".
4. If there have template paper material, please cut the material according to the template to avoid mistakes..
5. According to the part rule example at the bottom of this page, refer to the part on the part number drawing, find the material object and compare with the material list, confirm and install. (Wooden parts only)
6. Glue should not be applied too much, so as not to dry longer, overflow will affect the effect of the finished product.
7. Part shapes may differ from the photographs depending on the production batch

Testing on LED function

Be sure to test the LED lights before making the lighting, note that the LED white wire to the negative, gray wire to the positive reference to the following figure operation test.

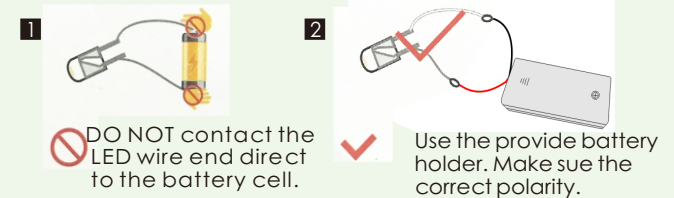

Product comes with tool:

1



White glue:
It dries slowly and can paste materials firmly without trace. Can be used to paste wallpaper and printed paper.

2



Ruler:
For measuring materials to identify the number of materials so as to enhance work efficiency.

3



Scissors:
Can be used to cut printed paper, cloth, etc.

4



Cutter knife:
For peeling off power wire skin and cutting off materials.

5



Alcohol gel:
It dries fast and can paste materials firmly, but may leave some trace. Can be used to paste small metal materials and small components of furniture.

6



Tweezers:
For holding small materials and rolling up iron wire.

7



Screw Driver:
For fixing screws, mostly can be used to install doors and music components.

1



Drill:
Can be used to drill holes in timbers, roll up hard iron wire or fix screws.

2



Needle-nose pliers:
For cutting, bending wire, folding harder material

Bring your own tools:

How to assemble the battery holder



1. Material and tools needed:
- Battery holder, LED bulb, tape, screw driver and 2 piece AA size battery (not provided)



2. Use screw driver and take the lid off from the battery holder.

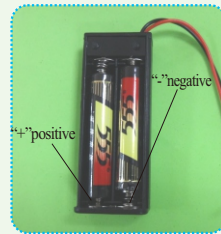

3. Insert the battery take notes on the polarity.

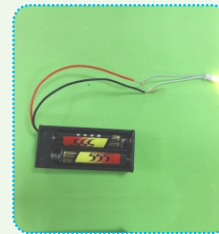

4. Connect the red wire to grey wire. Connect the black wire to white wire.

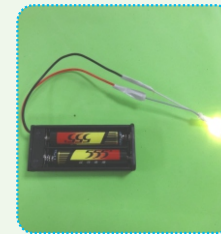

5. Wrap the exposed wire with the tapes.

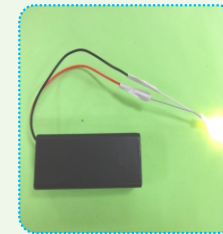

6. Place the box lid and fastness with screw driver.

Example of parts rule:

A01: The parts are directly in the box.; B01: parts in bag B; C01: part in bag C, and so on.

(Note: display the printing paper A16-01 in the step: the printing paper is placed directly in the box, part number is A16-01)

details of miniature kit

Name	Material package
Printing paper	Bag A-A16 (All printing and template papers are shown on A16 paper, total 3 pieces of A3 and 1 piece A4)
Toilet	bag A + bag D+printing paper
Hot sprint pool	bag A + bag D+printing paper
Water basin	bag D+ printing paper
Hanger	bag D+bag G
Boat	bag A +bag E+printing paper
Chessboard	bag E+bag J+printing paper
Tea table	bag E+bag J+bag G+bag L
Mahjong table	bag E+printing paper
Mahjong chair	bag E
Bed	bag E+bag G+printing paper
Landing hanger	bag E+bag G+printing paper
Chinese zither	bag F+bag G+bag K
Chinese zither stool	bag F
Virtus shelf	bag F+bag G+bag J+bag L
Hot pot table	bag F+bag G+bag J +bag K+ printing paper
Single chair	bag F
Double bench	bag F
Storage rack	bag F+bag K+bag L+printing paper
Pines potted	bag G+bag K+bag L
Orange potted plant	bag J+bag K+bag L
Lantern	bag G+bag J+bag K
Round stool	bag J+printing paper
Wall lamp	bag K+L bag
Left house	bag A +B bag+C bag+printing paper
Right house	bag A+bag B+bag C+printing paper

Welcome to the little DIY world, now come with me!



Thumbnail of material list (reference only)



Thumbnail of printing paper & template paper (reference only)

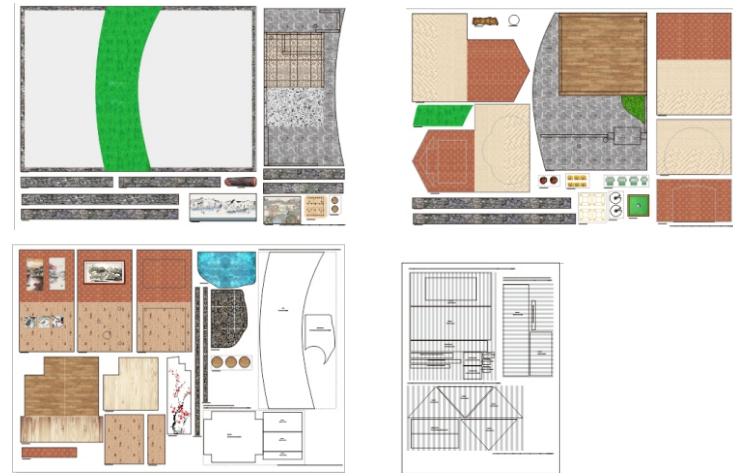

Symbol description used

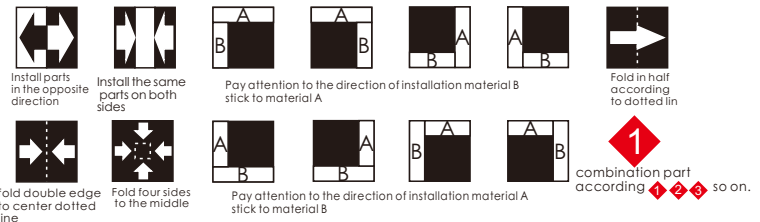



please follow me slowly!

Toilet

cut out the material A20 according to the template paper before making.

Paste by reference line.

Paste by reference line.

Hot spring pool

cut out the material A22 according to the template paper before making.

Paste it from here.

Water Basin

Hanger

As shown, the G03 can be folded at will.

Boat

Chessboard

(2pieces)

Tea table

E06, E07, G06, J13, J12, J06, L02(branch), J09, J06, G06:0.6cm, G06:0.8cm, bend it as shown., J06, J13, L02(branch), J09 (2pieces)

Mahjong Table

E08, E09, E10, A16-28, A16-27, A16-27, As shown in the picture, fold the Mahjong.

Mahjong Chair

E11, E12, E13, E14, Other mahjong folding method is the same.

Bed

E14, E15, E16, E17, G01:5.5*4.4cm, G04:2.5*15cm, G04:2.5*15cm, G02 (bed), G05, G02 (pillow), E14, E17, Cut out the material G02 according to the template paper before making.

Landing Hanger

E18, G02 (towel), E19, G04:2.5*15cm, Apply the glue on the red dotted line and fold in half., (2pieces)

Chinese zither

F01, F03, F02, G06, A16-9, G10, K04, F01, G06, K04, G06, F02, F03, F02, 3.4cm, 3.2cm, 2.9cm, 2.9cm, G10 2.8cm, After the G06 reference figure is bent, cut off the rest, as shown in the figure.

Chinese zither stool

F04, F05, F05, F05, F05, F04, F05

Virtus shelf

F06, F07, F09, F08, F08, F10, G09, L07, J11, J08, J02, G06:2.8cm, G06:2.5cm, G06:2cm, G06:1.8cm

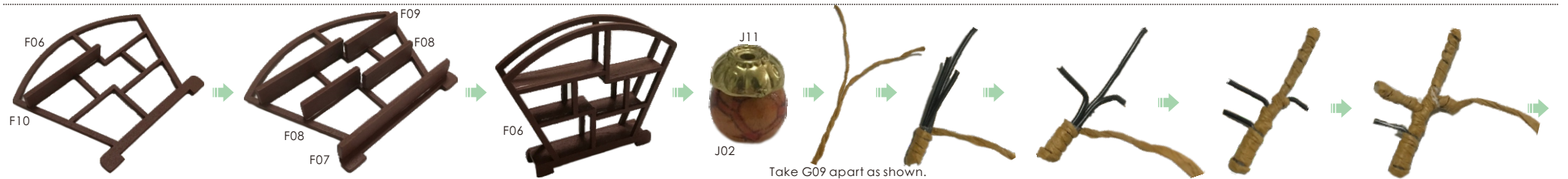

Take G09 apart as shown.

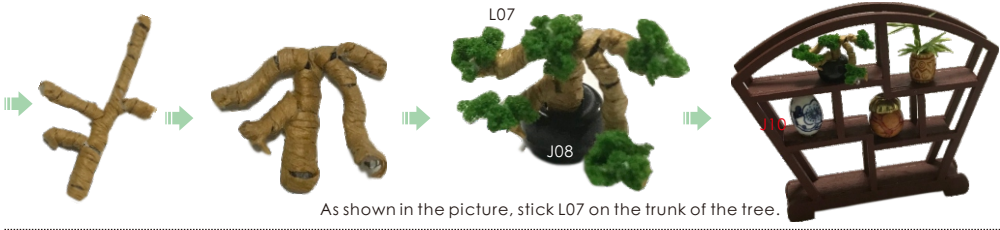

As shown in the picture, stick L07 on the trunk of the tree.

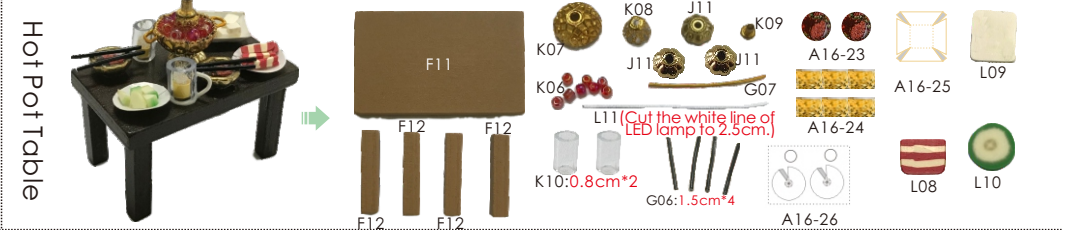

Hot Pot Table

L11 (Cut the white line of LED lamp to 2.5cm.)

G06: 1.5cm*4

K10: 0.8cm*2

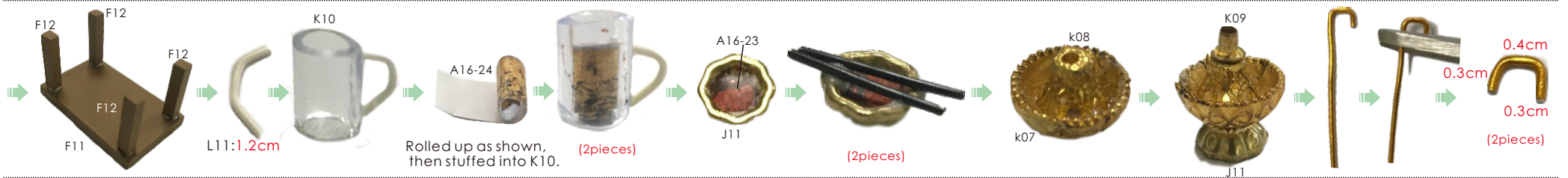

Rolled up as shown, then stuffed into K10. (2pieces)

(2pieces)

0.4cm
0.3cm
0.3cm
(2pieces)

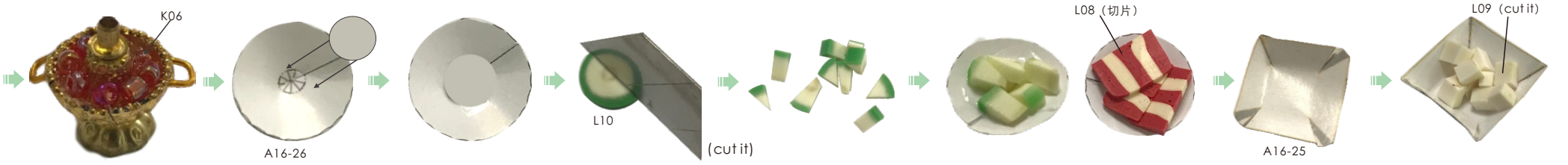

(cut it)

A16-25

L09 (cut it)

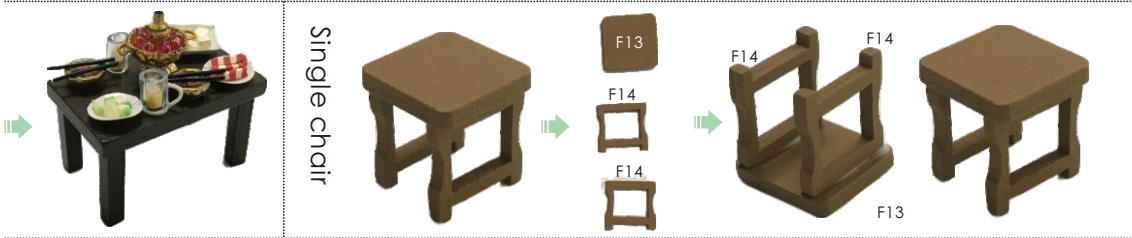

Single chair

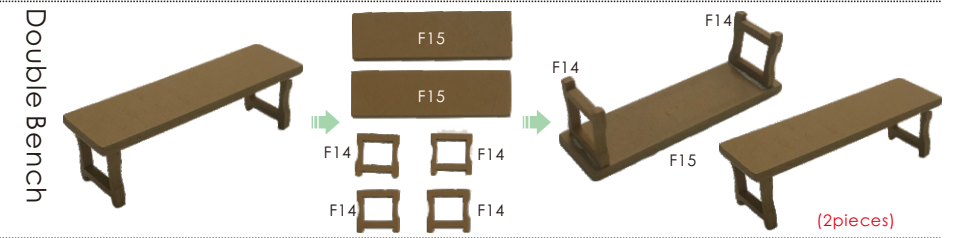

Double Bench

(2pieces)

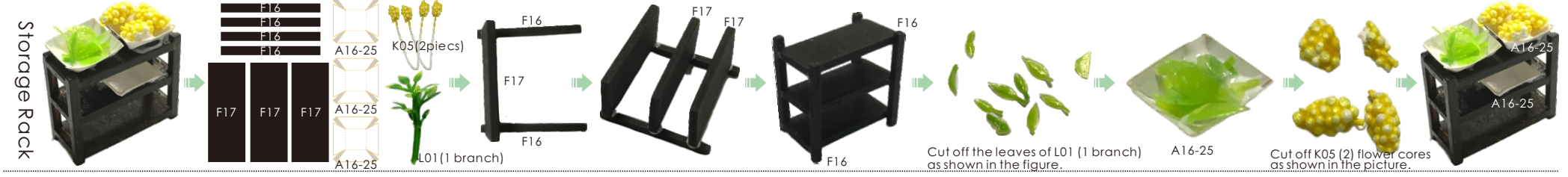

Storage Rack

K05 (2pieces)

L01 (1 branch)

Cut off the leaves of L01 (1 branch) as shown in the figure.

A16-25

Cut off K05 (2) flower cores as shown in the picture.

A16-25

A16-25

Pines potted

Take G09 apart as shown.

As shown in the picture, stick L07 on the trunk of the tree.

Orange potted plant

Lantern

(8pieces)

(16pieces)

(12pieces)

(8pieces)

(6pieces)

Round stool

Wall lamp

(fold it)

G08:2cm (6pieces)

(3pieces)

K10:1.2cm

Left house

Music machine core manual guide (If you have purchased the music machine core, please fix it firstly)

M01 Music machine core 1piece

M02 Music machine core handle 1piece

M03 Screw 3pieces

(front view)

(back view)

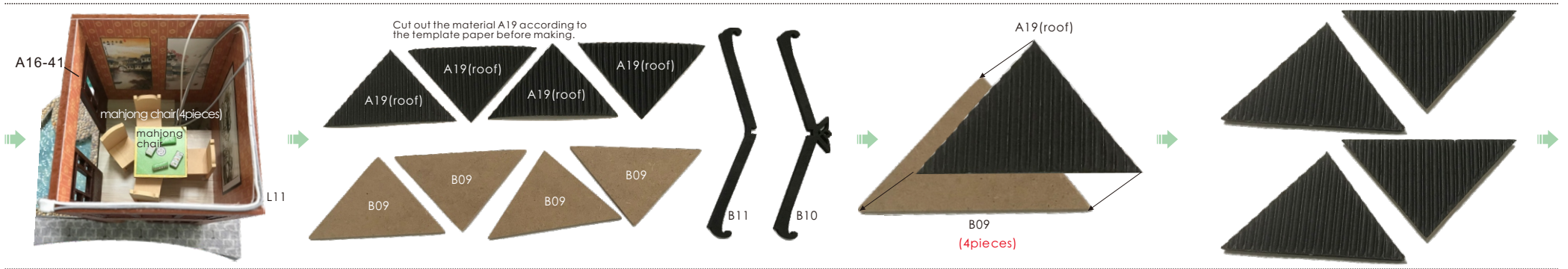
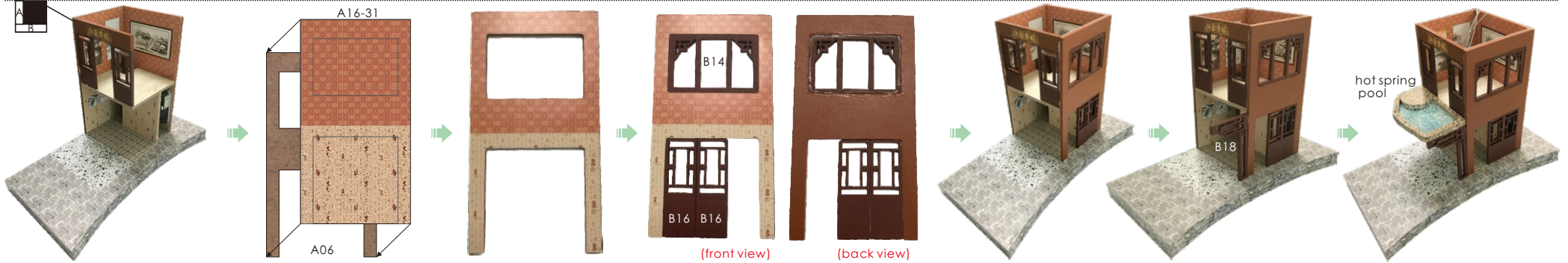
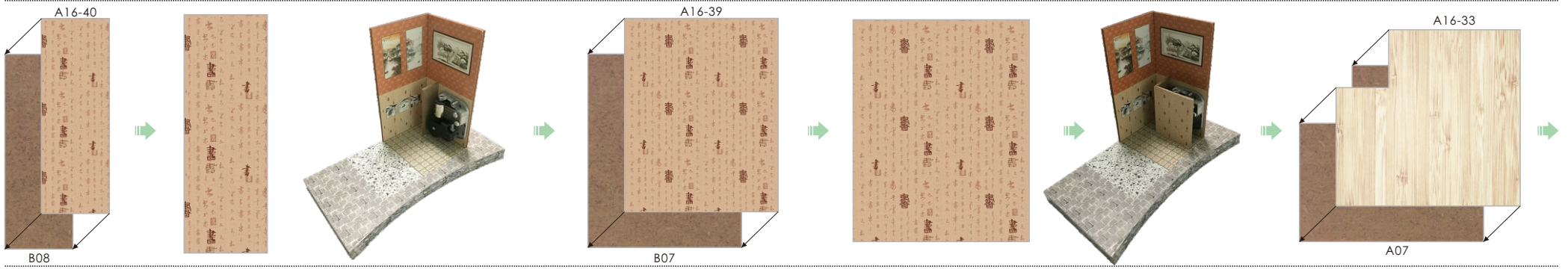

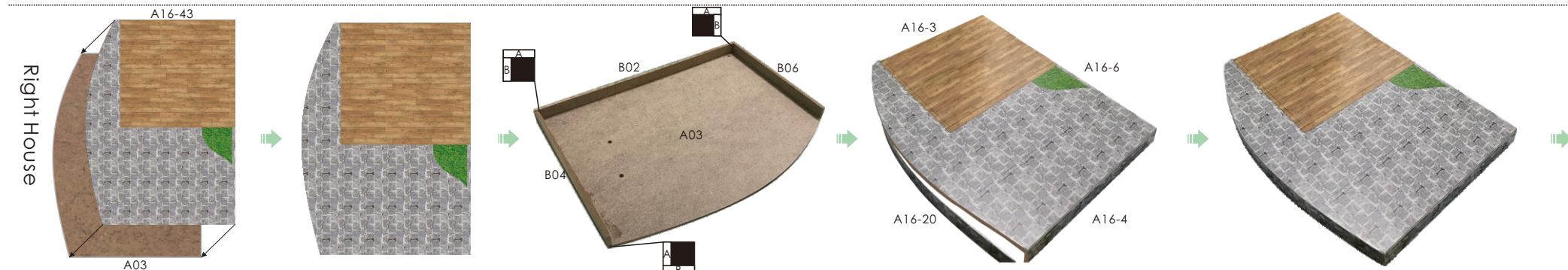
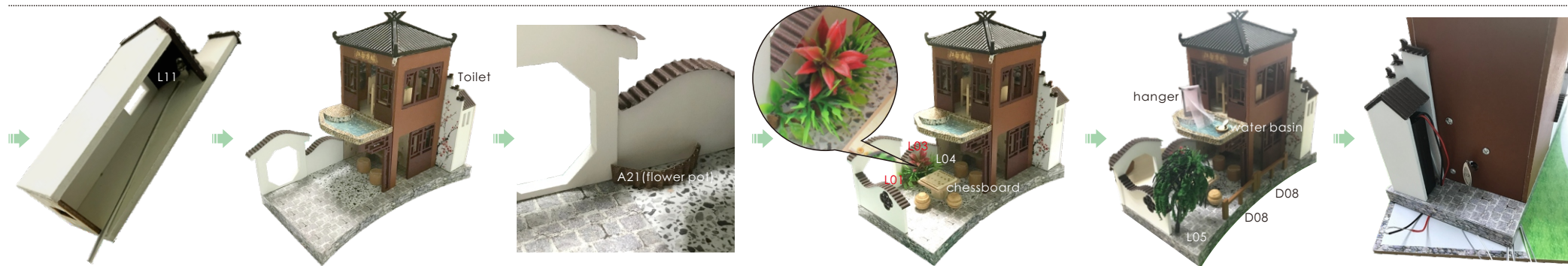
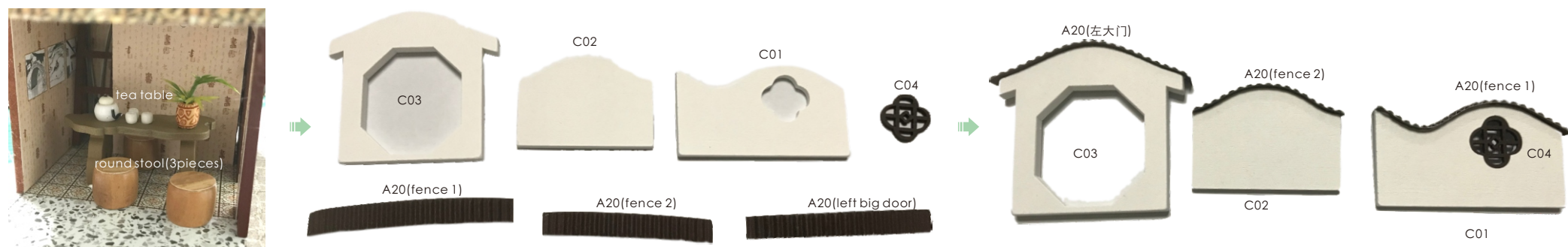

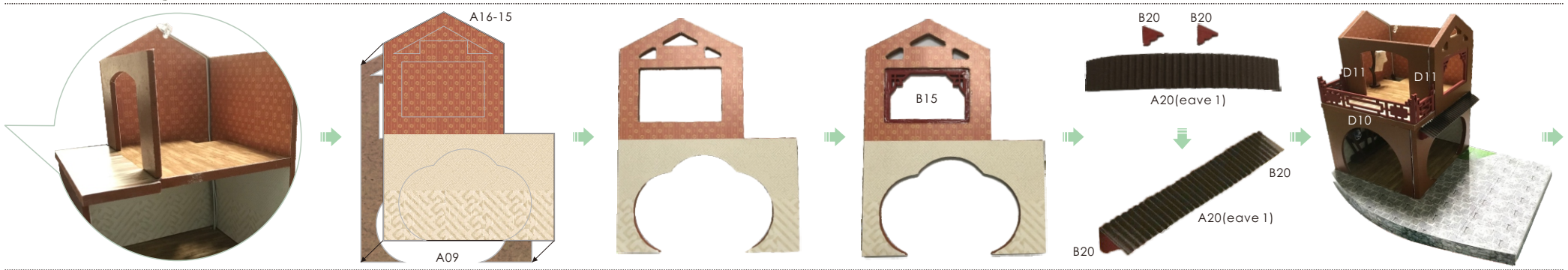
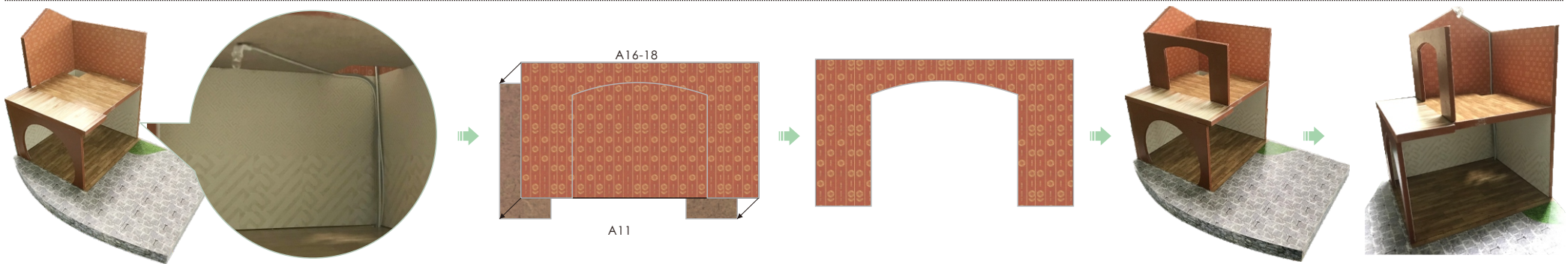
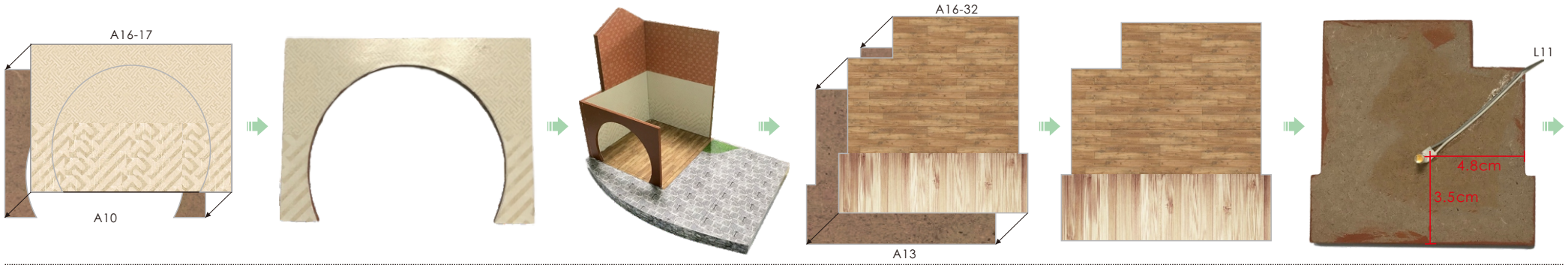
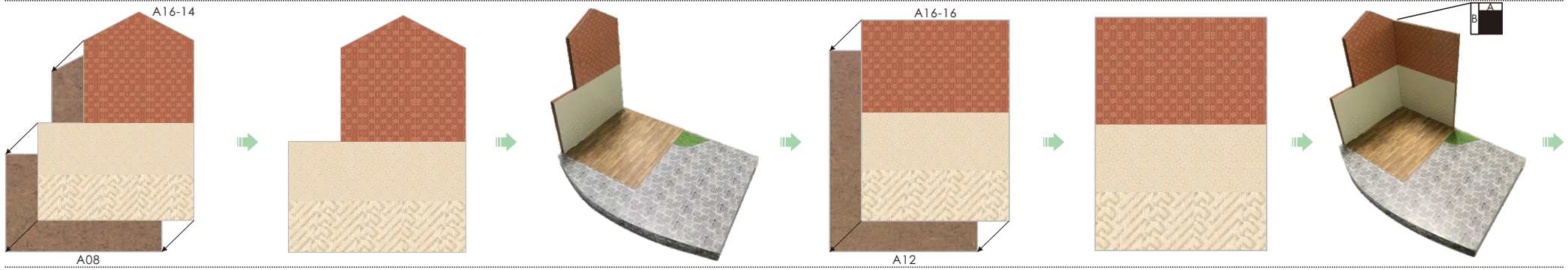

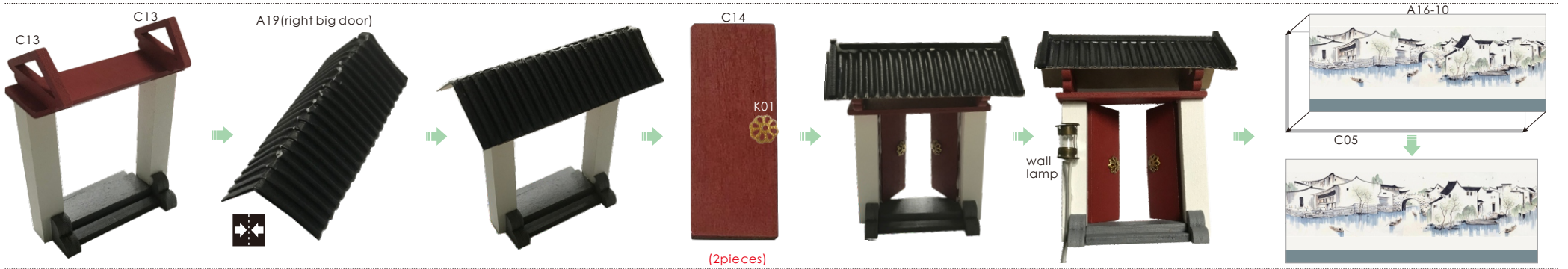
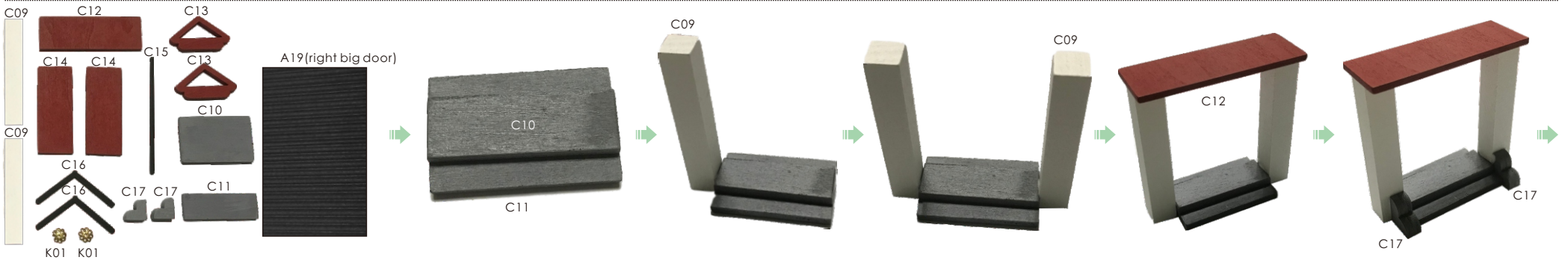
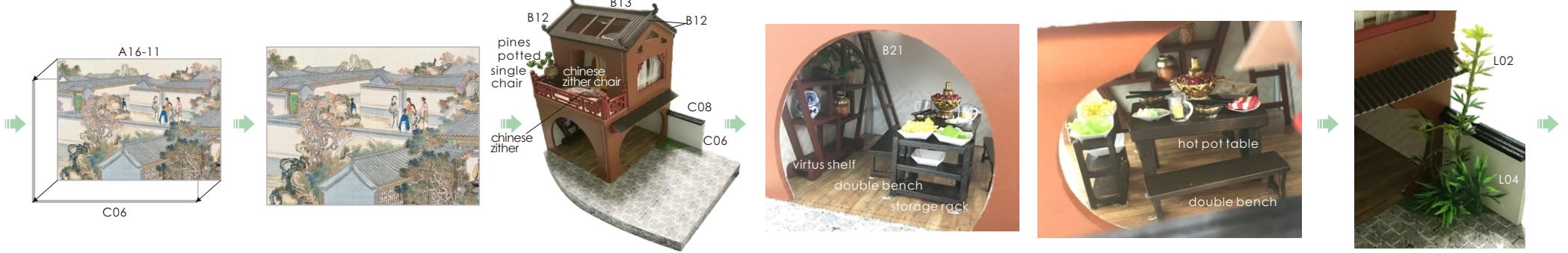



How to assemble the battery holder

Statement: the lamp wires cannot be inserted into the output socket.

- - Can use 7 batteries
- - Please notice the place of anode and cathode when put in the batteries
- - Rechargeable batteries are not blunt electricity
- - Rechargeable batteries can only be charged under adult supervision
- - Rechargeable batteries should be removed from the toy before charging
- - Different types of batteries cannot mix; Do not mix new batteries in use with semi-used batteries.
- - Run out of battery should be removed from the toy
- - The power shall not be short circuit

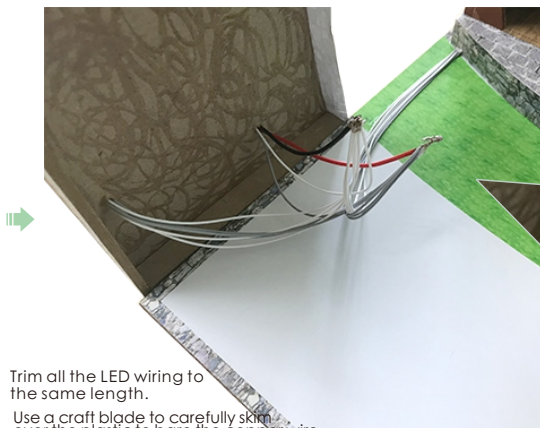
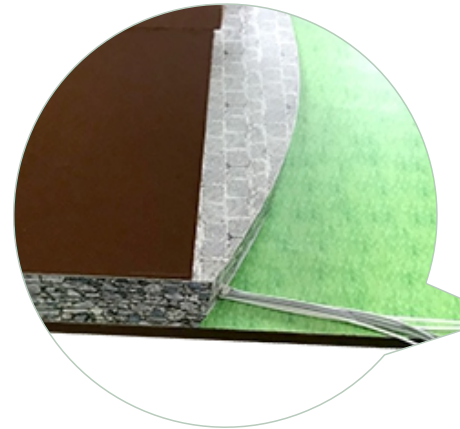
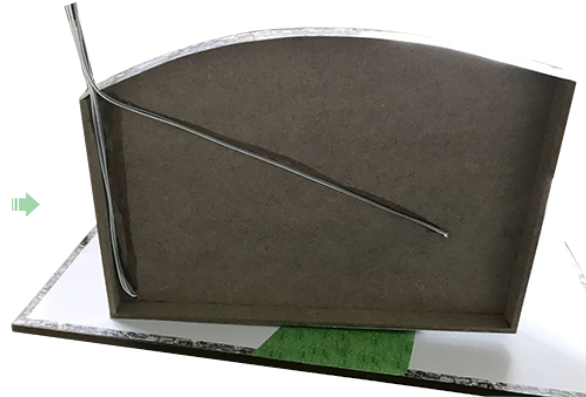
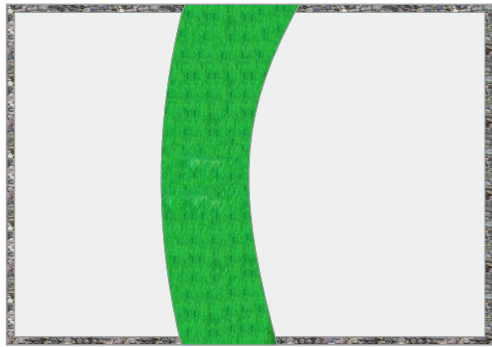
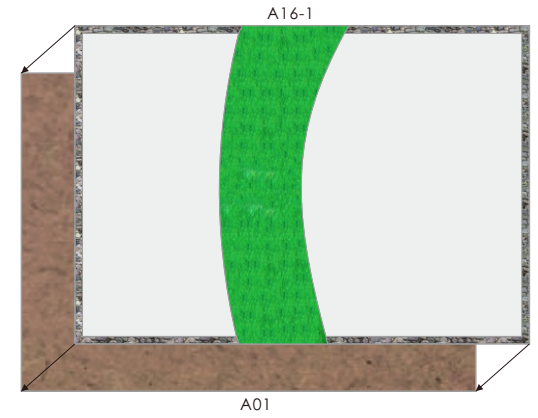

Trim all the LED wiring to the same length.
Use a craft blade to carefully skin over the plastic to bare the copper wire. Twist the same color wire together.

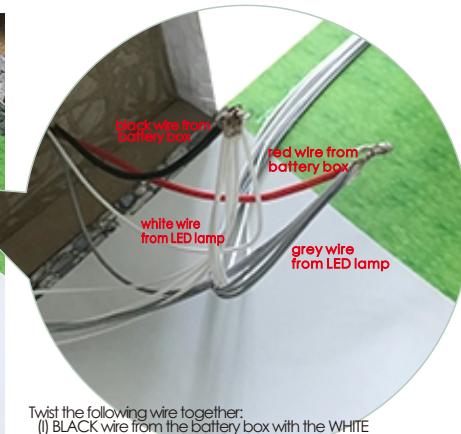

Twist the following wire together:
(I) BLACK wire from the battery box with the WHITE wire from LED bulb.
(II) RED wire from the battery box with the GREY wire from LED bulb.

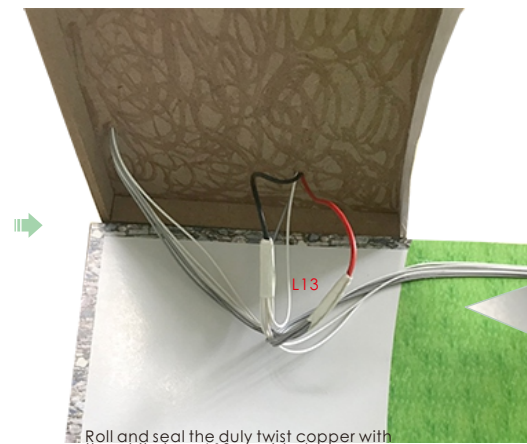

Roll and seal the duly twist copper with the white tape L13 provided.



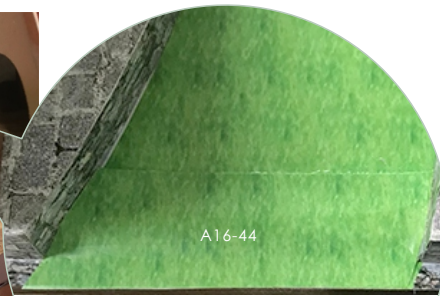

A16-44

As shown, cover the wire with A16-44 at the end.

Good for you!
We finished it !



orange potted plant

orange potted plant

lantern



lantern

chinese zither

lantern



L06 (It is inserted from the hole in the floor and is easy to fix.)



lantern

lantern



boat



bridge

L05 (It is inserted from the hole in the floor and is easy to fix.)

Installation of dust proof cover
(For updated version, the parts need to be purchased separately)



scale 1:6
M04 Transparent cover
30*21*0.15cm
1 piece



scale 1:6
M05 Transparent cover
29.7*18.5*0.15cm
2 pieces



scale 1:4
M06 Transparent cover
21*18.5*0.15cm
2 pieces

1. Tear off kraft paper of each piece of transparent cover.

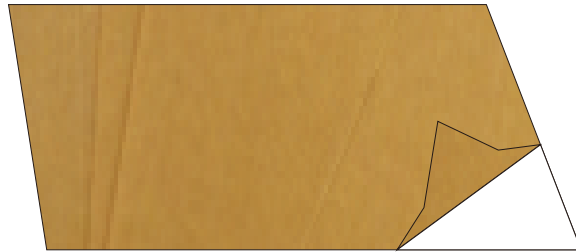

2. Paste M04, M05 and M06 together to complete the dust proof cover as shown.

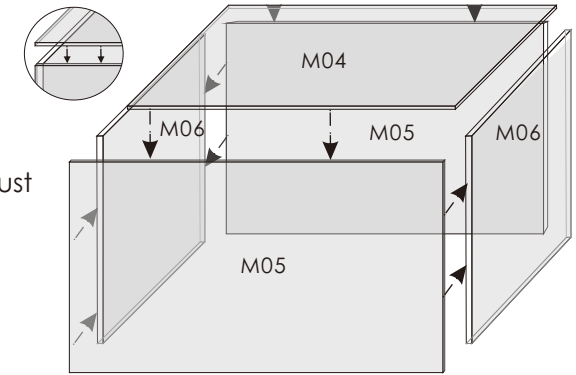

Photo of Dust proof cover



Photo gallery





Attention: Please keep the instruction for future enquires after installation.