

S903

# DIY mini house kits Ding Dong nest



S903 Instruction manual

# NOTICE OF ASSEMBLE

## Tips for assembling

1. Pictures shown on the package may be slightly different from the actual product.
2. All the materials are taken in the operation step, put the remaining materials back into the original pocket until the installation is completed. (Avoid material loss during installation)
3. The dimensions indicated in the step diagram are "cm".
4. If there have template paper material, please cut the material according to the template to avoid mistakes..
5. According to the part rule example at the bottom of this page, refer to the part on the part number drawing, find the material object and compare with the material list, confirm and install. (Wooden parts only)
6. Glue should not be applied too much, so as not to dry longer, overflow will affect the effect of the finished product.
7. Part shapes may differ from the photographs depending on the production batch

## Testing on LED function

Be sure to test the LED lights before making the lighting, note that the LED white wire to the negative, gray wire to the positive reference to the following figure operation test.

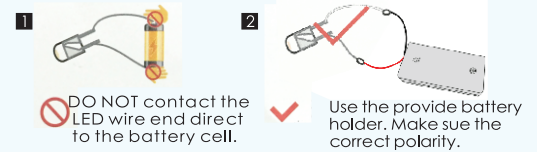

## Product comes with tool:

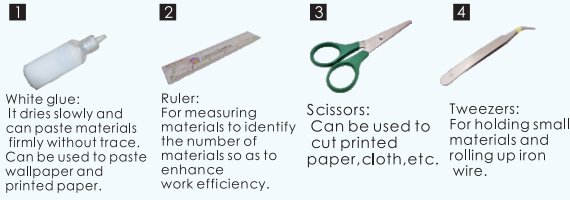

**1**  
White glue:  
It dries slowly and can paste materials firmly without trace. Can be used to paste wallpaper and printed paper.

**2**  
Ruler:  
For measuring materials to identify the number of materials so as to enhance work efficiency.

**3**  
Scissors:  
Can be used to cut printed paper, cloth, etc.

**4**  
Tweezers:  
For holding small materials and rolling up iron wire.

## Bring your own tools:

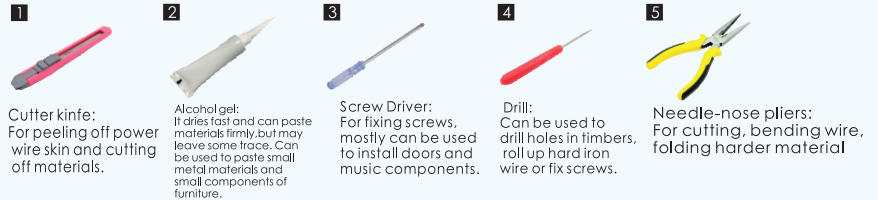

**1**  
Cutter knife:  
For peeling off power wire skin and cutting off materials.

**2**  
Alcohol gel:  
It dries fast and can paste materials firmly, but may leave some trace. Can be used to paste small metal materials and small components of furniture.

**3**  
Screw Driver:  
For fixing screws, mostly can be used to install doors and music components.

**4**  
Drill:  
Can be used to drill holes in timbers, roll up hard iron wire or fix screws.

**5**  
Needle-nose pliers:  
For cutting, bending wire, folding harder material

## How to assemble the battery holder

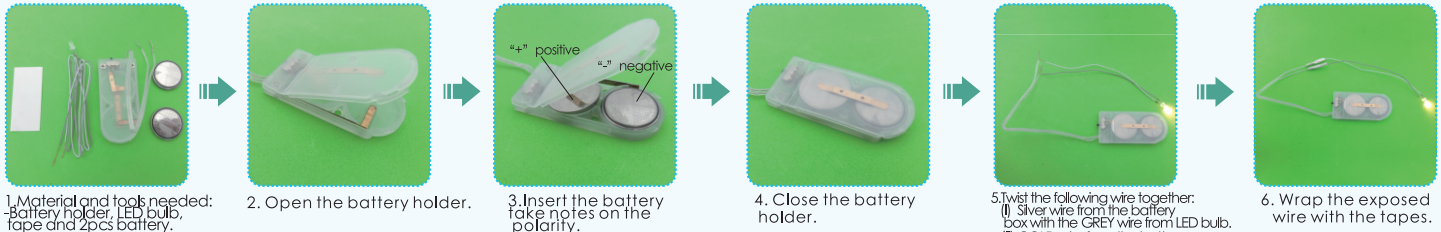

1. Material and tools needed:  
Battery holder, LED bulb, tape and 2pcs battery.

2. Open the battery holder.

3. Insert the battery take notes on the polarity.

4. Close the battery holder.

5. Twist the following wire together:  
I) Silver wire from the battery box with the GREY wire from LED bulb.  
II) GOLD wire from the battery box with the WHITE wire from LED bulb.

6. Wrap the exposed wire with the tapes.

## Example of parts rule:

A01: The parts are directly in the box.; B01: parts in bag B; C01: part in bag C, and so on. (Note: display the printing paper A05-01 in the step: the printing paper is placed directly in the box, part number is A05-01)

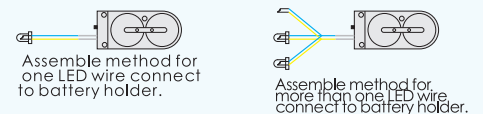

Assemble method for one LED wire connect to battery holder.

Assemble method for more than one LED wire connect to battery holder.

## details of miniature kit

Name	Material package
Printing paper	Bag A-A05(All printing and template papers are shown on A05 paper)
Table	B bag + D bag + printing paper
Plant	D bag + printing paper
Chair	B bag +D bag
Cabinet	B bag + D bag + printing paper
Decoration	C bag
Sofa	C bag+ D bag
Round table	C bag+D bag +printing paer
Round chair	C bag+ D bag+printing paper
Long cabinet	C bag+ D bag+ printing paer
Curtain	C bag+ D bag
battery holder	E bag



Welcome to the little DIY world, now come with me!

## Thumbnail of material list( reference only)



## Thumbnail of printing paper & template paper( reference only)

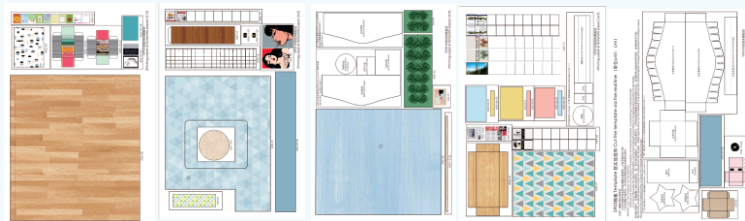

## Symbol description used



Install parts in the opposite direction



Install the same parts on both sides



Pay attention to the direction of installation material B stick to material A



Pay attention to the direction of installation material A stick to material B



Pay attention to the direction of installation material A stick to material B



Pay attention to the direction of installation material A stick to material B



Fold in half according to dotted line



fold double edge to center dotted line



Fold four sides to the middle



Pay attention to the direction of installation material A stick to material B



Pay attention to the direction of installation material A stick to material B



Pay attention to the direction of installation material A stick to material B



Pay attention to the direction of installation material A stick to material B



combination part according to so on.

# Table



please follow me slowly!

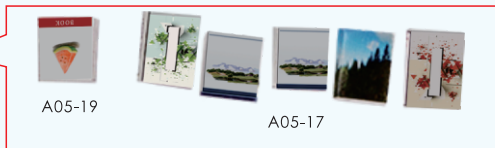
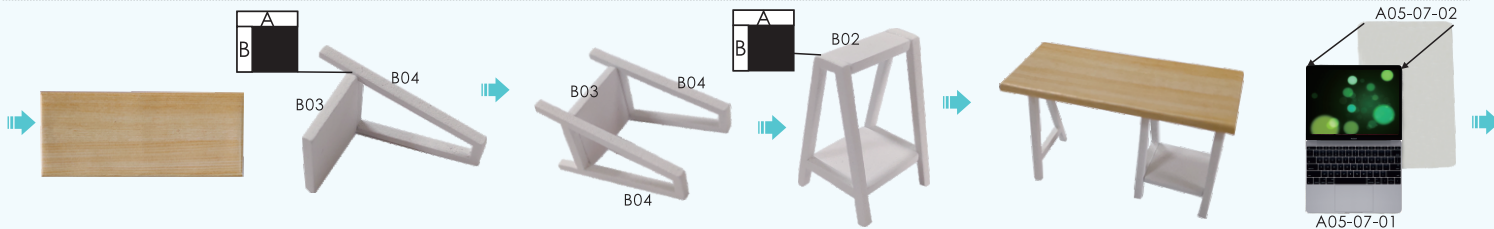
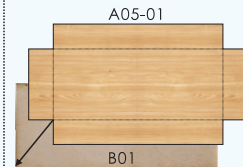
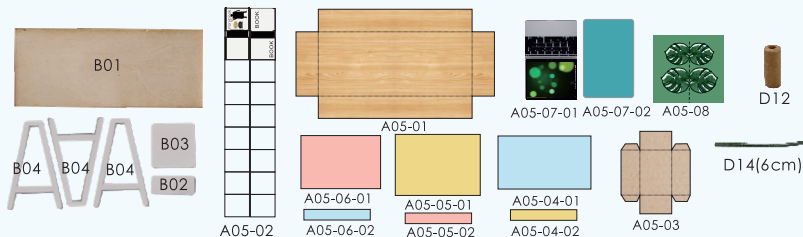

Complete the book above by referring to the previous book.

A05-08



fold it



Cut a notch after fold in half



glue it

D14:6cm

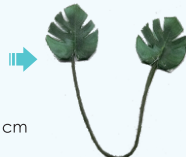

D12

A05-03



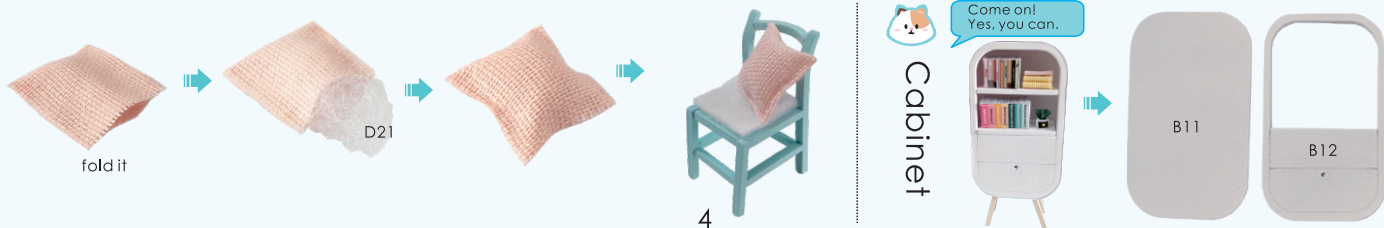
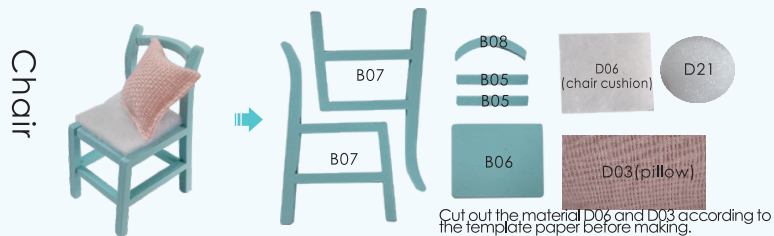
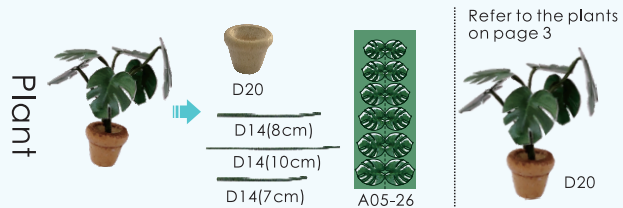
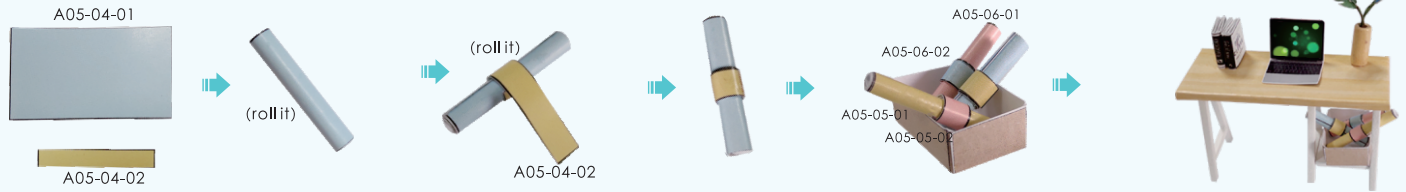

Cut out the material D02 and D03 according to the template paper before making.

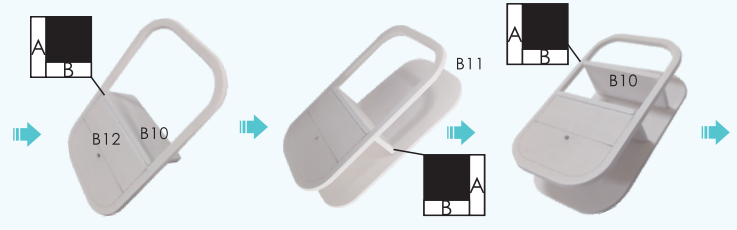
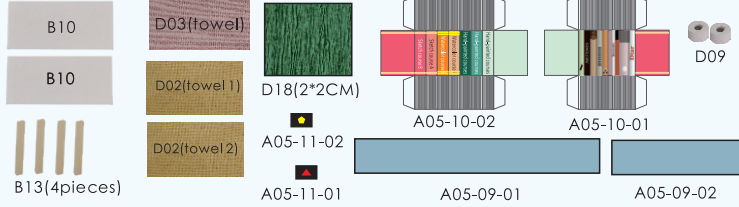

Attach A05-09-02 to the combination as shown.

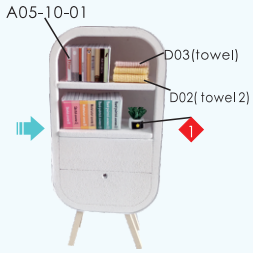
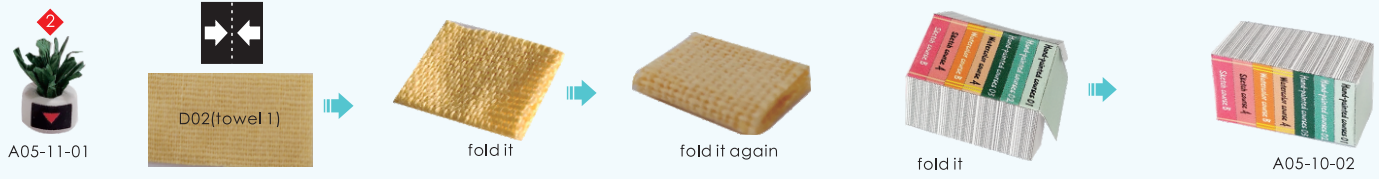

Decoration

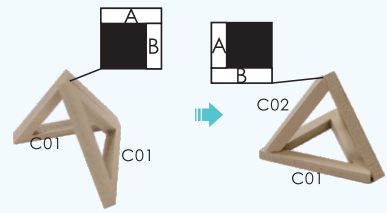
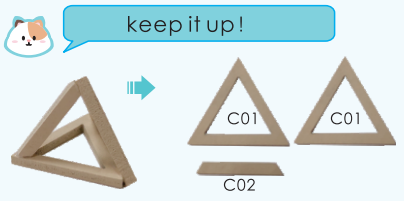

Sofa







A05-12-01

Round table

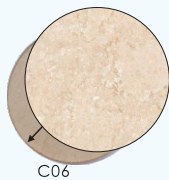
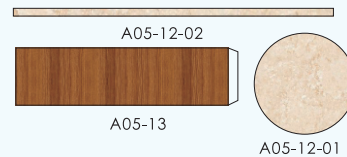

A05-12-02



A05-13

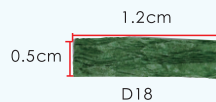

1.2cm

0.5cm

D18



twist as shown

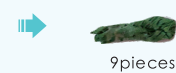

9pieces







# Round chair

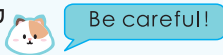

Cut out the material D02 and D06 according to the template paper before making.



D02(round chair covered edge)



Stick both sides inward along the dotted lines of the template as shown.



# Long cabinet

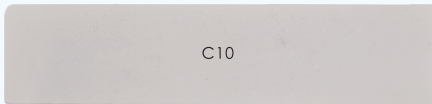
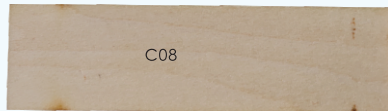
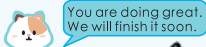

A05-16-02

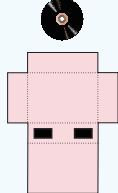

A05-16-01

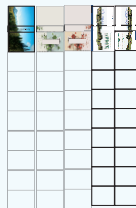

A05-17

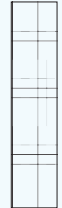

A05-18



D17



D16

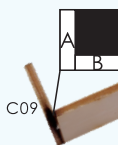

C09

C08

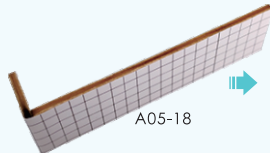

A05-18

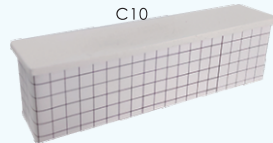

C10

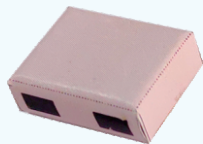
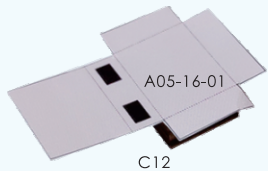

If the wire does not fit into the D17 bead, glue it together as shown.

Please refer to page 3 for the folding of A05-17 books.



Curtain



cut out D04 as shown.



Lamp

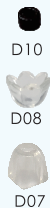

If the E01 cannot pass through the bead, use a tool to make the hole larger as shown.





The frame is strong,  
the home is stronger too!

Outer frame

A05-20

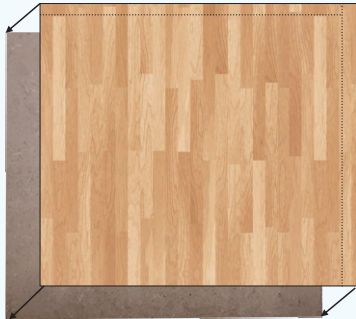

A01



8

A05-21

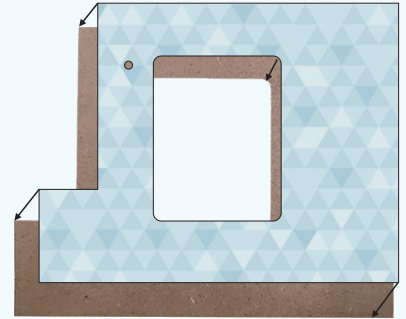

A02

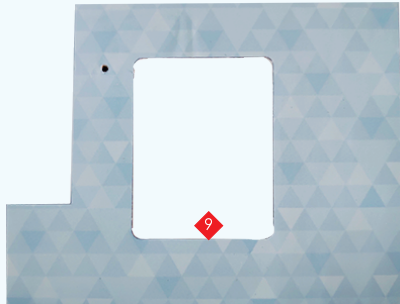

9

A05-22

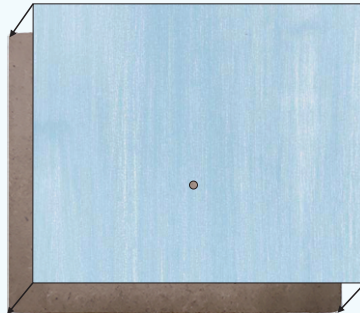

A03

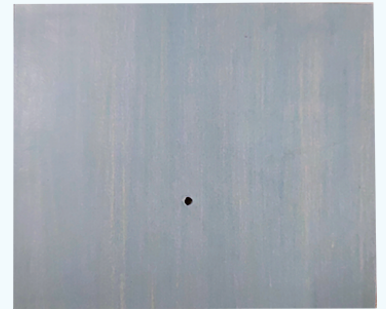

10

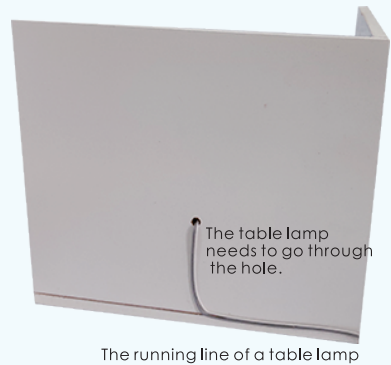
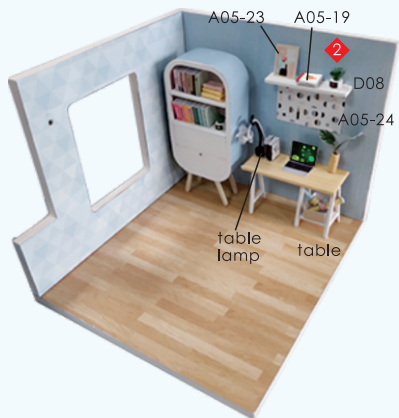
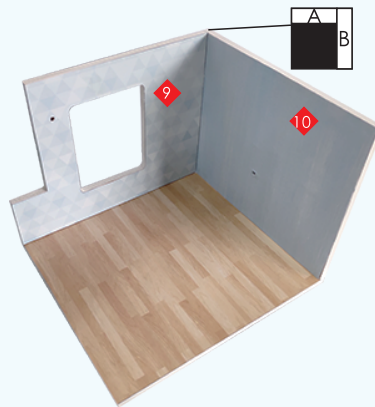
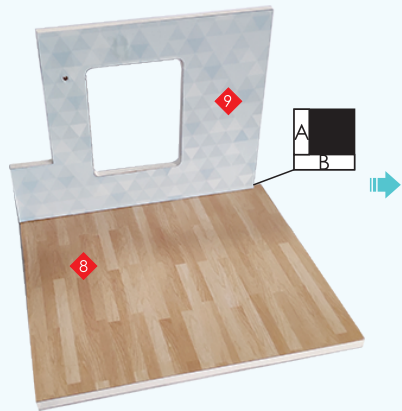

The running line of a table lamp

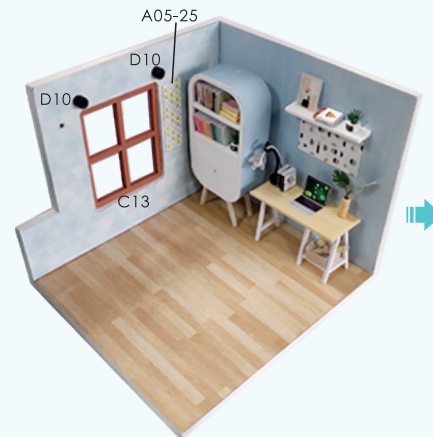

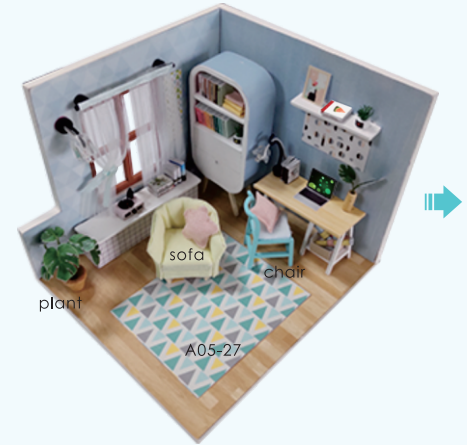
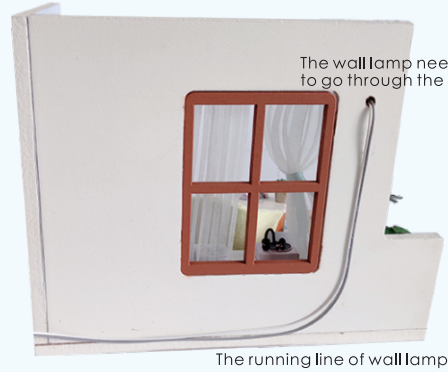

## How to assemble the battery holder

Statement: the lamp wires cannot be inserted into the output socket.

- - Can use 3V button batteries
- - Please notice the place of anode and cathode when put in the batteries
- - Rechargeable batteries are not blunt electricity
- - Rechargeable batteries can only be charged under adult supervision
- - Rechargeable batteries should be removed from the toy before charging
- - Different types of batteries cannot mix
- - Do not mix new batteries in use with semi-used batteries.
- - Run out of battery should be removed from the toy
- - The power shall not be short circuit

1. Trim all the LED wiring to the same length.
2. Use a craft blade to carefully skim over the plastic to bare the copper wire. Twist the same color wire together.

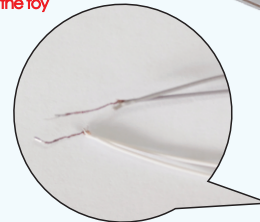



3. Twist the following wire together:  
 (i) Silver wire from the battery box with the GREY wire from LED bulb.  
 (ii) GOLD wire from the battery box with the WHITE wire from LED bulb.

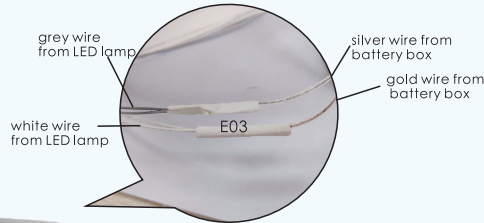

Roll and seal the duly twist copper with the white tape E03 provided.

## Installation of dust proof cover



scale 1:3  
 F01 Transparent cover  
 14\*12.5\*0.15cm  
 1 piece



scale 1:4  
 F02 Transparent cover  
 13.5\*10.5\*0.15cm  
 1 piece



scale 1:4  
 F03 Transparent cover  
 11.8\*10.5\*0.15cm  
 1 piece



scale 1:2  
 F04 Transparent cover  
 7\*2.2\*0.15cm  
 1 piece



1. Tear off kraft paper of each piece of transparent cover.

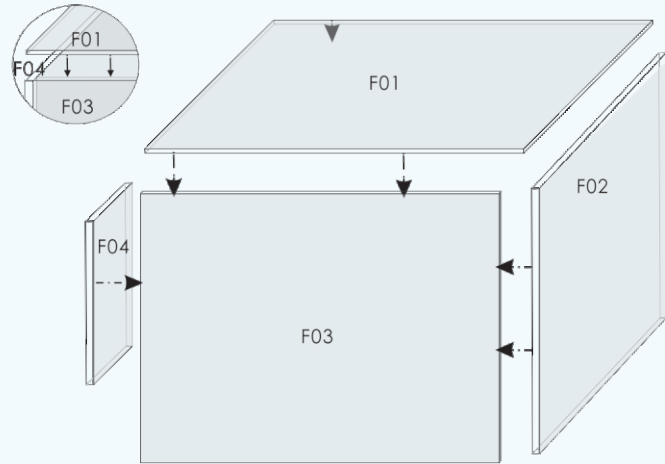
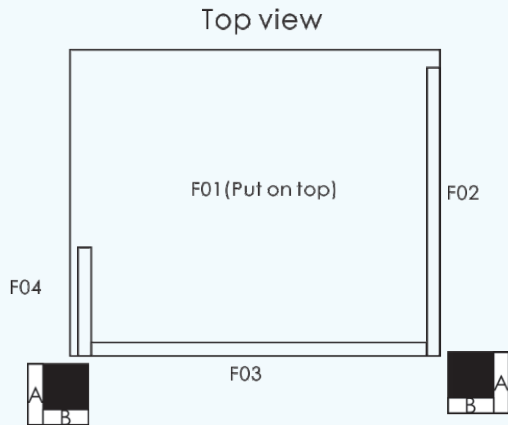

2. Paste F01, F02, F03 and F04 together to complete the dust proof cover as shown.

## Photo Gallery



Photo of Dust proof cover



**Attention: Please keep the instruction for future enquires after installation.**